



MBU-A SERIES

Undercounter/Worktable Refrigerators & Freezers

MBUF/MBUR60A



REFRIGERATORS

- MBUR27A
- MBUR36A
- MBUR48A
- MBUR60A
- MBUR72A

FREEZERS

- MBUF27A
- MBUF48A
- MBUF60A

FEATURES

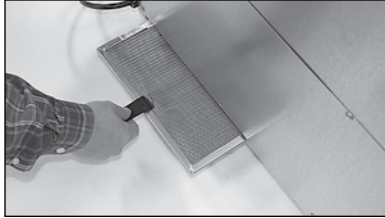

Standard condenser filter screen, removable without tools, for easy condenser coil cleaning resulting in peak efficiency and extended equipment life.

CONSTRUCTION

- Stainless steel interior and exterior
- Foamed-in-place with low ODP polyurethane insulation
- Wall thickness: 2"
- 6" overall height casters
- Adjustable heavy-duty vinyl-coated shelves, one per door
- Front-breathing design allows for zero-clearance installation on sides, back and top

DOORS

- Self-closing with heavy-duty recessed pocket handle
- Standard door swing configuration:
 - 1-door models hinged right
 - 2-door models.....left hinged left, right hinged right
 - 3-door model.....left hinged left, middle door hinged left, right door hinged right
- Door width:
 - MBUR/MBUF27A 27¹/₂"
 - MBUR36A 17¹/₂"
 - MBUR/MBUF48A..... 23¹/₂"
 - MBUR/MBUF60A..... 29¹/₂"
 - MBUR72A 23¹/₂"

REFRIGERATION

- Self-contained forced air capillary tube refrigeration system
- Refrigerant:
 - MBUR-A models R-134a
 - MBUF-A models..... R-513a
- Temperature range:
 - MBUR-A.....34° to 38°F (1° to 3°C)
 - MBUF-A.....-5° to 0°F (-20° to -17°C)

WARRANTY

- **Standard limited three year parts and labor**
- **Additional two year coverage on compressor part**

OPTIONS

- Low profile casters for ADA compliance
 - Stacking kit for MBUR27A
 - Factory installed lefthand door for MBUR27A/MBUF27A
 - Factory installed door locks
 - Additional shelves
 - 4" base (excluding MBUR72A)*
 - Stainless steel backsplash
 - 4" casters in lieu of 6" casters (casters shipped loose)
 - 6" legs in lieu of casters (legs shipped loose)
 - Single or double overshef
 - Refrigerated drawers for MBUR-A models (excluding MBUR36A)
- *Option may also be ordered factory installed

TECHNICAL SPECIFICATIONS

MODEL	DIMENSIONS (in.)			DIMENSIONS (mm)			VOLTS	AMPS	UNIT H.P.	NO. OF DOORS	NO. OF SHELVES	CAP. CU. FT.	SHIP CU. FT.	SHIP WT. (LB/KG)
	L	D	H*	L	D	H*								
REFRIGERATORS														
MBUR27A	27 ^{1/2}	30	36	699	762	917	115	3.6	1/5	1	1	7.2	24.8	190/86
MBUR36A	36	30	36	914	762	917	115	3.6	1/5	2	2	9.9	31.2	220/100
MBUR48A	48	30	36	1219	762	917	115	3.7	1/5	2	2	13.4	40.4	255/116
MBUR60A	60	30	36	1524	762	917	115	5.7	3/8	2	2	16.2	49.4	305/138
MBUR72A	72	30	36	1829	762	917	115	5.7	3/8	3	3	20.5	58.5	365/166
FREEZERS														
MBUF27A	27 ^{1/2}	30	36	699	762	917	115	4.7	1/3	1	1	7.2	24.8	195/89
MBUF48A	48	30	36	1219	762	917	115	6.1	1/2	2	2	13.4	40.4	265/120
MBUF60A	60	30	36	1524	762	917	115	6.1	1/2	2	2	16.2	49.4	320/145

*Height includes casters.

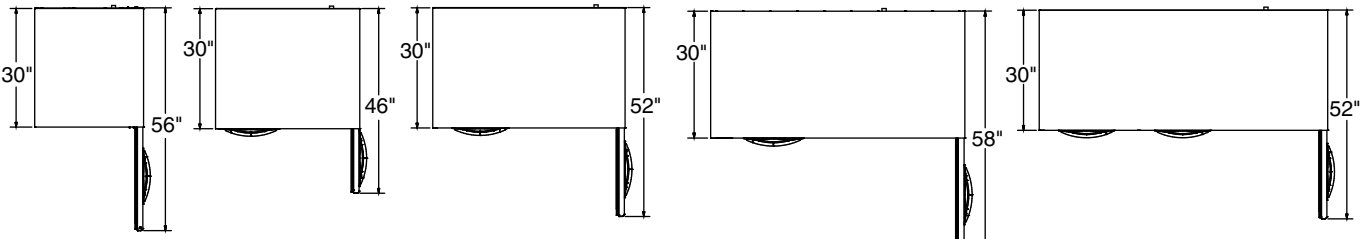

MBUR/MBUF27A
PLAN VIEW

MBUR36A
PLAN VIEW

MBUR/MBUF48A
PLAN VIEW

MBUR/MBUF60A
PLAN VIEW

MBUR72A
PLAN VIEW

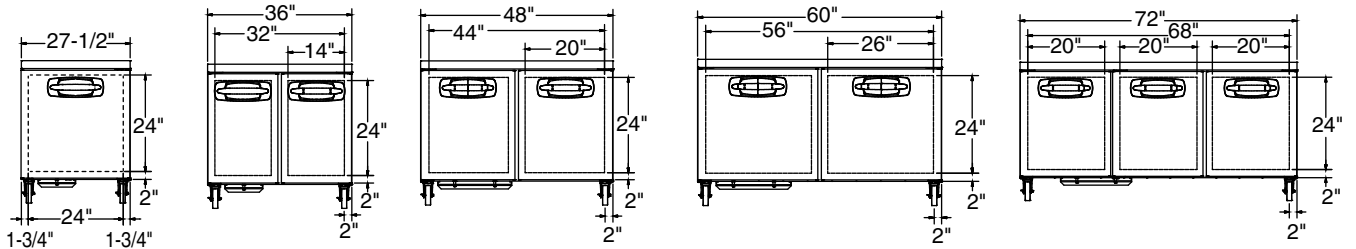

MBUR/MBUF27A
ELEVATION VIEW

MBUR36A
ELEVATION VIEW

MBUR/MBUF48A
ELEVATION VIEW

MBUR/MBUF60A
ELEVATION VIEW

MBUR72A
ELEVATION VIEW

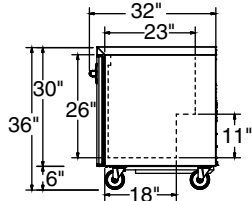

ALL MODELS
SIDE VIEW

LISTINGS



HOOKUP

All models via plug in, 9 foot long flexible three wire 18/3 cord with molded plug.



OPTIONAL REFRIGERATED DRAWER CONFIGURATIONS

MBUR-A models only, not available on MBUR36A.

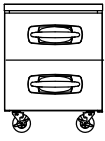

MBUR27A-001

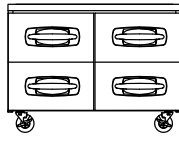

MBUR48A-001

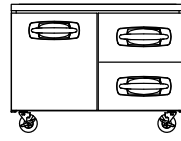

MBUR48A-002

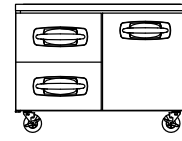

MBUR48A-003

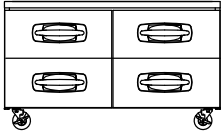

MBUR60A-001

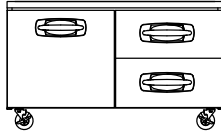

MBUR60A-002

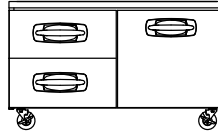

MBUR60A-003

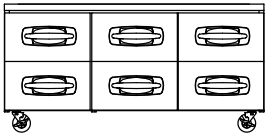

MBUR72A-001

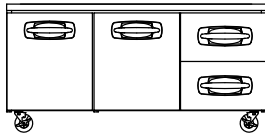

MBUR72A-002

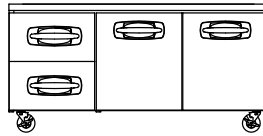

MBUR72A-003

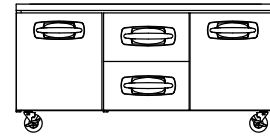

MBUR72A-004

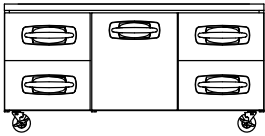

MBUR72A-005

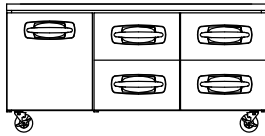

MBUR72A-006

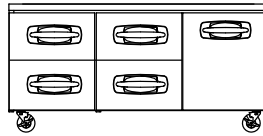

MBUR72A-007

PAN CONFIGURATIONS FOR REFRIGERATED DRAWERS

MBUR-A models only, not available on MBUR36A.

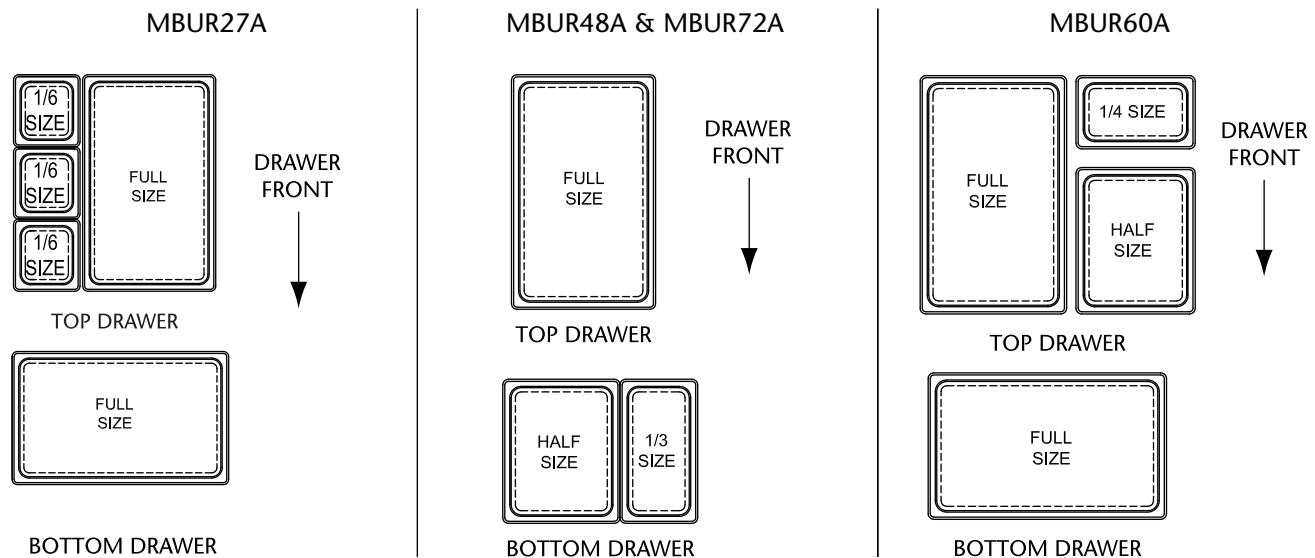

*U.S. size pans, pans provided by others. Drawers accept up to 6-inch deep pans.
Drawers designed to hold up to 150 lbs. each.

OPTIONAL STACKING KIT CONFIGURATIONS

Stacking kits allow two 27 in. wide models to be stacked on top of each other for an over/under effect. Several configurations are possible to help maximize workspace.

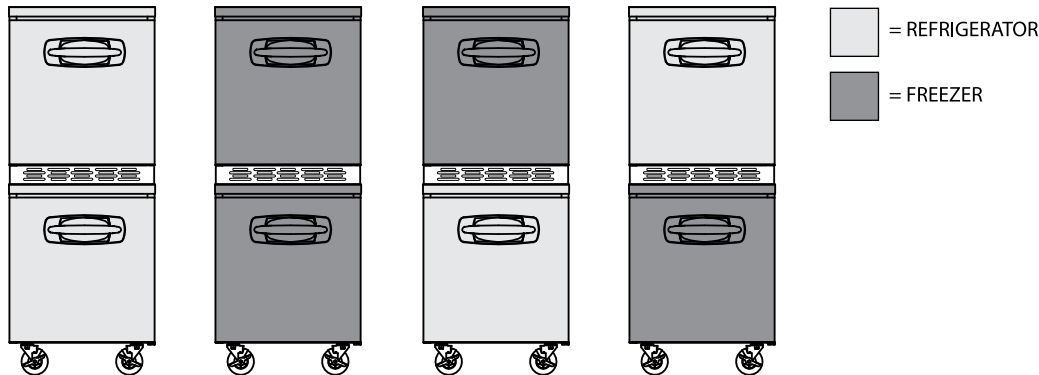

OPTIONAL OVERSHELF SPECIFICATIONS

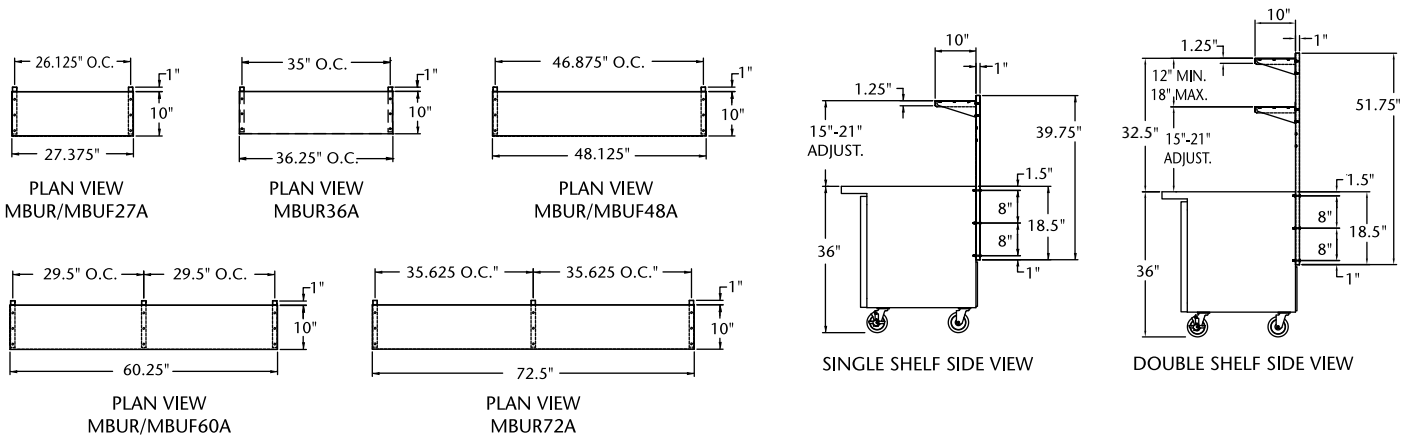

BID SPECIFICATIONS

Item no. MBU____A. Provide _____ Undercounter/worktable refrigerator/freezer(s), Master-Bilt® model no. MBU____A.

Undercounter will feature condenser coil filter screen, removable without tools, for simple preventative maintenance cleaning.

The refrigeration system will be bottom

mounted and self-contained. System will be front-breathing allowing for zero-clearance installation on sides, back and top. Freezers will use R-513a refrigerant. Refrigerators will use R-134a. The temperature range will be 34° to 38°F (1° to 3° C) for refrigerators and -5° to 0°F (-20° to -17°C) for freezers.

Undercounter to have standard limited three year parts and labor with additional two year coverage on compressor part.

Undercounter to be UL & C-UL listed and UL EPH classified.

NOTE: Cabinet designed for optimum performance in air-conditioned area at 75°F ambient and 55% relative humidity. All specifications subject to change without notice.