



Project _____

Item 541CG1N Quantity _____

Approval _____ Date _____

Main Street Equipment CG1N Single Deck Full Size Natural Gas Convection Oven with Legs - 54,000 BTU

Item #541CG1N

Special Features

- Full size cavity houses 3 adjustable wire racks
- Temperature range from 150 to 550 degrees Fahrenheit; automatic ignition system
- 60 minute timer; interior light controlled by rocker switch
- Independent glass doors; stainless steel exterior and interior
- 120V; natural gas, 54,000 BTU total

Technical Data

Width	38 Inches
Depth	43 Inches
Height	57 Inches
Interior Width	29 Inches
Interior Depth	25 Inches
Interior Height	20 Inches
Amps	5.9 Amps
Voltage	120 Volts
Control Type	Dial
Door Type	Glass
Gas Inlet Size	3/4 Inches
Installation Type	Freestanding
Number of Chambers	1
Number of Decks	Single
Number of Doors	2 Doors
Number of Racks	3
Oven Interior Style	Standard Depth
Plug Type	NEMA 5-15P
Power Type	Natural Gas
Size	Full Size
Temperature Range	150 - 550 Degrees F
Total BTU	54000 BTU



Certifications



5-15P



ETL Sanitation



ETL US



3/4" Gas Connection

Technical Drawing

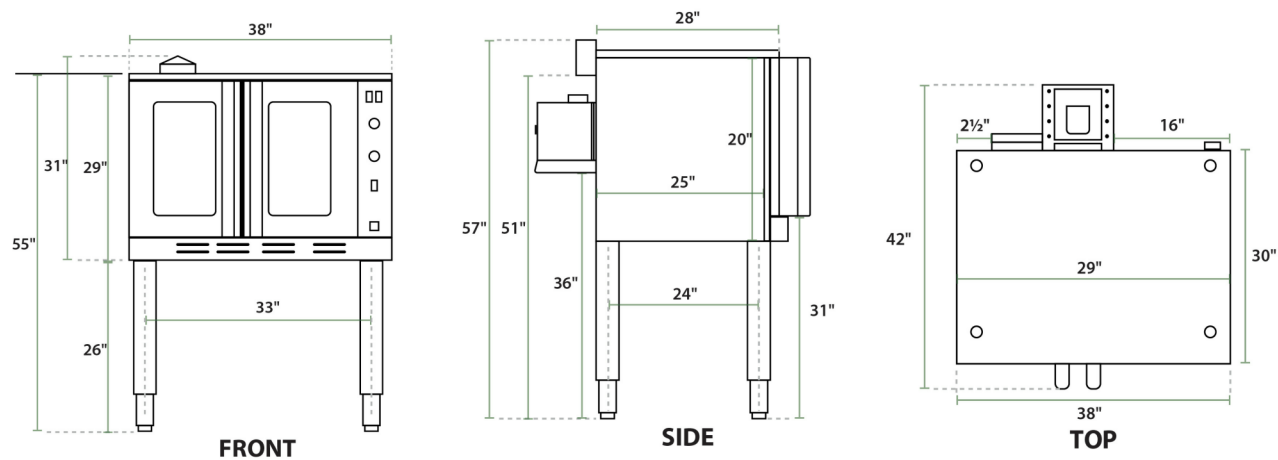

⚠ WARNING: This product can expose you to chemicals including lead, which are known to the State of California to cause cancer, birth defects, or other reproductive harm. For more information, go to www.p65warnings.ca.gov.