



Company name _____
Contact: _____
Phone: _____
E-mail: _____
Accessories: _____

Project _____
Item# _____
Quantity _____
Lamps _____

DUAL LAMP FREE STANDING DLM/200/ST

Description:

Dual mounted warmers in nine distinctive styles to match any décor. Clean "modern " design with no exposed fasteners. All fixtures are constructed using the finest materials and components. Lamp body and switch holder are constructed from heavy gauge spun Aluminum. Standard finishes include Polished Chrome (PC), Stainless (SS), Brass (BR), Black (B), and Smoked Copper (SC). Specialty finishes include True Copper (BC) and custom powder coats. All finishes are non-tarnishing, require no polishing and are easy to clean. All internal components including lamp socket and wiring are high temperature rated (200°C). Each shade style is available with or without a switch. Switch is standard on all models.



Accessories(Must be ordered separately)

- 250 watt shatterproof lamp
-

Standard Features:

- Teflon coated shatterproof light bulb.
- Multiple switch options available.
- Custom options available for bases. Includes sizes and finishes.

Ordering Code: DLM-200-FIN-BB-SW

Switch Mounting "S" Standard Switch, "C" Custom Location, "N" No Switch
Base Color: "BB" Black, "WB" White
Shade Color: "PC" Polished Chrome, "SS" Stainless Steel, "BR" Brass
"B" Black, "SC" Smoked Copper, "BC" True Copper
Shade Style: 200

Examples: **DLM-200-ST-S** =Dual Lamp Mount, Shade style 100, smoked copper finish, Black base, standard switch.
DLM-200-ST-C= Single Lamp Mount, Shade style 100, Stainless Steel finish, White Base, No Switch.

Specifications	
Mechanical	
Parameter	Value
Light head	Satin aluminum, brass, copper, plated chrome or powder coated plated spun aluminum
Light head	5 1/2" diameter x 7 1/2" long
Light head from Mounting surface	Adjustable 10-15"
Base Size	Weighted 7" diameter metal base
Shipping weight	Approximately 10 pounds
Internal wiring	18 gauge silver stranded with Teflon insulation. Rated (200° C)
Lamp socket	Glazed porcelain/nickel. Rated (200° C)
Switch	On/Off rated 15 amps @ 115 VAC
Cord	115 VAC-18 gauge 3 conductor cable 230 VAC-18 gauge 3 conductor harmonized cable
Electrical	
Operating Voltage	115-230, VAC 50-60 Hz, single phase
Power	250 watts Maximum
Operating amperage	5 amps (115 VAC) 2.5 amps (230 VAC)
Lamp type	Infrared 250 watts maximum, shatterproof design.
Safety Listings	
Organizations	

Hanson Heat Lamps. 7530 San Fernando Road Sun Valley, CA 91352, Toll-Free (888) 841-3773, Phone (818)767-3501, Fax (818) 767-7691, Email:info@hansonbrass.com



Company name _____
Contact: _____
Phone: _____
E-mail: _____
Accessories: _____

Project _____
Item# _____
Quantity _____
Lamps _____

DUAL LAMP FREE STANDING DLM/200/ST

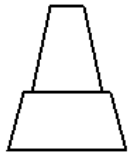

STYLE 100
6 1/2" X 7.5"
DIAMETER X
LENGTH
165mm X
191mm

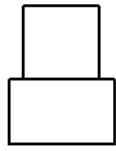

STYLE 200
5 1/2" X 7.5"
DIAMETER X
LENGTH
140mm X
191mm



STYLE 300
7 1/8" X 7.5"
DIAMETER X
LENGTH
181mm X
191mm

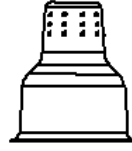

STYLE 600
6 1/2" X 8"
DIAMETER X
LENGTH
165mm X
203mm

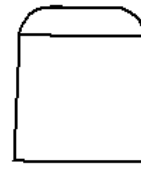

STYLE 700
11 1/8" X 8"
DIAMETER X
LENGTH
283mm X
203mm



STYLE 900
6 1/2" X 8.5"
DIAMETER X
LENGTH
165mm X
216mm

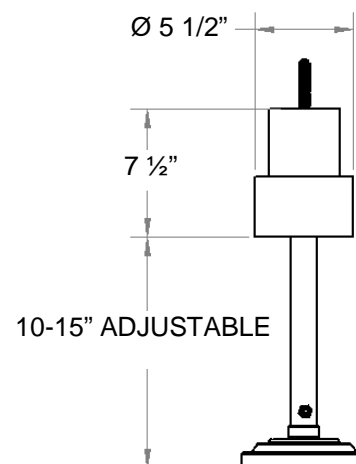
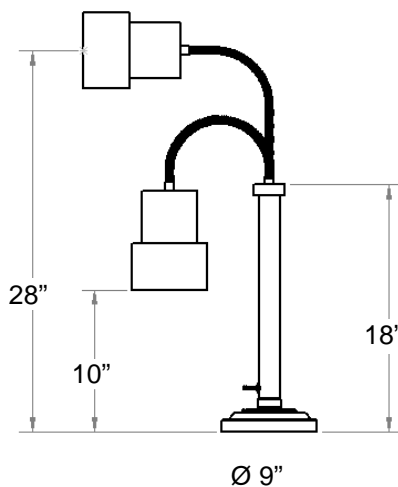
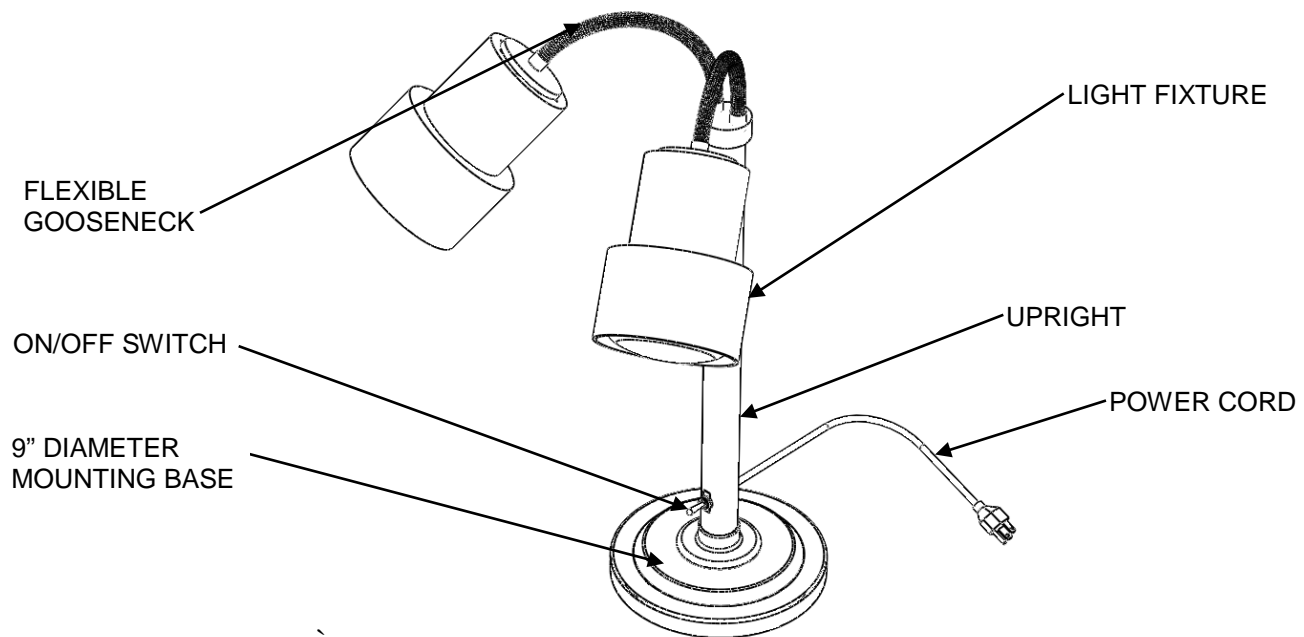

Hanson Heat Lamps. 7530 San Fernando Road Sun Valley, CA 91352, Toll-Free (888) 841-3773, Phone (818) 767-3501, Fax (818) 767-7691, Email: info@hansonbrass.com