

REVISION HISTORY			
REV	DESCRIPTION	DATE	APPROVED
-	Engineering Release	06/20/2019	Todd Stone

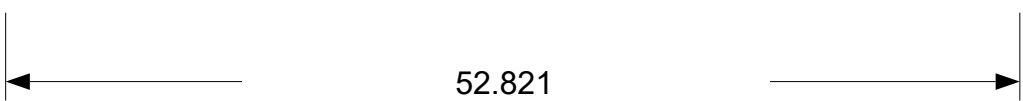

CV-BI-48 Shown
 For CV-BI-24 Dimension is 27.422
 For CV-BI-30 Dimension is 33.422
 For CV-BI-36 Dimension is 39.422

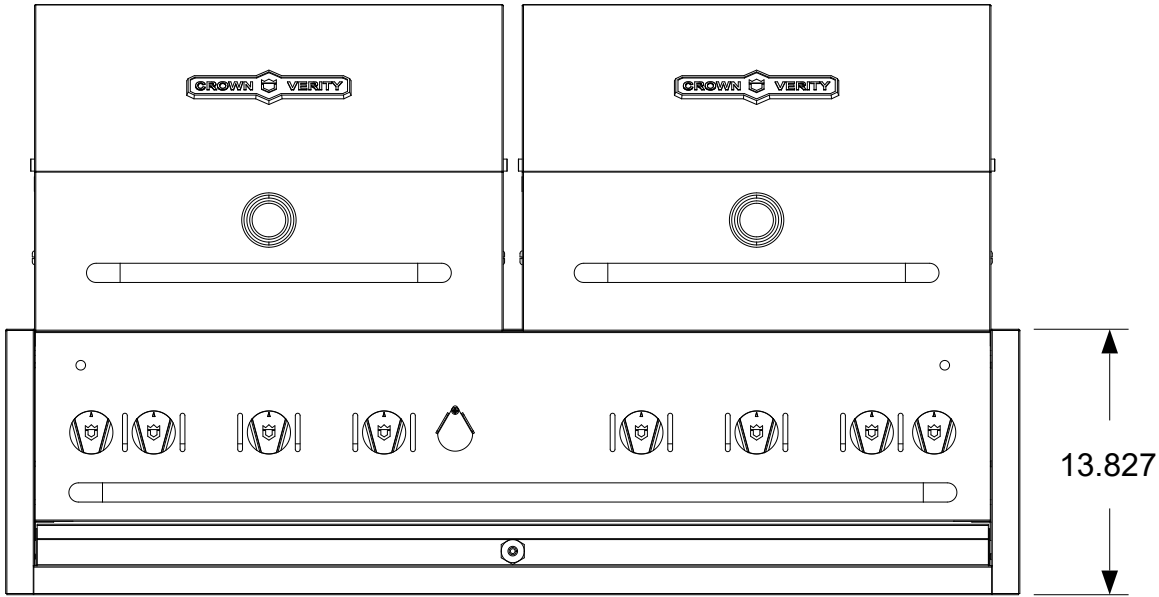
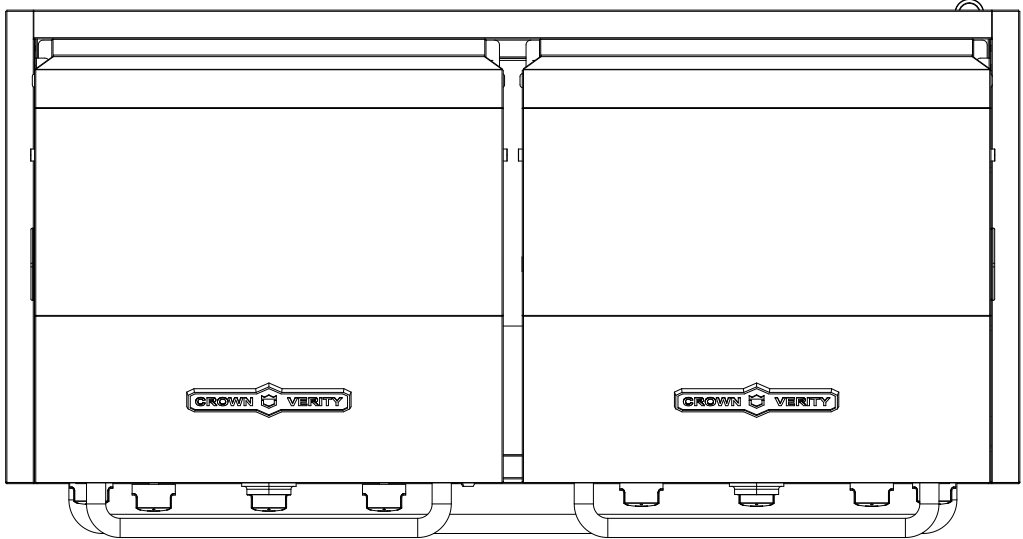
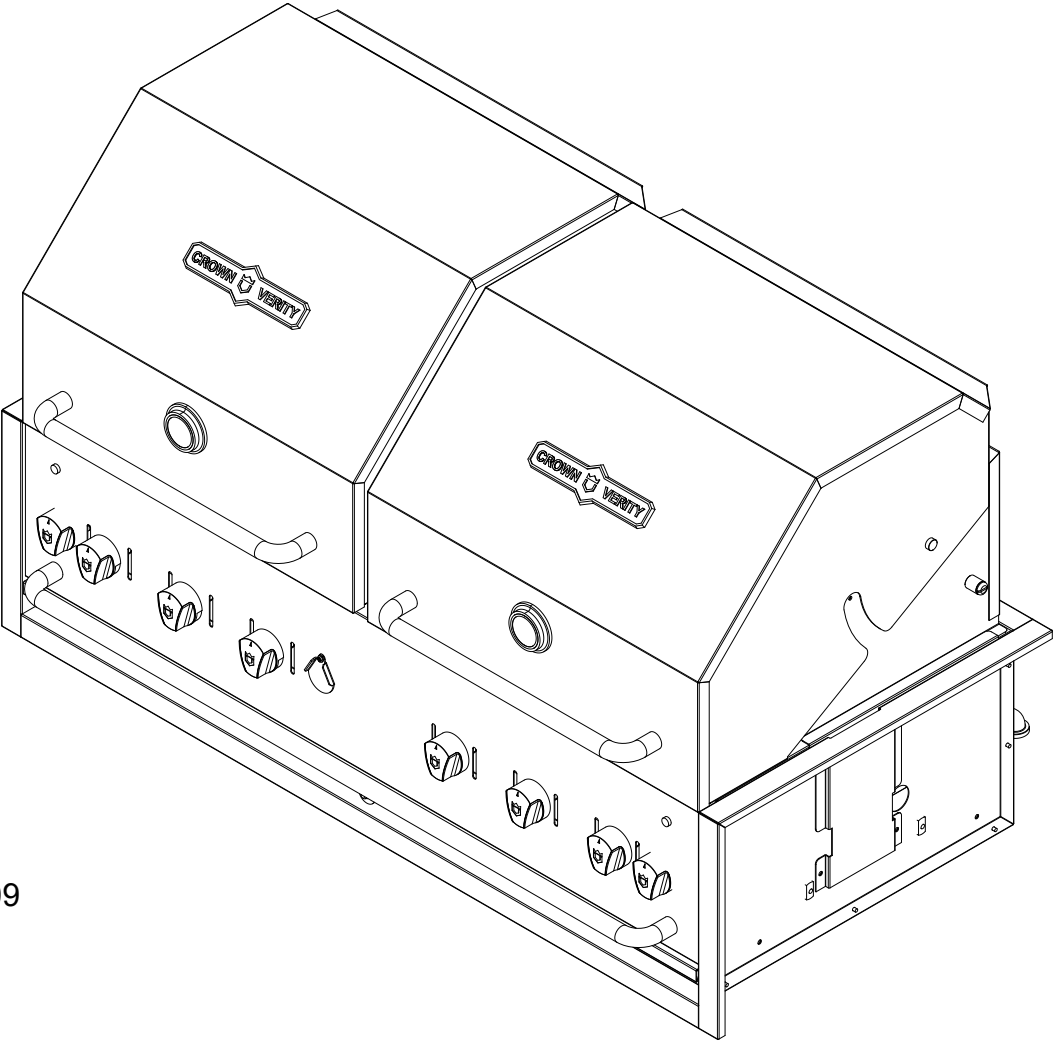
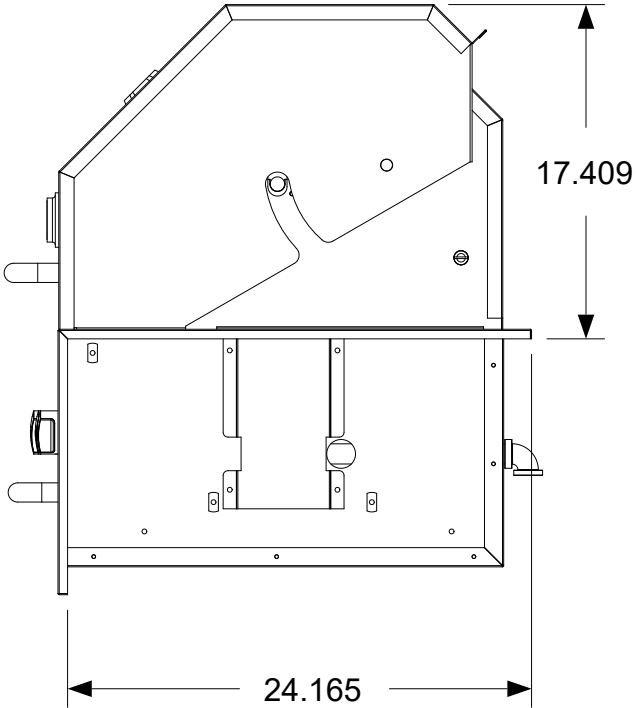

Gauge	N/A	Dimensions are in inches Linear Tolerance: +/- .015 Bend Tolerance: +/- .020 Angular Tolerance: +/- 0.5 Radial Tolerance: +/- .005
Weight (Kg)	N/A	
K Factor	N/A	
Finish	#4	
Material	SS 304	DRAWN BY: Todd Stone

<div> <div>CROWN VERITY</div> <div>37 Adams Blvd., Brantford, Ontario, N3S 7V8</div> <div>P: (519) 751-1800 www.crownverity.com</div> </div>			
<div> <div>TITLE</div> <div>Commercial BI Clearances</div> </div>			
<div> <div>SIZE</div> <div>B</div> </div>	<div> <div>Customer</div> <div>Crown Verity</div> </div>	<div> <div>DWG NO</div> <div>-</div> </div>	<div> <div>REV</div> <div>-</div> </div>
<div> <div>SCALE</div> <div>1:10</div> </div>	<div> <div>06/20/2019</div> </div>	<div> <div>SHEET</div> <div>1 of 3</div> </div>	

REVISION HISTORY			
REV	DESCRIPTION	DATE	APPROVED
-	Engineering Release	06/20/2019	Todd Stone

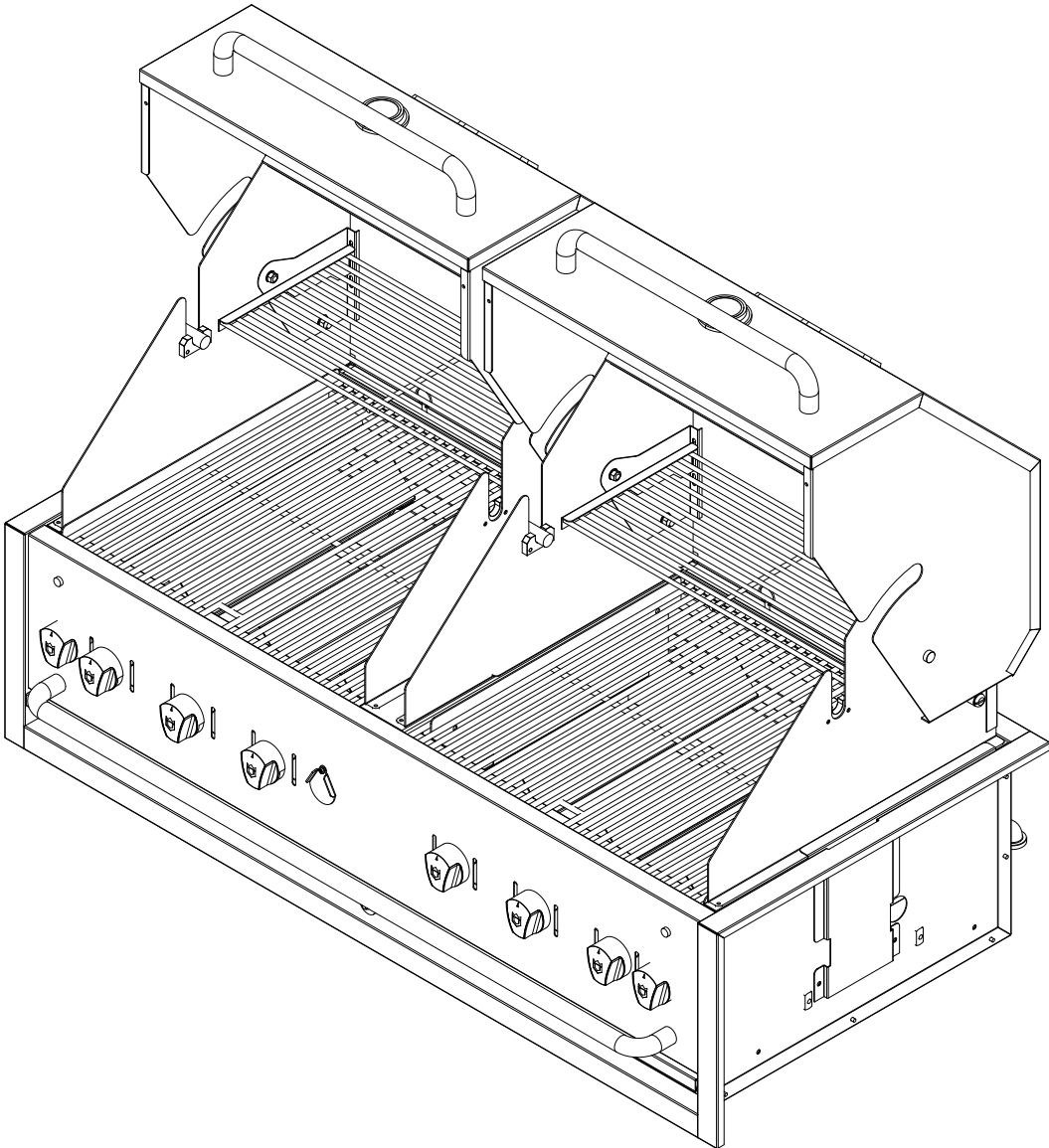
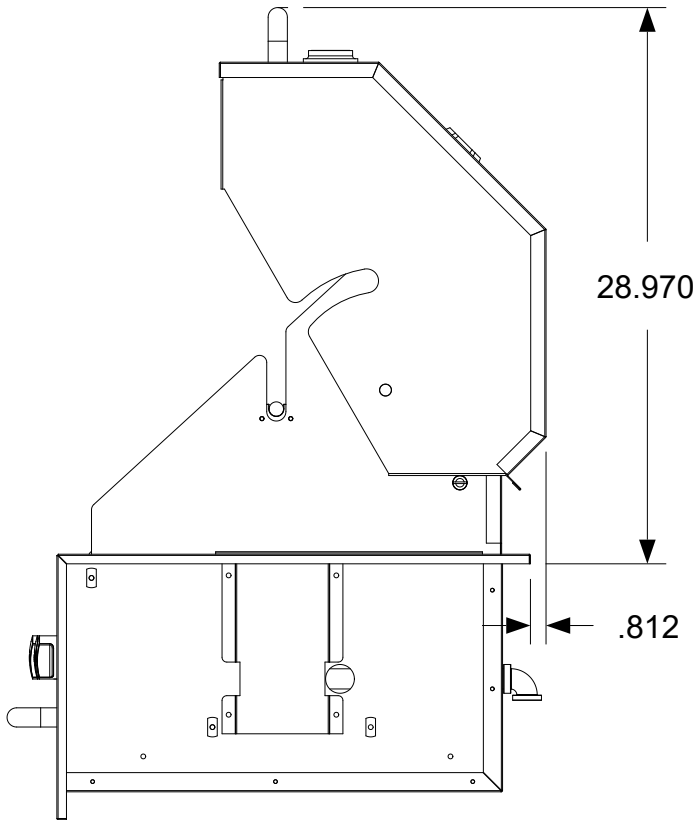
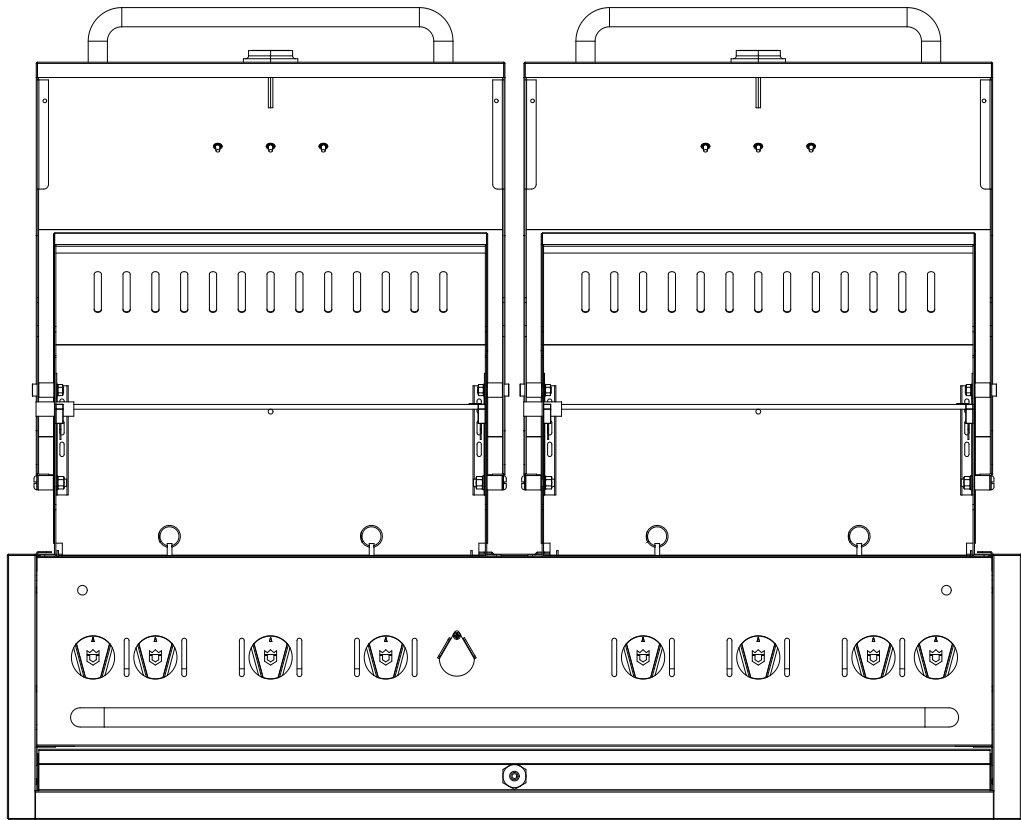
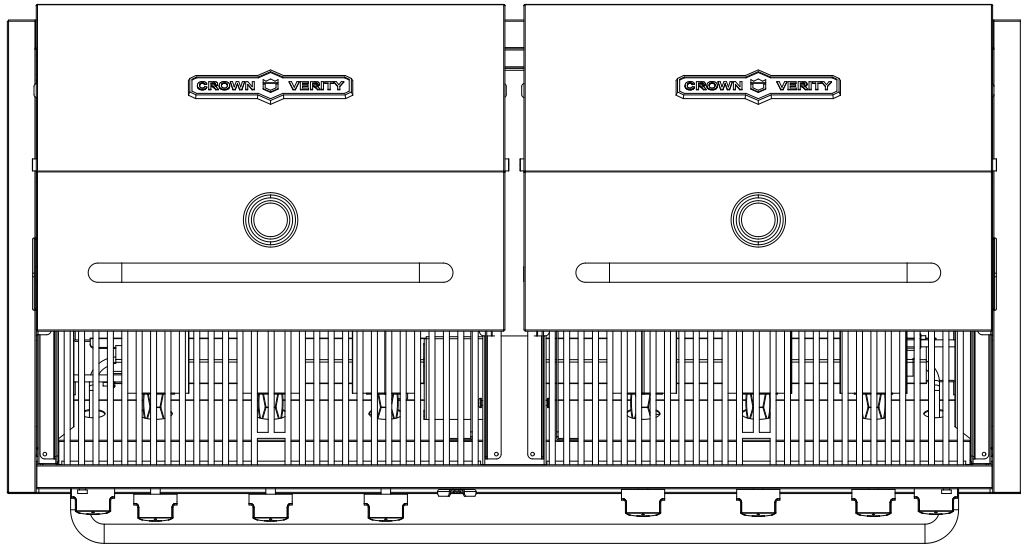



37 Adams Blvd., Brantford, Ontario, N3S 7V8
P: (519) 751-1800 www.crownverity.com

TITLE Commercial BI Clearances			
SIZE B	Customer Crown Verity	DWG NO -	REV -
SCALE 1:10	DATE 06/20/2019		SHEET 2 of 3

Gauge	N/A	Dimensions are in inches Linear Tolerance: +/- .015 Bend Tolerance: +/- .020 Angular Tolerance: +/- 0.5 Radial Tolerance: +/- .005
Weight (Kg)	N/A	
K Factor	N/A	
Finish	#4	
Material	SS 304	DRAWN BY: Todd Stone

REVISION HISTORY			
REV	DESCRIPTION	DATE	APPROVED
-	Engineering Release	06/20/2019	Todd Stone

This dimension is the furthest point the dome protrudes as it opens. It is 1.194 inches further back than the rear flange of the cabinet shell. Please refer to the installation manual for clearances to combustibles when installing the grill assembly.

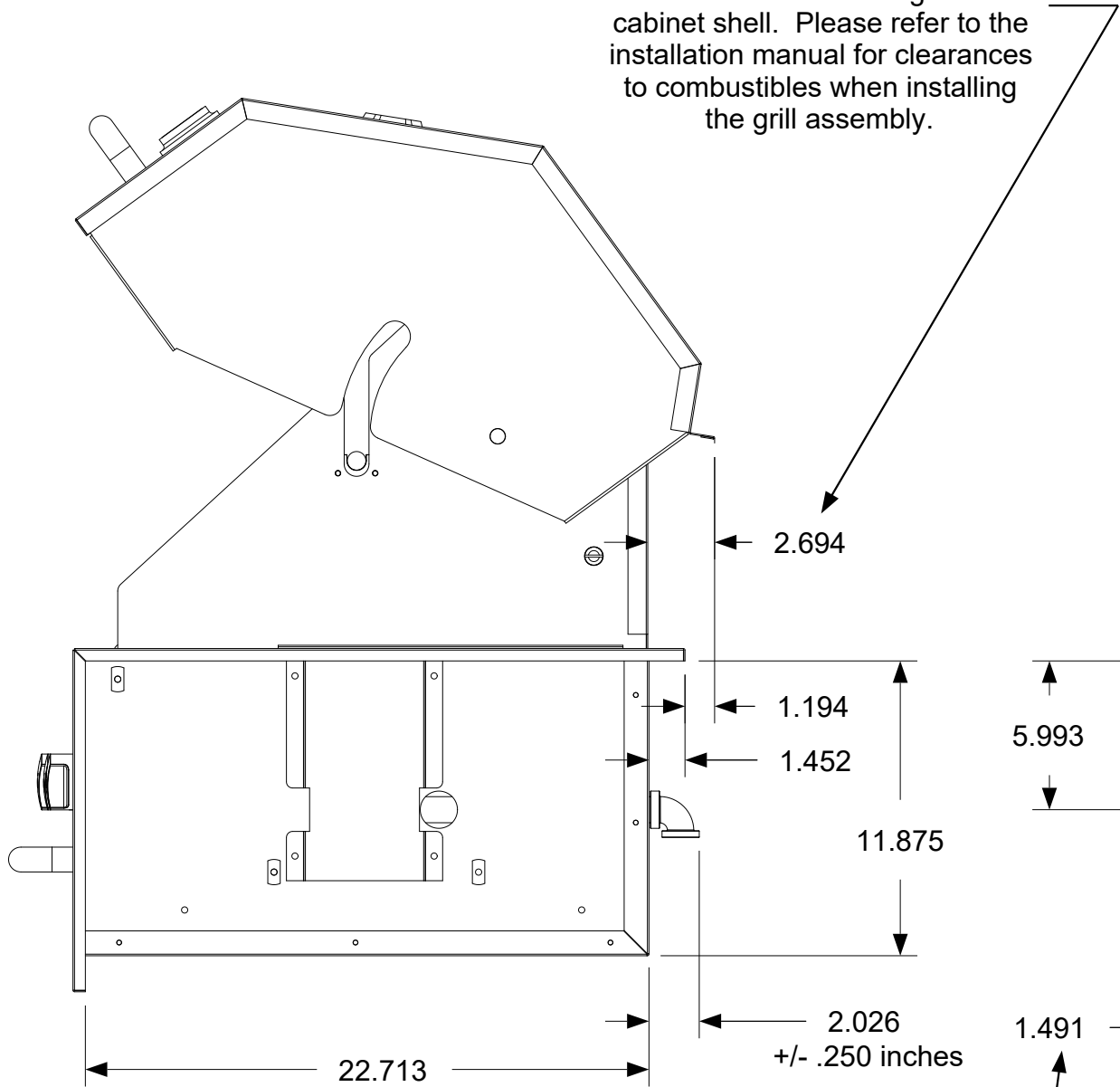

This dimension is from the center of the manifold to the outside of the grill body. Add any additional clearances for the cut-out to this dimension

Dimensions shown are actual physical dimensions. Additional clearances to the cabinetry are dependent on the tolerances of the cut-out. We recommend an additional .250 inches around all openings but this can be reduced if the tolerances are controlled. Please refer to the installation manual for additional clearances and clearances to combustibles.

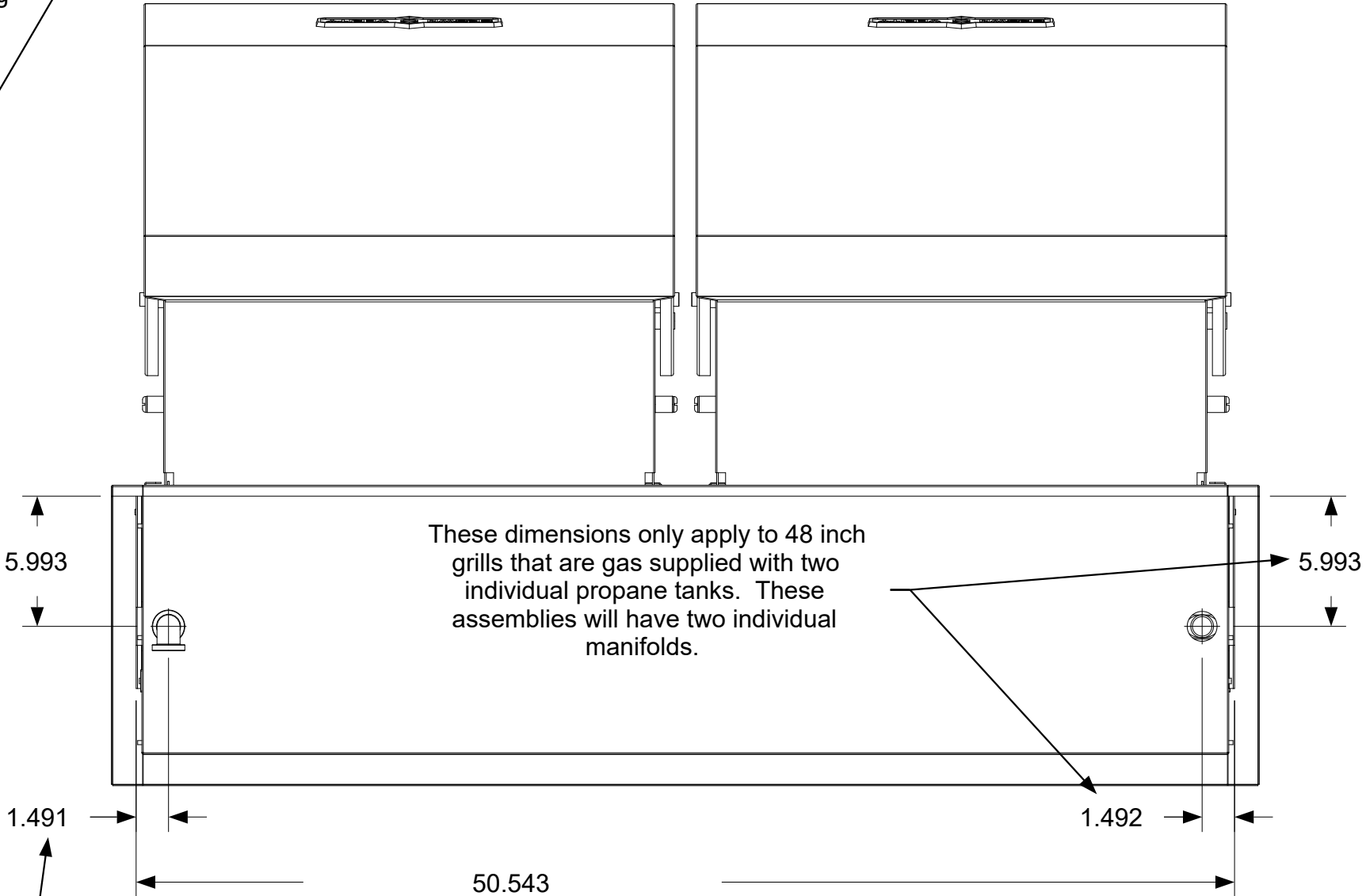

50.543
CV-BI-48 Shown
For CV-BI-24 Dimension is 25.143
For CV-BI-30 Dimension is 31.143
For CV-BI-36 Dimension is 37.143

Gauge	N/A	Dimensions are in inches Linear Tolerance: +/- .015 Bend Tolerance: +/- .020 Angular Tolerance: +/- 0.5 Radial Tolerance: +/- .005
Weight (Kg)	N/A	
K Factor	N/A	
Finish	#4	
Material	SS 304	
DRAWN BY: Todd Stone		

CROWN VERITY 37 Adams Blvd., Brantford, Ontario, N3S 7V8 P: (519) 751-1800 www.crownverity.com			
TITLE Commercial BI Clearances			
SIZE B	Customer Crown Verity	DWG NO -	REV -
SCALE 1:7	06/20/2019	SHEET 3 of 3	