



Item #: 382SCM350R Project: \_\_\_\_\_  
Qty: \_\_\_\_\_ Date: \_\_\_\_\_ Approval: \_\_\_\_\_

# Carnival King Royalty Series SCM350R Reinforced Cabinet Sno- Cone Machine with Cup Dispenser

Item #382SCM350R

## Technical Data

Width	16 1/4 Inches
Depth	14 1/4 Inches
Height	27 1/2 Inches
Amps	2.8 Amps
Hertz	60 Hertz
Voltage	120 Volts
Wattage	350 Watts
Horn Material	Cast Aluminum
Horsepower	1/3 HP
Output	500 Pounds Per Hour
Plug Type	NEMA 5-15P
RPM	1700 RPM
Type	Snow Cone Machines



## Features

- Great addition to concession stands, snack bars, ice cream parlors, or fair carts
- Powerful 1/3 hp motor processes up to 500 lb. of ice per hour
- High-visibility, tempered glass door and acrylic panels with durable aluminum frame
- Heavy-duty design with die-cast aluminum horn, cutting head, and pusher with ergonomic handle
- Slanted bottom with front-mounted drain valve and draining hose; 120V, 1/3 hp, 1700 rpm

## Certifications



ETL US &  
Canada



CE Listed



5-15P

## Plan View

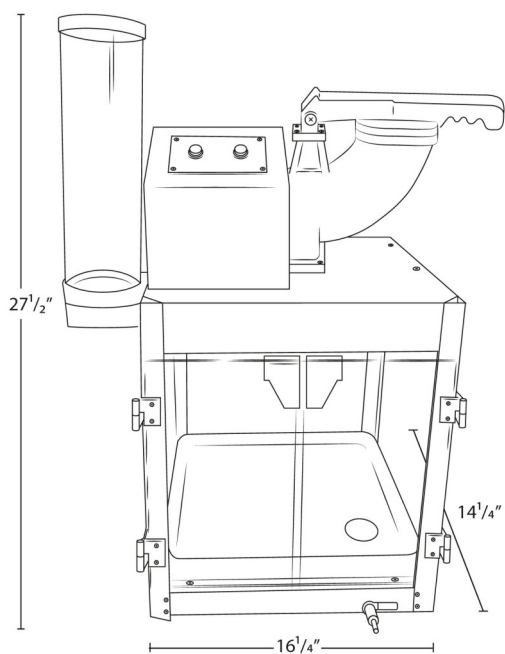

## Notes & Details

Bring a carnival favorite to any concession stand, snack bar, ice cream parlor, or fair cart with this Carnival King Royalty Series SCM350R reinforced cabinet sno-cone machine with removable cup dispenser! Whether you're working with cube or chunk ice, this impressive high-capacity machine effectively processes up to 500 lb. of ice per hour so you can keep up with the busiest rushes. To make serving as easy as possible, an attached cup dispenser holds 8 oz. sno-cone cups. The cabinet holds up to 40 lb. (550 oz.) of processed ice, giving you the flexibility to store extra ice to prepare orders quickly on busy days. This unit helps you serve refreshing and tasty treats all summer long!

The backbone of this snow cone machine is its powerful 1/3 hp motor that delivers speeds of 1700 RPM. High-visibility tempered glass doors and acrylic panels, as well as the removable cup dispenser and decal help merchandise the freshly processed ice. The die-cast aluminum horn, cutting head, and pusher with micro safety switch as well as the stainless steel blades provide you with a durable construction that's guaranteed to last. A safety reset button prevents accidental startup to help protect employees, while a slanted bottom, front-mounted drain valve and draining hose make cleaning a breeze. A 6-8 oz. stainless steel scoop is included for easy and sanitary service. A 120V electrical connection is required for operation.



**WARNING:** This product can expose you to chemicals including lead, which are known to the State of California to cause cancer, birth defects, or other reproductive harm. For more information, go to [www.p65warnings.ca.gov](http://www.p65warnings.ca.gov).