

# Set-up Stations

## Mobile Stainless Steel

Spec. # \_\_\_\_\_

AIA # \_\_\_\_\_



Model 4612  
 (Shown in Hard Rock  
 Maple finish)

### Add Organization And Enhance The Appearance Of Dining Areas

#### Benefits

- Add attractive service functionality to patios and indoor dining areas
- Easy mobility to provide dining room flexibility

#### Features

- Stainless steel welded construction
- Sealed disposal receptacle for waste liquids
- Choice of stainless steel or laminate exterior finishes
- Concealed casters provide built-in look
- Open and concealed storage

#### Casters

- All-swivel 5" cushion tread

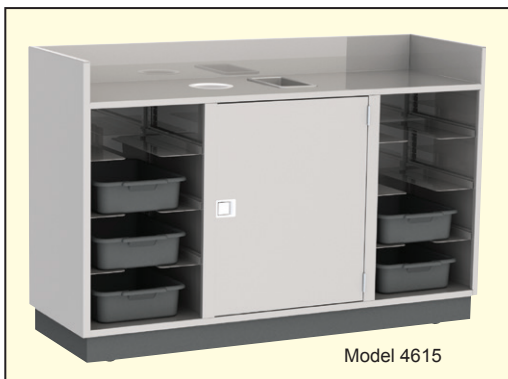

Model 4615

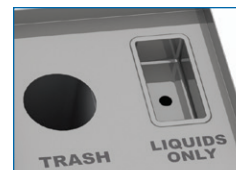

Liquid disposal and waste chute



Sealed 7-gallon waste liquid receptacle

#### Specifications:

Unit shall be of welded stainless steel construction and shall have 20-gauge sides and 18-gauge top. Interior compartment floor shall be 18-gauge stainless steel. Top shall have 6" high wall on three sides. Open compartment(s) shall include three sets of adjustable-height universal ledges to accommodate bus tubs or various trays. Unit top shall feature a refuse chute and drop-in stainless steel drainage sink for liquid waste. Sink shall drain to a sealed 7-gallon polyethylene waste liquid receptacle. Enclosed compartment shall include space for liquid receptacle and waste bin (bin not included). Hinged compartment door shall have recessed paddle latch. 5" all-swivel casters with cushion tread wheels shall be recessed/hidden and shall be fastened to a galvanized steel dolly frame for extra strength.

# Set-up & Bussing Stations

## Mobile Stainless Steel

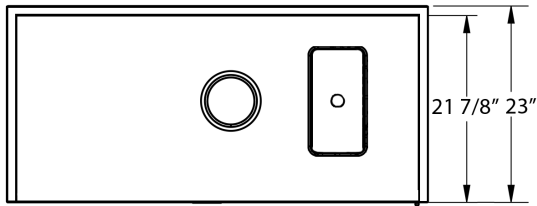

Model 4610

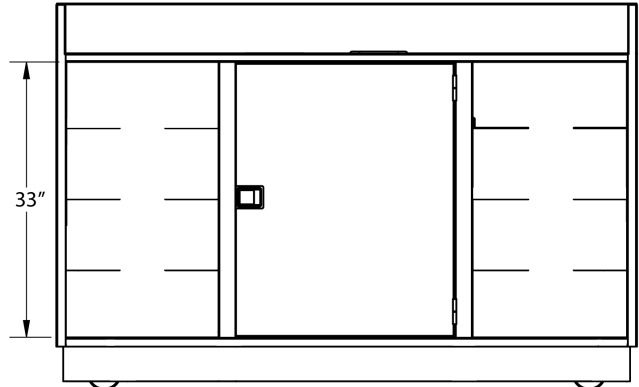

Model 4615

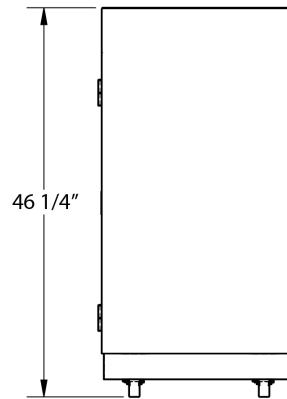
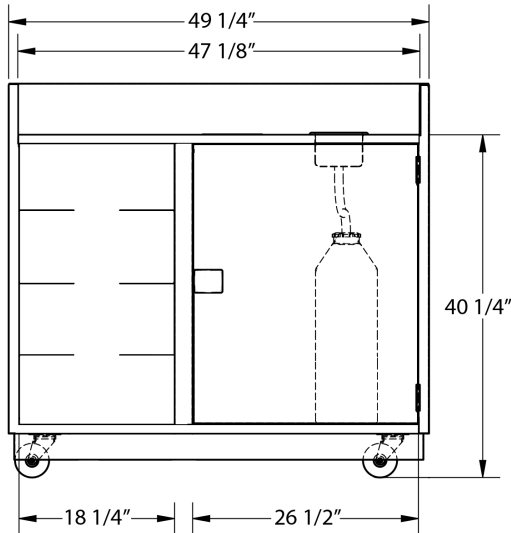

Spec. #

AIA #

### Product Information:

Model	Overall Size			Encl. Compartment			Open Compartment(s)			Exterior Finish	Case Wt. Lbs. (Kg)
	W	D	H	W	D	H	W	D	H		
4610	49 1/4" (1251)	23" 584	46 1/4" 1175	26 1/2" (673)	21 3/4" 552	33" 838	18 1/4" (464)	21 1/4" 552	33" 838	Stainless Steel	355 (161)
4612	49 1/4" (1251)	23" 584	46 1/4" 1175	26 1/2" (673)	21 3/4" 552	33" 838	18 1/4" (464)	21 1/4" 552	33" 838	Laminate	362 (164)
4615	69 3/4" (1272)	23" 584	46 1/4" 1175	26 1/2" (673)	21 3/4" 552	33" 838	18 1/4" (464)	21 1/4" 552	33" 838	Stainless Steel	377 (171)
4618	69 3/4" (1272)	23" 584	46 1/4" 1175	26 1/2" (673)	21 3/4" 552	33" 838	18 1/4" (464)	21 1/4" 552	33" 838	Laminate	384 (174)

Dimensions in ( ) denote metric millimeters, unless otherwise noted.

### Accessories:

- 23-gal. poly waste bin (20" x 11" x 30") \_\_\_\_\_

### Available Laminate Finishes

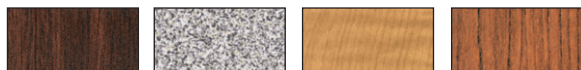

- Walnut
- Gray Sand
- Light Maple
- Victorian Cherry



- Beige Suede
- Hard Rock Maple
- Red Maple
- Red
- Green
- Black
- Royal Blue
- Purple

### Options:

- Leveling feet (in place of casters)
- Removable overshelf (full)
- 6" wide tread casters
- Removable overshelf (half)
- Plumbed sink with faucet



Lakeside Manufacturing, Inc.

4900 West Electric Avenue • West Milwaukee, WI 53219 U.S.A.

800-558-8565 • 414-902-6400 • Fax 414-902-6446 • www.eLakeside.com