

## ADVANTEDGE™ UNDERCOUNTER / WORKTABLE REFRIGERATORS



PROJECT:  
.....  
ITEM NUMBER:  
.....  
MODEL NUMBER:  
.....

### SPECIFICATIONS FOR: NLUR27A, NLUR36A, NLUR48A, NLUR60A, NLUR72A

- **Finish:** Stainless steel interior and exterior
- **Insulation:** The complete cabinet and doors are foamed-in-place with polyurethane insulation
- **Hardware:** Curved handle with recessed pocket; one vinyl coated shelf per door; 6" overall height casters; front-breathing design allows for zero-clearance installation on sides, back and top
- **Electrical:** 115 volt, 60 Hz, 1 phase with cord and plug
- **Refrigeration:** Self-contained forced air refrigeration system. The condensate is collected and automatically evaporated from an energy efficient vaporizer. Refrigerant flow is controlled by a capillary tube. R-134a refrigerant. Temperature range: +34°F to +38°F.
- **Approvals:** UL, C-UL Safety, and UL Sanitation \*\*, and ADA compliant \*\*\*

### STANDARD FEATURES

- Air cooled condensing unit
- Automatic condensate vaporizer
- Automatic defrost
- Capillary tube system
- Casters
- Curved handle with recessed pocket
- Magnetic gaskets
- Self-closing doors
- Stainless steel interior and exterior
- Vinyl coated shelves
- UL, C-UL Safety, and UL Sanitation listed \*\*
- Warranties: 3 year parts & labor, 5 year compressor

### OPTIONAL FEATURES\*

- Additional shelves
- Stainless steel backsplash
- Drawers
- Low profile casters \*\*\*
- Single and double overshef assemblies
- Stacking kit, 27" model only
- 4" Base kit
- 6" Legs
- Door locks

\* Most options are available two weeks from receipt of order. Please contact us for specific questions.  
\*\* C-UL is Underwriters Laboratories Safety Certification Mark which indicates that UL has tested the equipment to applicable CSA Standards.  
\*\*\* UL Sanitation is Underwriters Laboratories Sanitation Mark which indicates that UL has tested the equipment to applicable NSF Standards..

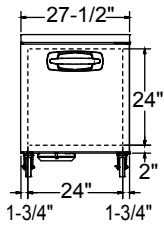

FRONT VIEW

NLUR27A

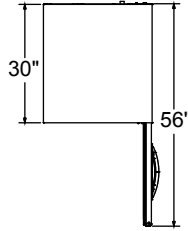

TOP VIEW

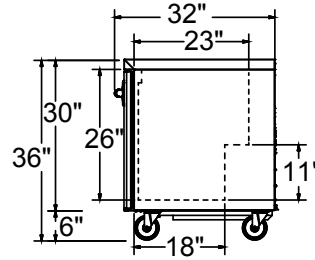

ALL MODELS  
SIDE VIEW

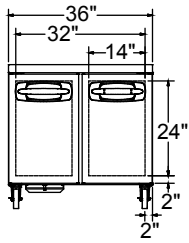

FRONT VIEW

NLUR36A

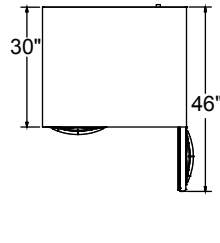

TOP VIEW

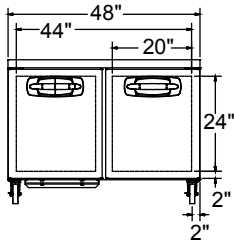

FRONT VIEW

NLUR48A

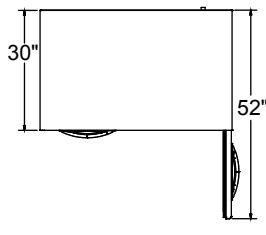

TOP VIEW

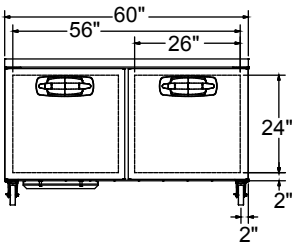

FRONT VIEW

NLUR60A

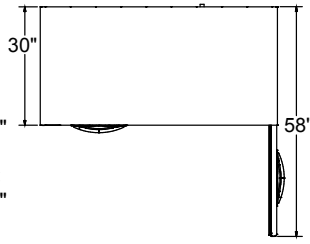

TOP VIEW

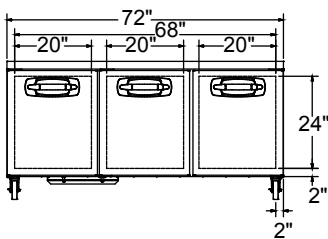

FRONT VIEW

NLUR72A

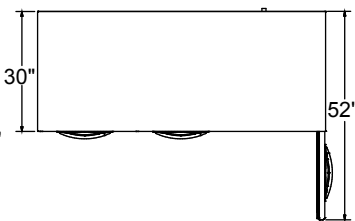

TOP VIEW

**SPECIFICATIONS**

Models	NLUR27A	NLUR36A	NLUR48A	NLUR60A	NLUR72A
Crated Weight (lbs) (kg)	190 (86)	220 (100)	255 (116)	305 (138)	365 (166)
Crated Height (in) (cm)	36-1/4 (92)	36-1/4 (92)	36-1/4 (92)	36-1/4 (92)	36-1/4 (92)
Crated Width (in) (cm)	30-1/8 (75)	37-1/4 (95)	51-1/8 (130)	63 (160)	74-3/8 (189)
Crated Depth (in) (cm)	33-1/2 (85)	33-1/2 (85)	33-1/2 (85)	33-1/2 (85)	33-1/2 (85)
Interior Height (in) (cm)	26-1/8 (66)	26-1/8 (66)	26-1/8 (66)	26-1/8 (66)	26-1/8 (66)
Interior Width (in) (cm)	24 (61)	32-1/2 (82)	44 (112)	56 (142)	68 (172)
Interior Depth (in) (cm)	23 (58)	23 (58)	23 (58)	23 (58)	23 (58)
Overall Height (in) (cm)	36 (91)	36 (91)	36 (91)	36 (91)	36 (91)
Overall Width (in) (cm)	27-1/2 (70)	36 (91)	48 (122)	60 (152)	72 (183)
Overall Depth (in) (cm)	30 (76)	30 (76)	30 (76)	30 (76)	30 (76)
Gross Cubage (CuFt) (L)	7.2 (203)	9.9 (280)	13.4 (379)	16.2 (458)	20.5 (580)
Number of Shelves	1	2	2	2	3
Shelf Area (SqFt) (Sqm)	2.75 (0.26)	4.12 (0.38)	5.30 (0.49)	7.32 (0.68)	8.05 (0.75)
Number of Casters	4	4	4	4	4
Condensing Unit Size	1/5 HP	1/5 HP	1/5 HP	3/8 HP	3/8 HP
Refrigerant	R-134a	R-134a	R-134a	R-134a	R-134a
Electrical Characteristics	115/60/1	115/60/1	115/60/1	115/60/1	115/60/1
Cord and Plug Furnished	Yes	Yes	Yes	Yes	Yes
NEMA Plug Configuration	5-15P	5-15P	5-15P	5-15P	5-15P
Total Amp Draw	3.6	3.6	3.7	5.7	5.7

Specifications subject to change without notice.



Revision Date: 03/17  
©2016 Nor-Lake, Inc.  
Printed in the USA  
Part Number: 146627