

APPLICATION:

PRODUCT NAME:

SINGLE DECK FAUCET WITH  
SWIVEL GOOSENECK SPOUT

JOB NAME:

☐ SPECIAL CONFIGURATION  
CHECK BASE MODEL AND OPTIONS

QUANTITY:

ITEM NO.

MODEL:

- ☐ 86665 WITH 12" SWIVEL GOOSENECK SPOUT  
☐ 46698 WITH 6" SWIVEL GOOSENECK SPOUT

OPTIONS OR MODIFICATIONS:

- ☐ SUPPLY LINES (24" OR 36") CIRCLE LENGTH  
☐ VANDAL RESISTANT KIT  
☐ HANDLES (CROSS OR WRIST) CIRCLE STYLE  
☐ OTHER \_\_\_\_\_

FEATURES

CONTROL VALVE

- \* SINGLE DECK MOUNT
- \* SWIVELLING SEAT DISK
- \* STEM - LEFT HAND
- \* STAINLESS STEEL SEAT
- \* STAINLESS STEEL SEAT SCREW
- \* STAINLESS STEEL HANDLE SCREW
- \* HOT AND COLD INDEX BUTTONS

SYSTEM LIMITS

- \* TEMP: 40°F MIN. TO 140°F MAX.
- \* PRESSURE: 200 PSI MAX. STATIC
- \* 2.2 GPM AT 60 PSI

SHIPPING WEIGHT

- \* 3.25 LBS

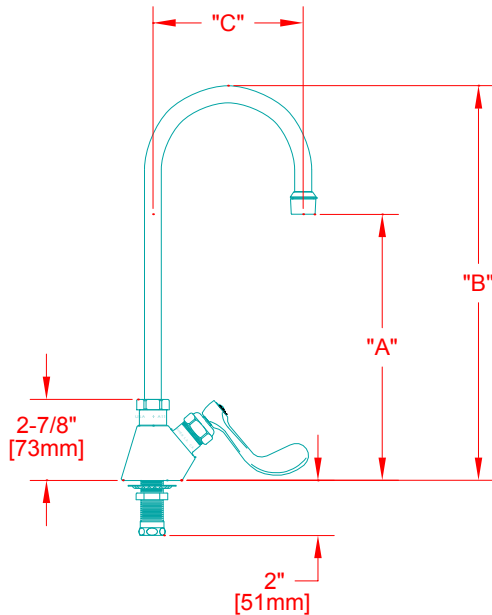

MODEL	DIM "A"	DIM "B"	DIM "C"
86665	9-1/8" [232mm]	13" [330mm]	5-1/2" [140mm]
46698	5-1/8" [130mm]	8-5/8" [219mm]	3-1/2" [89mm]

ROUGH-IN:

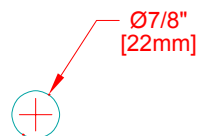

ANSI/A112.18.1M

# FISHER

FISHER MANUFACTURING COMPANY

TOLL FREE: 800-421-6162 - FAX: 800-832-8238

information@fisher-mfg.com - www.fisher-mfg.com