



BEVERAGE-AIR

Project: _____	AIA#
Item: _____	
Location: _____	SIS#
Approved: _____	

DZD BAR EQUIPMENT-DUAL ZONE

DZD58G Dual-Zone Glass Door and Two Solid Wine Drawers

MODEL:
DZD58G-1-B-2
DZD58G-1-S-2



DZD58G-1-B-2



DZD58G-1-S-2

3 Year Parts/Labor Warranty
Additional 2 Year Compressor Warranty

CABINET CONSTRUCTION

- Black or stainless steel exterior & interior finishes available
- Stainless steel top
- Full electronic control
- Dual-zone models feature 2 independent compartments that allow independent temperature in each section
- Left hand compartment maintains 32°-40°F, Right hand maintains 50°-65°F.
- Unit has a minimum variance of 15°+/-15°F, and maximum of 20°F depending on condition
- LED lighting, standard
- Door and drawer locks
- Snap-in door gaskets
- Magnetic gaskets provides positive door and drawer sealing
- Self-closing door
- Two (2) epoxy coated shelves on left
- Two solid pull-out wine drawer on the right
- Wine drawer holds 30 standard bottles of wine

OPTIONS & ACCESSORIES

- Solid door models
- Tap Locks
- 1-4 Tap insulated stainless towers/taps
- Glass rinser
- Sub-top model available

REFRIGERATION SYSTEM

- Refrigeration system uses R134a refrigerant to comply with all environmental concerns
- Automatic, non-electric evaporator
- Epoxy coated evaporator coil

DZD58G Dual-Zone: Bar Equipment



3779 Champion Blvd., Winston-Salem, NC 27105
 1-888-845-9800 Fax: 1-336-245-6453
 Beverage-Air.com sales@bevair.com



BEVERAGE-AIR

MODEL	DZD58G-1-B-2	DZS58G-1-S-2
EXTERNAL DIMENSIONAL DATA		
Width Overall	59"	59"
Depth Overall with Handle	29 3/4"	29 3/4"
Height Overall	37 1/4"	37 1/4"
Number of Doors	1	1
Door Opening	21 1/8" x 30"	21 1/8" x 30"
Depth with Door Open 90°	50 1/2"	50 1/2"
Number of Wine Drawers	2	2
Drawer Opening Extended	52 5/8"	52 5/8"
INTERNAL DIMENSIONAL DATA		
NET Capacity (cubic ft.)	20.354	20.354
Internal Width Overall (in)	(L) 22 1/8" (R) 21 1/4"	(L) 22 1/8" (R) 21 1/4"
Internal Depth Overall (in)	23 1/8"	23 1/8"
Internal Height Overall (in)	32"	32"
Number of Shelves	2	2
ELECTRICAL DATA		
Full Load Amperes 115/60/1	7.4	7.4
REFRIGERATION DATA		
Horsepower	3/4	3/4
WEIGHT DATA		
Gross Weight (Crated lbs)	548 lbs	554 lbs
Height - Crated	45.5"	45.5"
Width - Crated	62"	62"
Depth - Crated	32"	32"

Bar Equipment - Dual-Zone

Models: DZD58G-1-B-2, DZS58G-1-S-2

Model Views

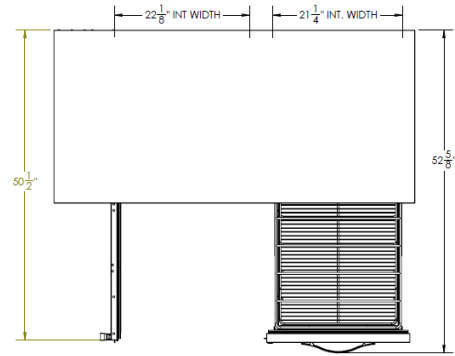

Plan View

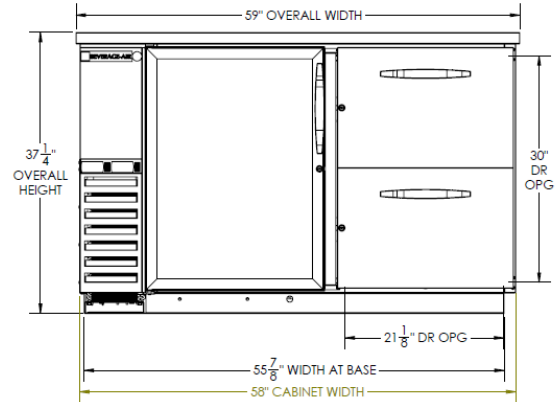

Elevation View

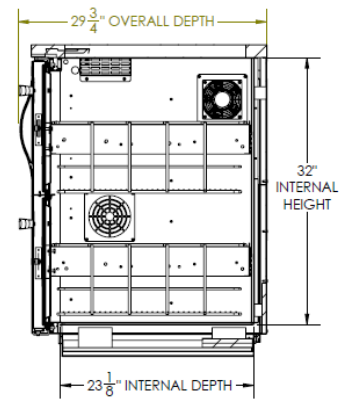

Side View

ELECTRICAL CONNECTION



115/60/1
NEMA-5-15P

Units pre-wired at factory and include 8' long cord and plug set.



an Ali Group Company



The Spirit of Excellence

3779 Champion Blvd., Winston-Salem, NC 27105
1-888-845-9800 Fax: 1-336-245-6453
Beverage-Air.com sales@bevair.com