



# BEVERAGE-AIR

Project: _____	AIA#
Item: _____	
Location: _____	SIS#
Approved: _____	

## DZ BAR EQUIPMENT-DUAL ZONE

### DZ58 Dual-Zone Glass Door and Pull-out Wine Drawer

**MODEL:**

**DZ58G-1-B-PWD**

**DZ58G-1-S-PWD**



**DZ58G-1-B-PWD**



**DZ58G-1-S-PWD**

**3 Year Parts/Labor Warranty**  
**Additional 2 Year Compressor Warranty**

#### CABINET CONSTRUCTION

- Black or stainless steel exterior & interior finishes available
- Stainless steel top
- Full electronic control
- Dual-zone models feature 2 independent compartments that allow independent temperature in each section
- Left hand compartment maintains 32°-40°F, Right hand maintains 50°-65°F.
- Unit has a minimum variance of 15°+/-15°F, and maximum of 20°F depending on condition
- LED lighting, standard
- Door locks
- Snap-in door gaskets
- Magnetic gaskets provides positive door sealing
- Self-closing doors
- Two (2) heavy-duty epoxy coated shelves on left
- Pull-out wine drawer on the right
- Six (6) wine shelves

#### OPTIONS & ACCESSORIES

- Solid door models
- Pull out keg drawer models
- Sub-top model available
- Tap Locks
- 1-4 Tap insulated stainless towers/taps
- Glass rinser
- 3" Casters

#### REFRIGERATION SYSTEM

- Refrigeration system uses R134a refrigerant to comply with all environmental concerns
- Automatic, non-electric evaporator
- Epoxy coated evaporator coil

**DZ58 Dual-Zone: Bar Equipment**



3779 Champion Blvd., Winston-Salem, NC 27105  
 1-888-845-9800 Fax: 1-336-245-6453  
 Beverage-Air.com sales@bevair.com



# BEVERAGE-AIR

## Bar Equipment - Dual-Zone

Models: DZ58G-1-B-PWD, DZ58G-1-S-PWD

MODEL	DZ58G-1-B-PWD	DZ58G-1-S-PWD
<b>EXTERNAL DIMENSIONAL DATA</b>		
Width Overall	59"	59"
Depth Overall with Handle	29 3/4"	29 3/4"
Height Overall	37 1/4"	37 1/4"
Number of Doors	2	2
Door Opening	21 1/8" x 30" (2)	21 1/8" x 30" (2)
Depth with Door Open 90°	50 1/2"	50 1/2"
<b>INTERNAL DIMENSIONAL DATA</b>		
NET Capacity (cubic ft.)	20.354	20.354
Internal Width Overall (in)	(L) 22 1/8" (R) 21 1/4"	(L) 22 1/8" (R) 21 1/4"
Internal Depth Overall (in)	23 1/8"	23 1/8"
Internal Height Overall (in)	32"	32"
Number of Shelves	2	2
Number of Wine Shelves	6	6
<b>ELECTRICAL DATA</b>		
Full Load Amperes 115/60/1	7.4	7.4
<b>REFRIGERATION DATA</b>		
Horsepower	3/4	3/4
<b>WEIGHT DATA</b>		
Gross Weight (Crated lbs)	606 lbs	606 lbs
Height - Crated	45.5"	45.5"
Width - Crated	62"	62"
Depth - Crated	32"	32"

### Model Views

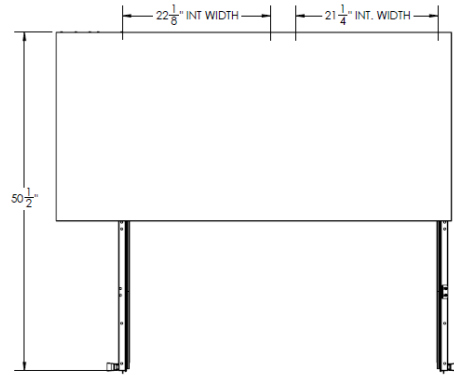

Plan View

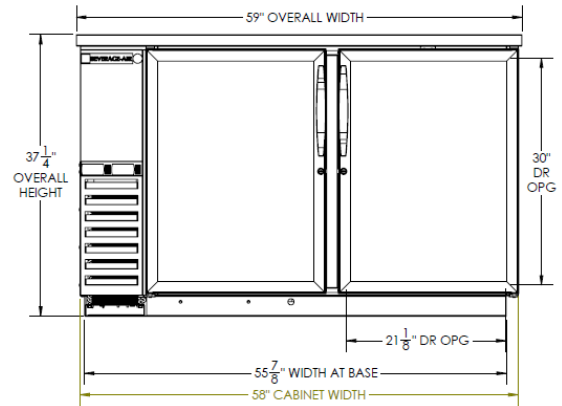

Elevation View

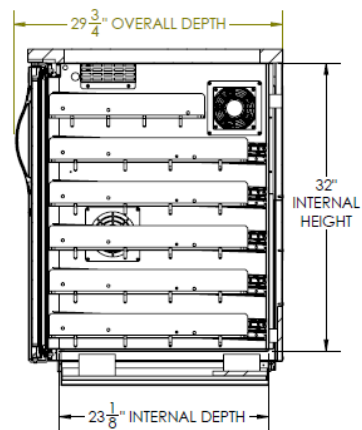

Side View

### ELECTRICAL CONNECTION



115/60/1  
NEMA-5-15P

Units pre-wired at factory and include 8' long cord and plug set.



an Ali Group Company



The Spirit of Excellence

3779 Champion Blvd., Winston-Salem, NC 27105  
1-888-845-9800 Fax: 1-336-245-6453  
Beverage-Air.com sales@bevair.com