



# BEVERAGE-AIR

Project: _____	AIA#
Item: _____	
Location: _____	SIS#
Approved: _____	

## DZ BAR EQUIPMENT-DUAL ZONE

### DZ58G Dual-Zone Glass Doors

**MODEL:**  
**DZ58G-1-B**  
**DZ58G-1-S**



**DZ58G-1-B**



**DZ58G-1-S**

**3 Year Parts/Labor Warranty**  
**Additional 2 Year Compressor Warranty**

### CABINET CONSTRUCTION

- Black or stainless steel exterior & interior finishes available
- Stainless steel top
- Full electronic control
- Dual-zone models feature 2 independent compartments that allow independent temperature in each section
- Left hand compartment maintains 32°-40°F, Right hand maintains 50°-65°F.
- Unit has a minimum variance of 15°+/-15°F, and maximum of 20°F depending on condition
- Door locks
- LED lighting, standard
- Magnetic gasket provides positive door sealing
- Self-closing doors
- Two(2) heavy-duty epoxy coated shelves per section

### OPTIONS & ACCESSORIES

- Sub-top model available
- Solid door models
- Pull-out keg and wine drawer models
- Tap Locks
- 1-4 Tap insulated stainless towers/taps
- Glass rinser
- 3" Casters

### REFRIGERATION SYSTEM

- Refrigeration system uses R134a refrigerant to comply with all environmental concerns
- Automatic, non-electric evaporator
- Epoxy coated evaporator coil

**DZ58G Dual-Zone: Bar Mobile**



3779 Champion Blvd., Winston-Salem, NC 27105  
 1-888-845-9800 Fax: 1-336-245-6453  
 Beverage-Air.com sales@bevair.com



# BEVERAGE-AIR

## Bar Equipment - Dual-Zone

Models: DZ58G-1-B, DZ58G-1-S

MODEL	DZ58G-1-B	DZ58G-1-S
<b>EXTERNAL DIMENSIONAL DATA</b>		
Width Overall	59"	59"
Depth Overall with Handle	29 3/4"	29 3/4"
Height Overall	37 1/4"	37 1/4"
Door Opening	21 1/8" x 30" (2)	21 1/8" x 30" (2)
Depth with Door Open 90°	50 1/2"	50 1/2"
Number of Doors	2	2
<b>INTERNAL DIMENSIONAL DATA</b>		
NET Capacity (cubic ft.)	20.354	20.354
Internal Width Overall (in)	(L) 22 1/8" (R) 21 1/4"	(L) 22 1/8" (R) 21 1/4"
Internal Depth Overall (in)	23 1/8"	23 1/8"
Internal Height Overall (in)	32"	32"
Number of Shelves	4	4
Number of Kegs Per Section (1/6)	4	4
<b>ELECTRICAL DATA</b>		
Full Load Amperes 115/60/1	7.4	7.4
<b>REFRIGERATION DATA</b>		
Horsepower	3/4	3/4
<b>WEIGHT DATA</b>		
Gross Weight (Crated lbs)	548 lbs	548 lbs
Height - Crated	45 1/2"	45 1/2"
Width - Crated	62"	62"
Depth - Crated	32"	32"

### Model Views

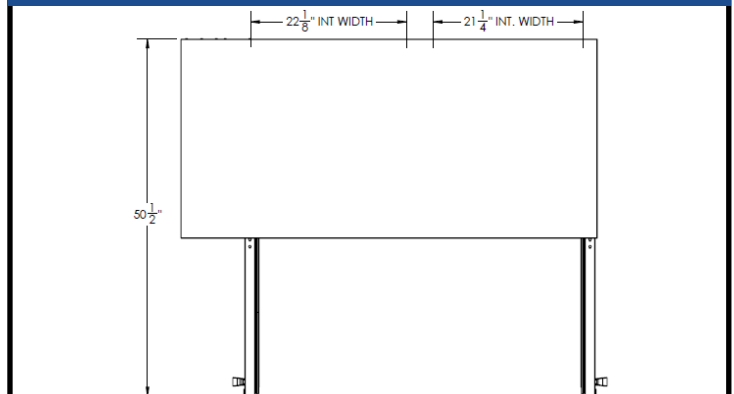

Plan View

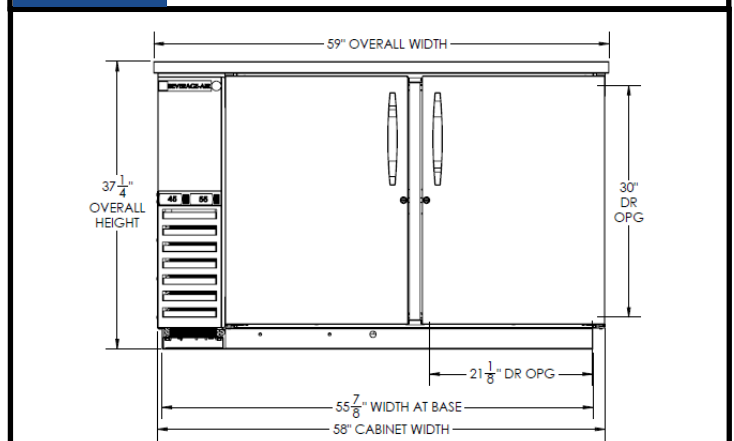

Elevation View

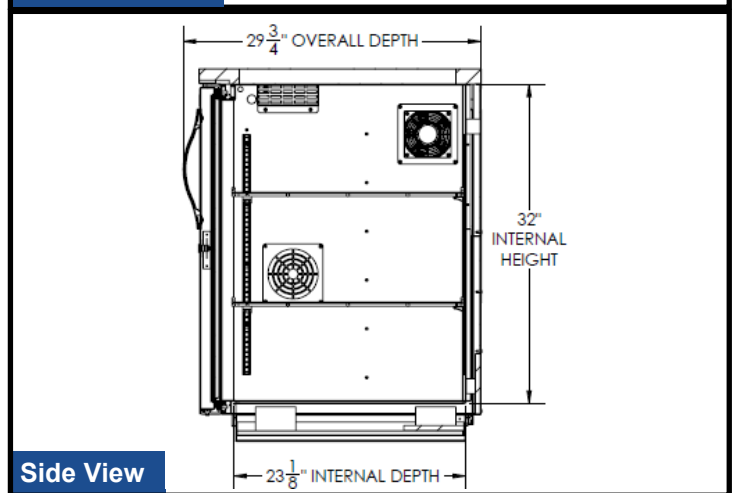

Side View

### ELECTRICAL CONNECTION



115/60/1  
NEMA-5-15P

Units pre-wired at factory and include 8' long cord and plug set.



an Ali Group Company



The Spirit of Excellence

3779 Champion Blvd., Winston-Salem, NC 27105  
1-888-845-9800 Fax: 1-336-245-6453  
Beverage-Air.com sales@bevair.com