



2.6 Gallon Hot Beverage Dispenser

ITEM NUMBER

#177DHC26

SPECIAL FEATURES

- Powerful 1000W heating capability for quick start up and reaction time to temperature adjustments
- Adjustable faucet for different thicknesses to dispense anything from melted butter to pancake syrup
- Easy-to-read thermostat allows user to set desired temperature
- Large 2.6 gallon (10 liter) storage capacity so you don't run out
- Rotating paddles slowly blend product for optimal consistency

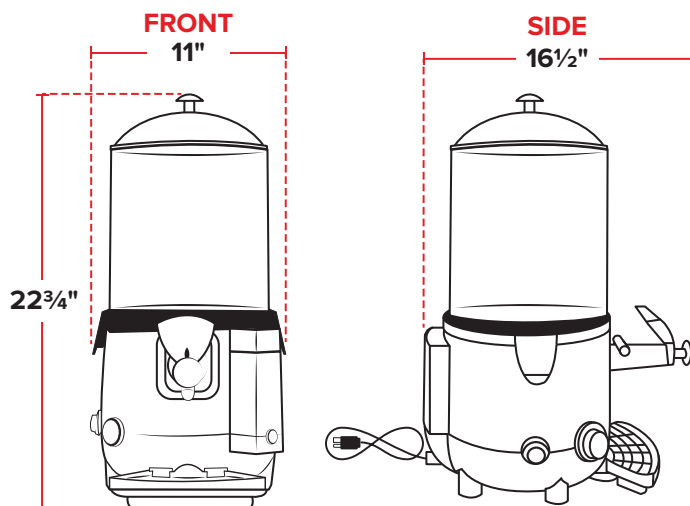

TECHNICAL DATA

| | |
|-------------|--|
| Dimensions | 11" x 16" x 22 ³ / ₄ " |
| Capacity | 2.6 Gallons |
| Brewer Type | Hot Beverage/Topping Dispenser |
| Voltage | 120V |
| Wattage | 1000W |
| Hertz | 60 |
| Amps | 8.3 |

