



STAINLESS STEEL

CHEMICAL STORAGE CABINET



WCH-15-24 Left Hinged
Shown (Standard)*

FEATURES:

Overall Size: 15" x 24" x 32 1/2"
Left-Hinged Door*
Vented Side Panels
One Fixed Mid-Shelf
Wall Mounting Hardware Not Included

CONSTRUCTION:

All TIG welded using the TIG process.
Welded seams finished to match adjacent surfaces.
Unit polished to a satin finish.



Vented
Side Panels

Item #: _____ Qty #: _____

Model #: _____

Project #: _____

MATERIAL:

WCH-15-24:

18 gauge type 430 series stainless steel

WCH-15-24-300:

18 gauge type 300 series stainless steel

Stainless steel hinge

Plastic Handle

Mounting hardware is not supplied

Model #	Material	Approx. Wt.	Approx. Cu.
WCH-15-24	18 Ga., 430 S/S	90	12
WCH-15-24-300	18 Ga., 300 S/S	90	12

*Optional Right-Hand Door Swing Available - Add CAB-R

Additional Fixed Mid-Shelf - Add WC-SHELF

DIMENSIONS and SPECIFICATIONS

TOL ± .500"

ALL DIMENSIONS ARE TYPICAL

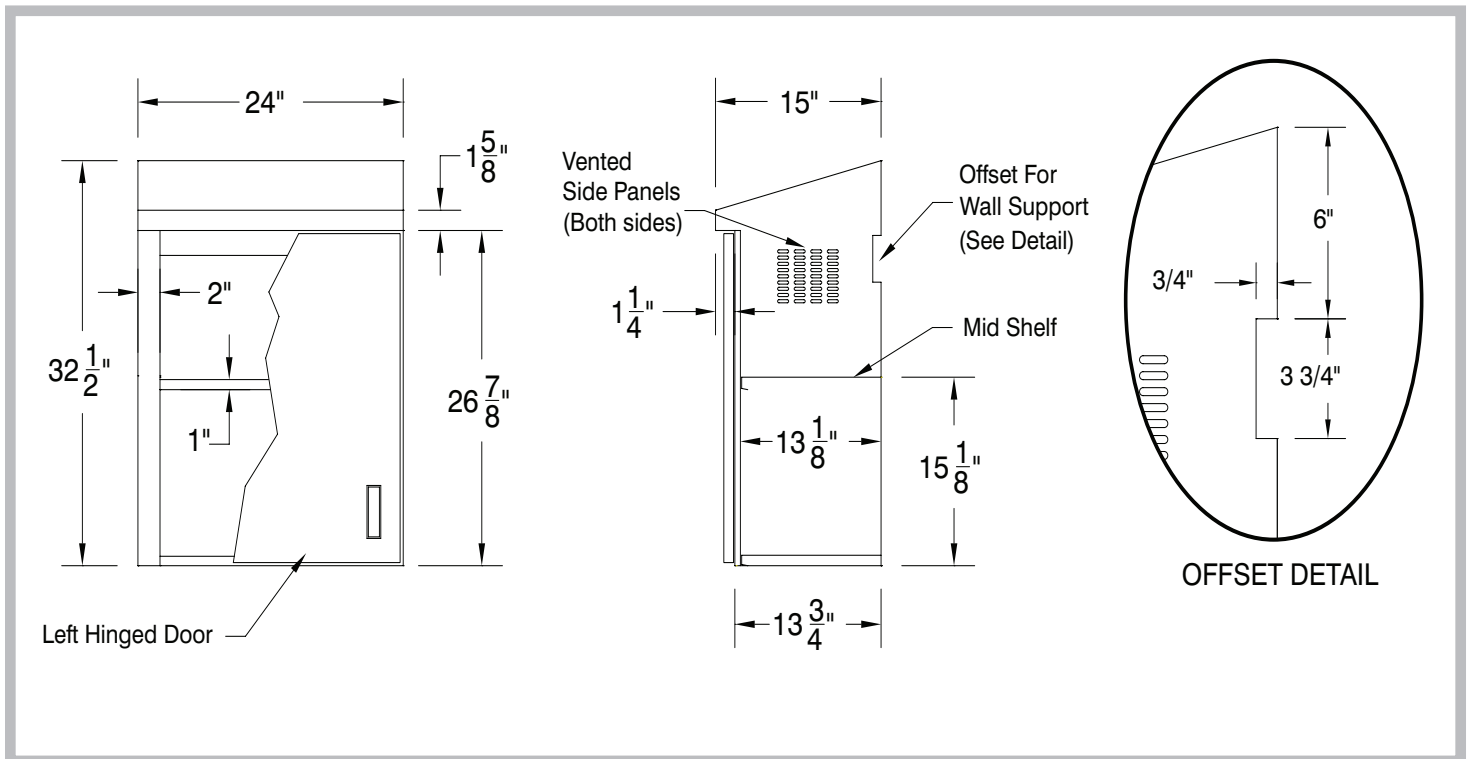

Customer Service Available To Assist You 1-800-645-3166 8:30 am - 8:00 pm E.S.T.

For Orders & Customer Service:

Email: customer@advancetabco.com or Fax: 631-242-6900

For Smart Fabrication™ Quotes:

Email: smartfab@advancetabco.com or Fax: 631-586-2933