



# ROLL UP COVER FOR HOT TABLES



Item #: \_\_\_\_\_ Qty #: \_\_\_\_\_  
 Model #: \_\_\_\_\_  
 Project #: \_\_\_\_\_

## FEATURES:

Fits Advance Tabco Hot Well Units  
 All Stainless Steel  
 Handle for easy opening  
 Removable for easy cleaning

## MATERIAL:

18 Ga. Stainless Steel

Model #	Length (L)	A	Fits # of Compartments	Wt.	Cu. Ft.
RC-2	31-13/16"	30 3/8"	2	12 lbs.	3
RC-3	47-1/8"	45 11/16"	3	16 lbs.	4
RC-4	62-7/16"	61"	4	20 lbs.	5
RC-5	77-3/4"	76 5/16"	5	24 lbs.	6

## DETAILS and SPECIFICATIONS

TOL Overall:  $\pm .500"$  Interior:  $\pm .250"$

ALL DIMENSIONS ARE TYPICAL

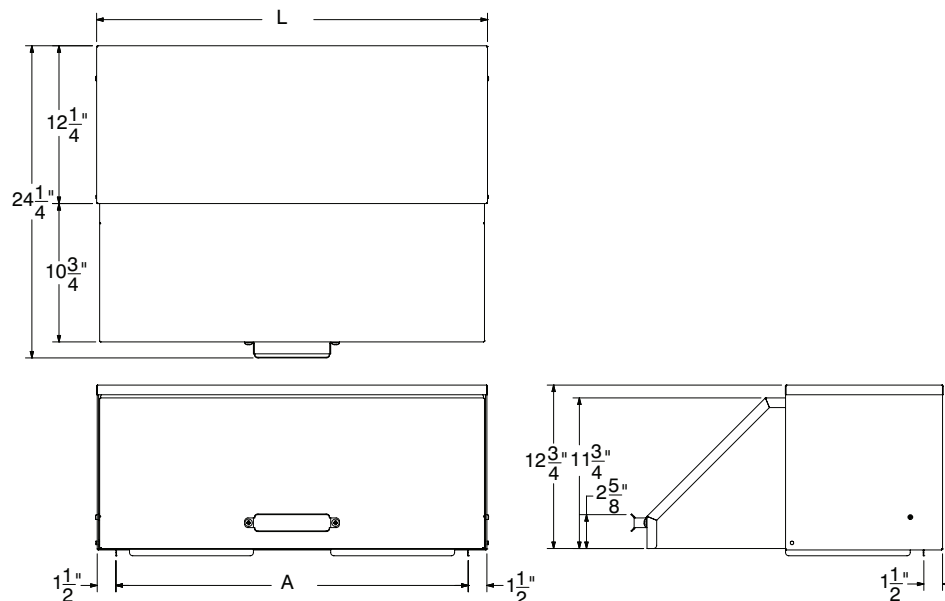

Customer Service Available To Assist You **1-800-645-3166** 8:30 am - 8:00 pm E.S.T.

For Orders & Customer Service:

Email: [customer@advancetabco.com](mailto:customer@advancetabco.com) or Fax: 631-242-6900

For Smart Fabrication™ Quotes:

Email: [smartfab@advancetabco.com](mailto:smartfab@advancetabco.com) or Fax: 631-586-2933