

### V3-203-1 Pre-Installation Customer Checklist

Below are the services required to be in place prior to the installation of the Vivreau system.  
If you have any questions regarding these services, please call our service line 877-999-1044.

#### WATER SUPPLY

**1 potable ½" cold water supply terminating in a ½" ball valve, ½" female pipe thread** (ball valve must be accessible for service and installation). Minimum water pressure 50 PSI and Minimum water flow 80 Gallons per hour. \*The Vivreau system incorporates back flow prevention. Any additional back flow devices required by local or state code must also be supplied by the customer prior to installation. There should not be any other filters/pre-filters before the Vivreau system.

#### ELECTRICAL OUTLET

**(1) 15amp electrical receptacle (5-15 R) 120v, 60 Hz** (Electrical run current 7 amps)

#### Drip Tray and Cobra

**Cut out for Drip Tray and Cobra as per attached template.**

\*The taps must be mounted on the work surface directly above the main system.

#### DRIP TRAY DRAIN

**Drip tray must be plumbed to waste.** Customer will need to supply a vertical trapped receptacle according to state and local codes. The receptacle must be at least 1 ¼" ID.

#### VENTILATION

If the system is to be installed in an enclosed space or cabinet, adequate ventilation must be provided (failure to provide ventilation will cause system failure).

#### Location of Services (all services must be accessible for installation and service)

**Please ensure all services are kept within 40" of bottling system.**

Water shut-off valve to be located at low level. Please ensure that there is sufficient room for a 12" inch long fitting to be connected to the shut-off valve.

Top of waste receptacle should be located between 12" and 18" Inches from ground level.

**Customer Acknowledgement:** Please check the appropriate boxes below.

The following REQUIRED services are available as per the above and the Vivreau system specifications:

**Water Supply**..... Yes ☐  
**Electric**..... Yes ☐  
**Drip Tray Drain**..... Yes ☐  
**Ventilation**..... Yes ☐  
**Cuts for Drip Tray and Cobra**.....Yes ☐

**Insurance** Do you require a certificate of insurance?

Yes ☐ If yes please include requirements

#### **Mandatory Installation Site Photos:**

In order to confirm your installing technician appointment,  
please email photos of the installation site and all services  
to your fulfillment coordinator.

**Delivery** Standard Delivery is to your loading dock by a freight carrier.

#### **Additional Delivery Services:**

☐ **Lift Gate Service**(no loading dock) **\$175**  
☐ **Inside Delivery** (delivery indoors to your floor/suite) **\$150**

The checked off services are ready and available for installation. I acknowledge that if any of these services are not available and the installation is scheduled Vivreau may charge us for a service call.

\_\_\_\_\_  
Name

\_\_\_\_\_  
Title

\_\_\_\_\_  
Signature

\_\_\_\_\_  
Date

\_\_\_\_\_  
Location Name

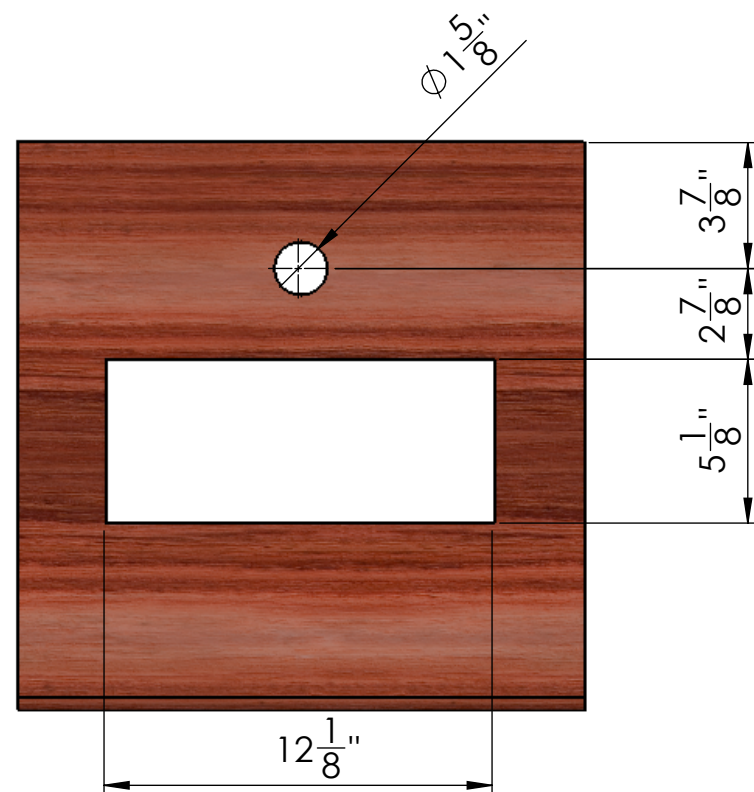
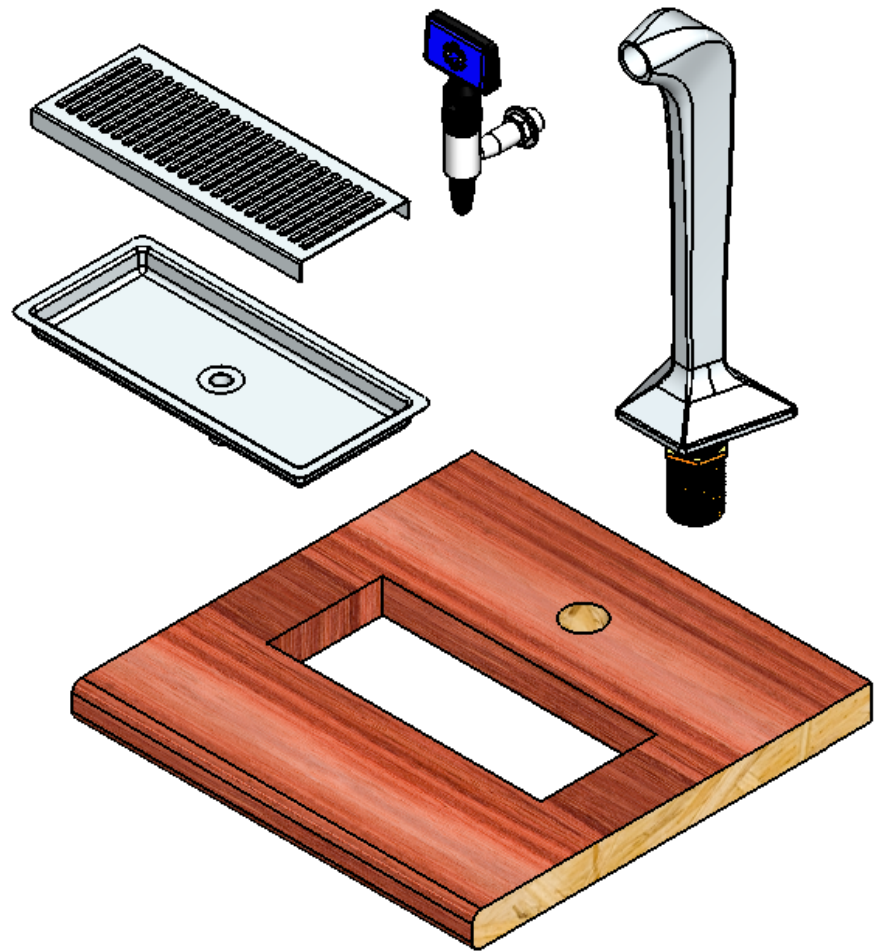

Worktop Cutout Detail

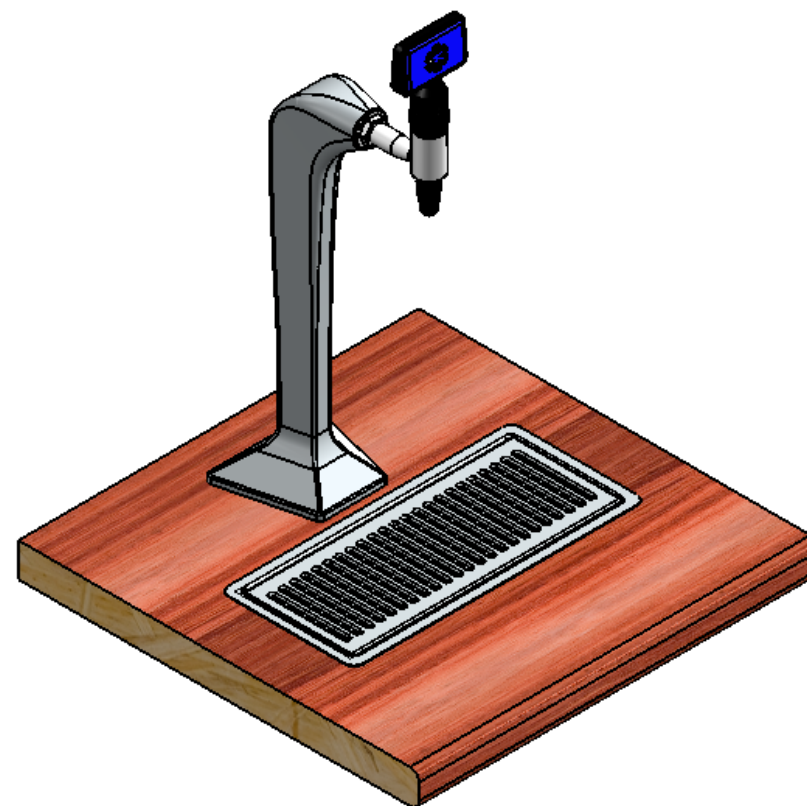
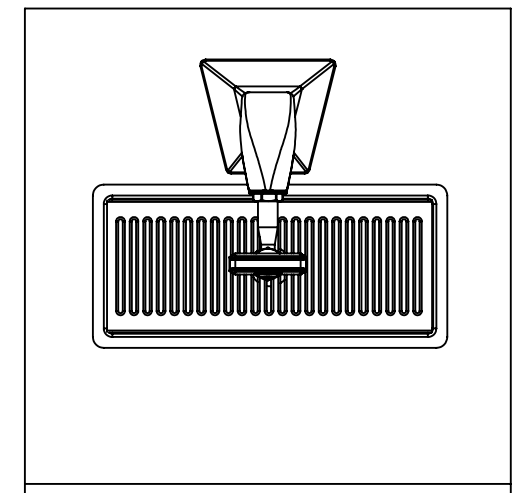
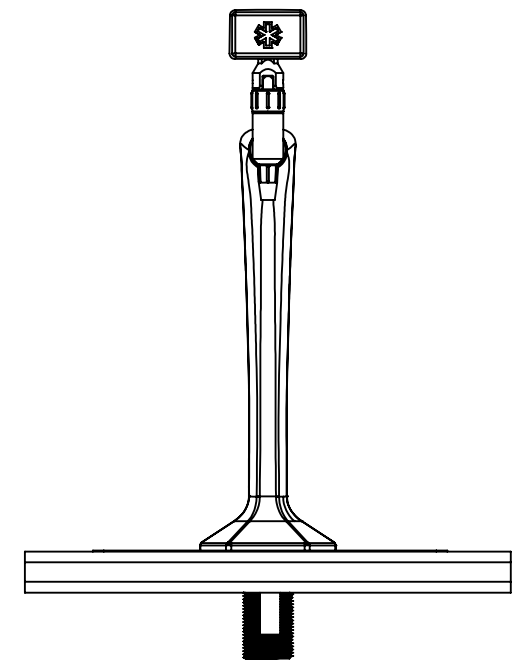
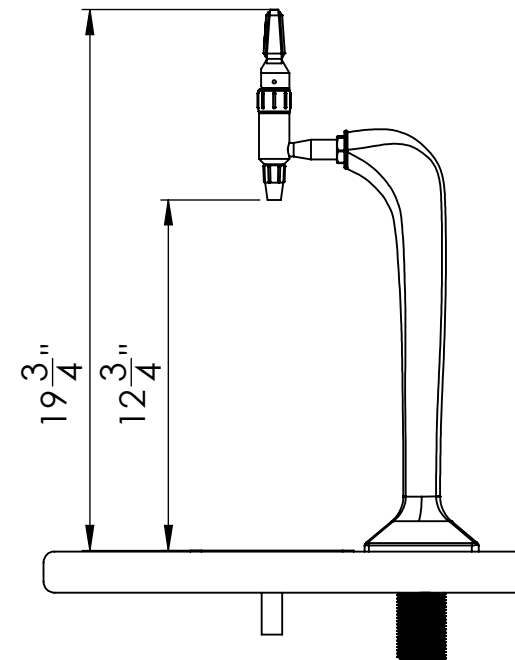

NOT TO SCALE

<b>Vivreau Limited</b> Unit 44 Metropolitan Park, Norwich Rd. Greenford, Middlesex. UB6 8UB				UNLESS OTHERWISE SPECIFIED: DIMENSIONS ARE IN MILLIMETERS SURFACE FINISH: TOLERANCES:		<b>VIVREAU</b>	
Tel: 0845 6749655 <a href="http://www.vivreau.com">www.vivreau.com</a>				DRAWN RJ 22.06.16 CHK'D APPROVAL STANDARD		TITLE: Single Cobra/Recessed Tray	
FINISH: MATERIAL:				DWG NO. <b>SCT- US.04</b>		REVISION	
MODIFICATION NAME DATE				WEIGHT: SCALE:1:10		DO NOT SCALE DRAWING	

This Drawing is COPYRIGHT and is the sole property of VIVREAU Limited. It shall not be copied or reproduced in any retrievable form without the written permission of VIVREAU Limited C 2015 VIVREAU Limited

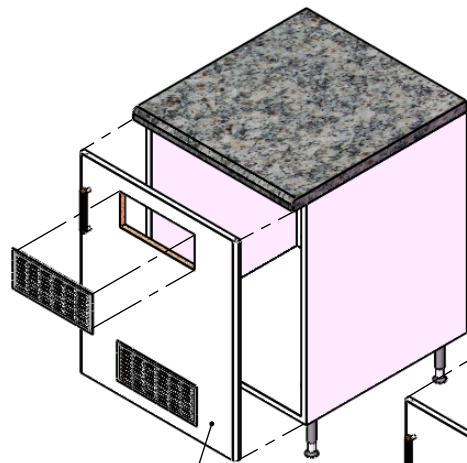

1). Front Ventilation  
Showing Ventilation grilles  
cut in a standard door panel

2). Side Ventilation  
Ventilation grilles cut in the side  
of a standard cabinet. The grilles  
may be fitted on either side **provided they  
ventilate into a free and unobstructed area**

3). Base Ventilation  
Ventilation grilles cut in the cabinet's  
base panel and base plinth. Top ventilation  
will also be required in either the side panels  
or a cut-out in the top of the door.

4). Base Cutout  
Ventilation can be made to the base of the  
cabinet, with the removal of a narrow section  
of floor, immediately behind the door and trim  
with roll edging strip. Typical cut-out size must  
not be less than 11.0" wide x 1.5" deep

Available VIVREAU Grill

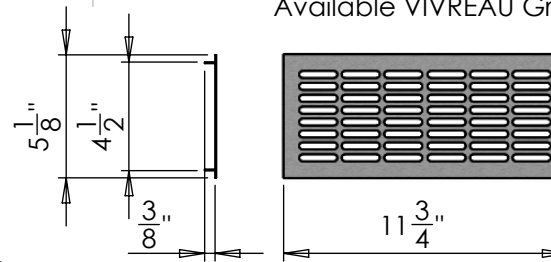

**PLEASE NOTE**  
All vents must open to  
fresh air in a free and  
unobstructed area.

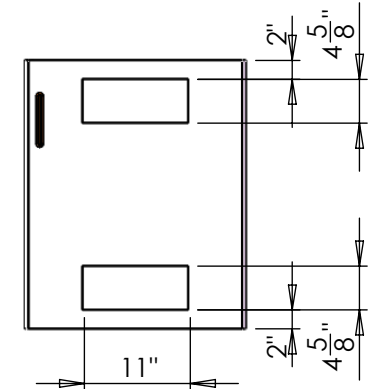

Cut-out detail for the available 12"  
VIVREAU grill, shown in a door

**24 Square inches of  
opening is required  
for both the top  
and bottom vents**

The cabinet may be ventilated in several different ways to prevent  
excessive heat build-up. the methods shown all take advantage  
of natural circulation by placing two grilles or cut-outs; one near  
the base and the other at the top of the enclosure.

This Drawing is COPYRIGHT © 2013 and is the sole property  
of VIVREAU Limited. It shall not be copied or reproduced in any  
form without the express permission of VIVREAU Limited

DO NOT SCALE DRAWING ALL DIMENSIONS IN INCHES

**VIVREAU**  
North America  
Vivreau North America  
Tel.877 999 1044  
www.vivreau.com

DRAWN/DATE RJ 27.06.2013

MATERIAL:

FINISH:

WEIGHT:

TITLE:

Preferred Methods of  
Cabinet Ventilation

DWG NO.

Viv066 .01

REVISION

SCALE:1:50

A4

SHEET 1 OF 1

Name:

Modification