

## ALUMINUM SWINGING TRAFFIC DOORS WITH BUILT-IN WINDOWS



### SINGLE DOOR

600TD3084

600TD3684

### DOUBLE DOOR

600TD6084

600TD7284

## EASY TO INSTALL

Top and bottom hinge assemblies and all necessary mounting hardware for top and bottom mounting is included for convenient installation. **Measurements indicated refer to the door opening and not the size of the actual door.** Improper installation voids all warranty.

## PRIOR TO INSTALLATION

- Ensure your doorway jamb & lintel are at least 4½" wide, square, and plumb.
- Verify your construction is at least double 2" x 4" or equivalent. Hollow metal jambs should be reinforced at hinge locations.

**NOTE** Single door can be mounted on either right or left side of door opening.

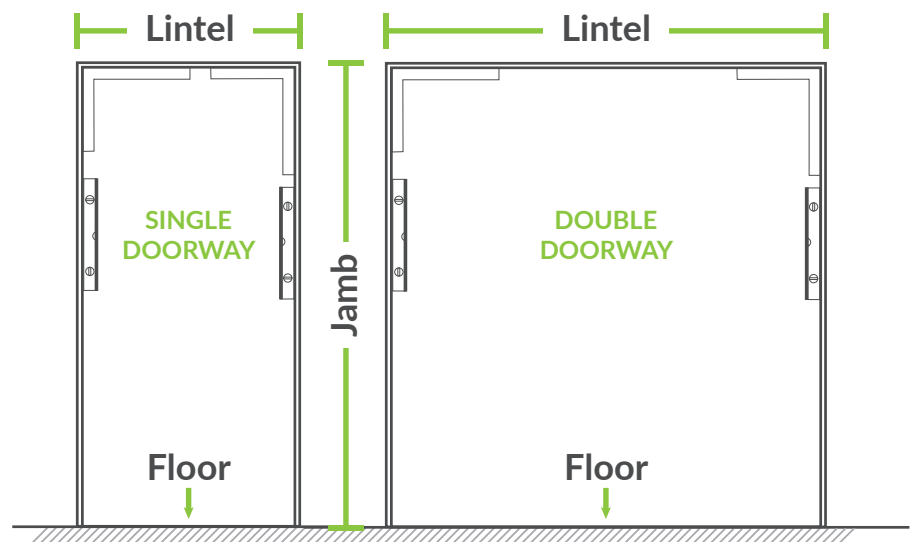

# INSTALLING THE HINGES & DOOR

**DO NOT** TIGHTEN SCREWS OR BOLTS COMPLETELY UNTIL DOOR PANEL IS ALIGNED.

1. Remove the top hinge's side covers.
2. Remove the (2) nuts and bolts from the interior cam plate of the top hinge.
3. Remove the L-bracket from the top hinge.
4. Place L-bracket flush in the top corner.
5. Mark and drill (6) mounting holes.
  - Steel - 7/32" drill bit
  - Wood - 3/16" drill bit
6. Insert (6) large cross head bolts (1/4-20\*1) to mount the top bracket. Ensure the cam is flush.
7. Place the lower hinge pin L-bracket flush in the bottom corner, ensuring the bracket is centered on the door jamb.
8. Mark and drill (4) mounting holes.
9. Insert (2) expansion bolts (3/8-16\*2.25) to mount the bottom bracket to the threshold. Insert (2) medium crosshead bolts (1/4-20\*1) to mount the bottom bracket to the jamb.
10. To position the door, the pin receptacle located at the bottom of the door should line up with the attached pin on the bottom part of the L-bracket.
11. Position the top hinge assembly so it rests on the top of the cam bar.
12. Replace the (2) nuts and bolts (removed in Step 2 above). Adjust the panel front-to-back and side-to-side to reposition the door panel in the opening as desired.
13. Loosen all screws (including set screws) so you can align the bottom hinge saddle and adjust the door panel side-to-side as needed.
14. Tighten all screws and bolts and replace the side covers (removed in Step 1 above).

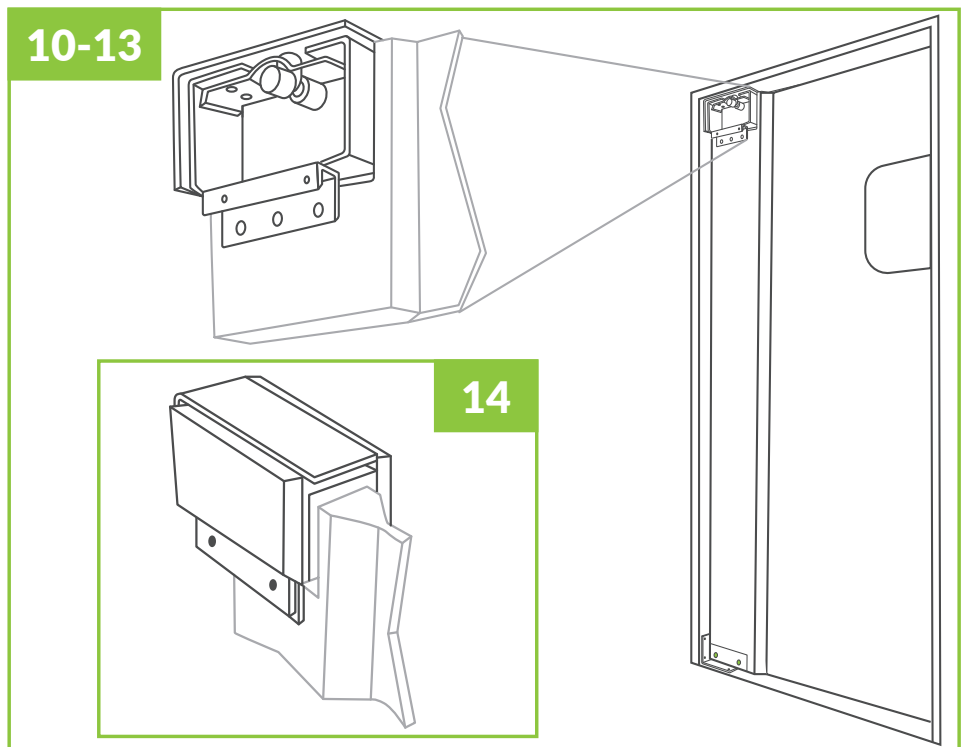
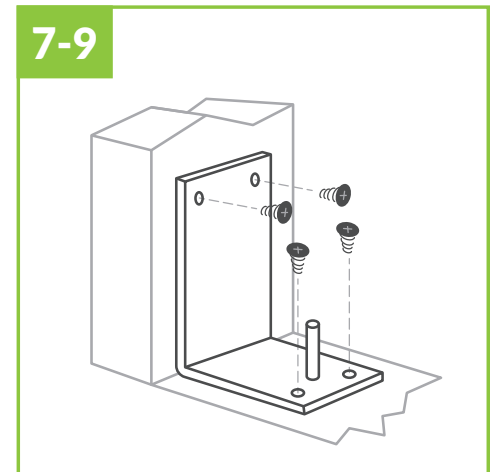
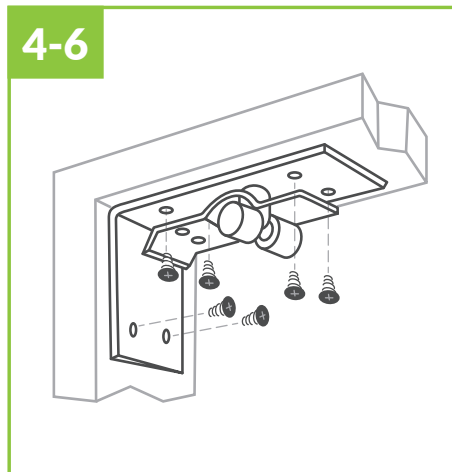
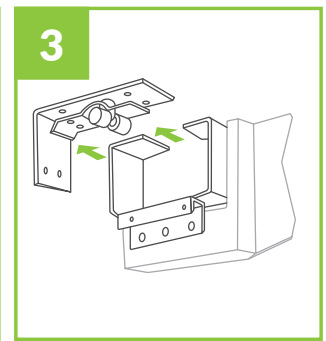
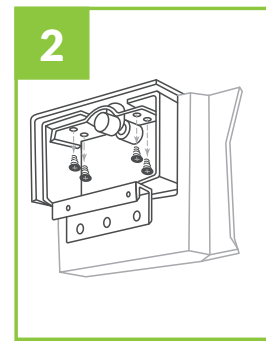
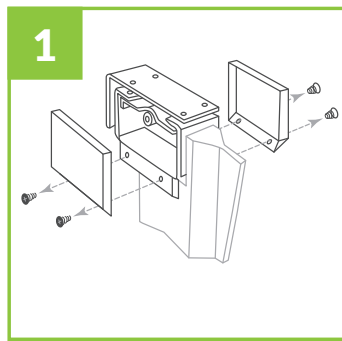

**NOTE** When the door is closed, there is approximately a 7/8" gap between the door and door jamb. When the door is opened, there will be approximately a 1 1/4" gap between the door and door jamb on the bottom, and a 3 1/4" gap on the top of the door. This is intentional to help the door's self-close function.