

PART LIST

KEY	QTY	DESCRIPTION	KEY	QTY	DESCRIPTION	KEY	QTY	DESCRIPTION
1	5	Caster	7	1	Backrest	12	2	Arm Bracket
2	1	Base	8	1	Backrest Post	13	2	Armrest
3	1	Seat Post	9	1	Backrest Screw (8x10mm)	14	2	Arm Width Adjustment Knob + Washers
4	1	Seat Post Cover	10	1	M5 Size Allen Wrench			
5	1	Mechanism	11	3	Backrest / Mechanism Bolt (8x20mm) + Washer			
6	1	Seat						

STEP 1.

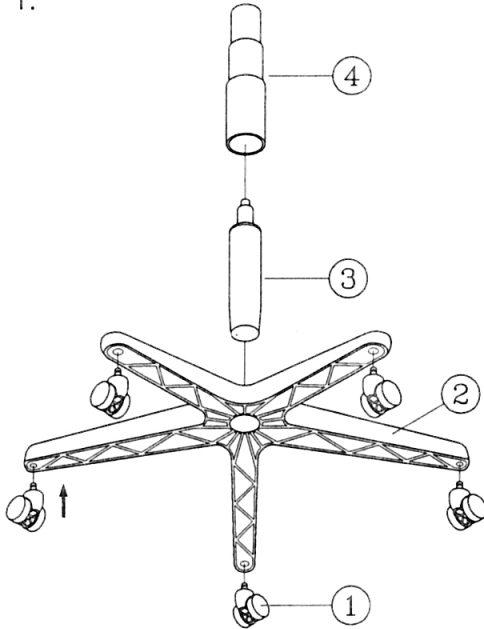

STEP 2.

ATTENTION !!
Place backrest face up to attach backrest post.

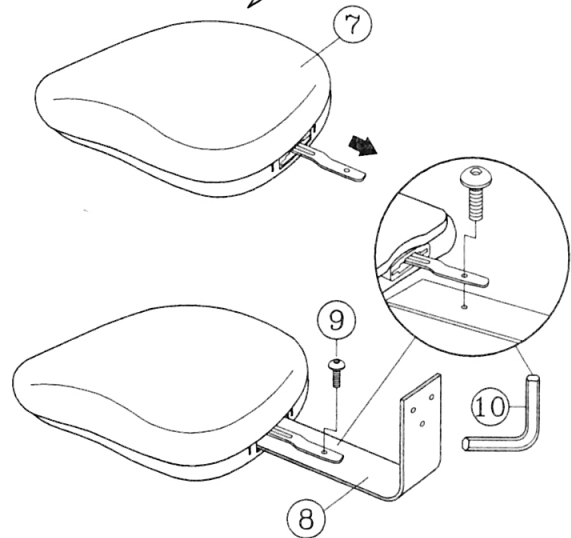

STEP 3.

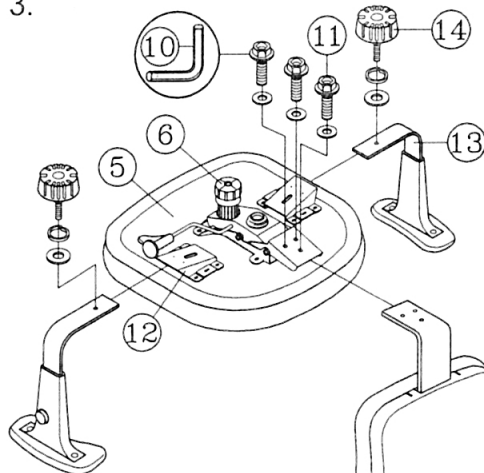

Ratchet Back Height Adjustment

To raise the back, slowly lift the back up until you hear a series of 4 to 5 clicks. Each click represents a position where the back will lock into place. To lower the back, raise the back all the way up until tension is released - the back will then return to the lowest position without stopping. Raise back up to desired position.

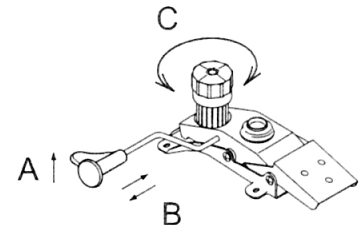

MECHANISM INSTRUCTIONS :

(A) SEAT HEIGHT ADJUSTMENT :

Pull lever up. Move seat upward and downward. Release lever when desired position is reached.

(B) BACK TILT ADJUSTMENT :

Pull lever horizontally. Move backrest to tilt. To lock in upright position, push lever in.

(C) TILT TENSION ADJUSTMENT KNOB :

Rotate knob clockwise/counterclockwise to adjust tilt tension based on body weight.

PREVENTIVE MAINTENANCE AND WARNING!

- USE THIS PRODUCT ONLY FOR SEATING ONE PERSON AT A TIME.
- DO NOT USE THIS CHAIR AS A STEP STOOL / LADDER.
- DO NOT SIT ON ANY PART OF THE CHAIR EXCEPT THE SEAT.
- DO NOT USE CHAIR ON UNEVEN FLOOR SURFACES.
- DO NOT USE CHAIR UNLESS ALL BOLTS, SCREWS AND KNOBS ARE TIGHTENED.
- EVERY SIX MONTHS, PLEASE MAKE SURE ALL BOLTS, SCREWS AND KNOBS ARE FULLY TIGHTENED TO ENSURE STABILITY.
- IF ANY PARTS ARE MISSING, BROKEN, DAMAGED OR WORN, STOP USE OF THE PRODUCT UNTIL REPAIRS ARE MADE USING FACTORY AUTHORIZED PARTS.
- DISPOSE OF PACKAGING PROPERLY. PLASTIC BAG IS NOT A TOY. DO NOT USE PLASTIC BAG AS HEAD COVERING - IT MAY CAUSE SUFFOCATION.
- FAILURE TO FOLLOW THESE WARNINGS COULD RESULT IN SERIOUS INJURY.
- NOTE: SOME SCREWS MAY BE PREASSEMBLED. IF PREASSEMBLED, IGNORE ASSEMBLY INSTRUCTIONS.