

# Assembly Instructions

## Slider® & Posi-Step® Ramps

# LIFT ASSIST

## Field Installation Instructions

### Table of Contents:

Parts List .....	2
Assembly Instructions .....	2-3
Warranty Information .....	4

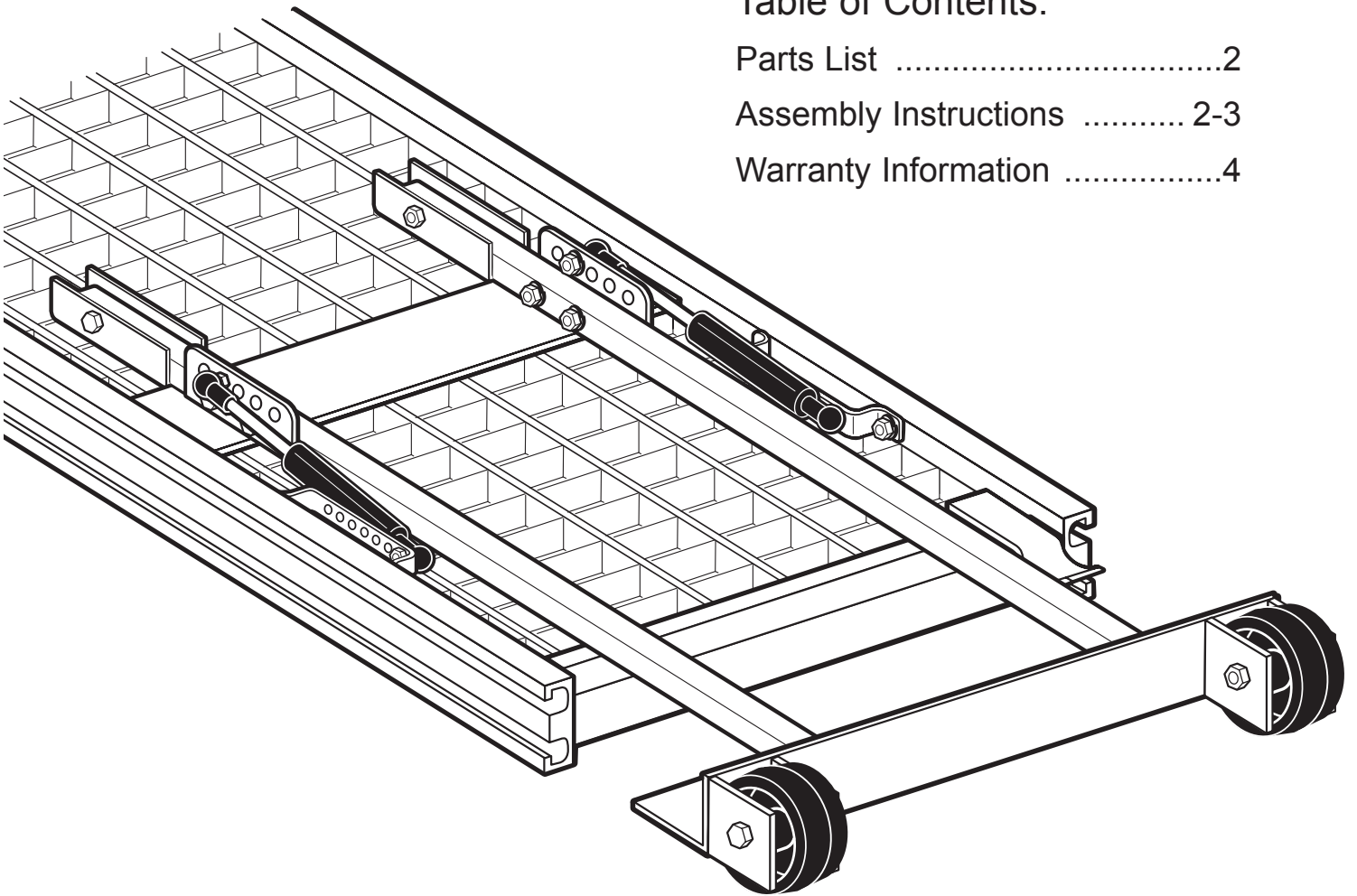

**MAGLINER®**

[www.magliner.com](http://www.magliner.com)

# PARTS LIST

ITEM	DESCRIPTION	QTY.			Catalog #'s	
		2400 & 2600	3200	2400	2600 & 3200	
1	Ramp cylinder bracket	2	4	34151	34152	
2	Carriage cylinder bracket	2	2	34150	34150	
3	Lift cylinder	2	2	34153	34153	
4	Retaining clip	4	4	34155	34155	
5	Ball stud	4	4	34154	34154	
6	Hex head screw - 5/16-18NC x 1" long	4	8	80011	80011	
7	Hex head screw - 5/16-18NC x 1 3/4" long	4	4	80014	80014	
8	Hex nut - 5/16-18NC	12	16	80651	80651	
9	Lock washer - 5/16	12	16	80752	80752	

## TOOLS REQUIRED

- (2) 1/2" WRENCH
- (1) DRILL W/ 11/32" BIT

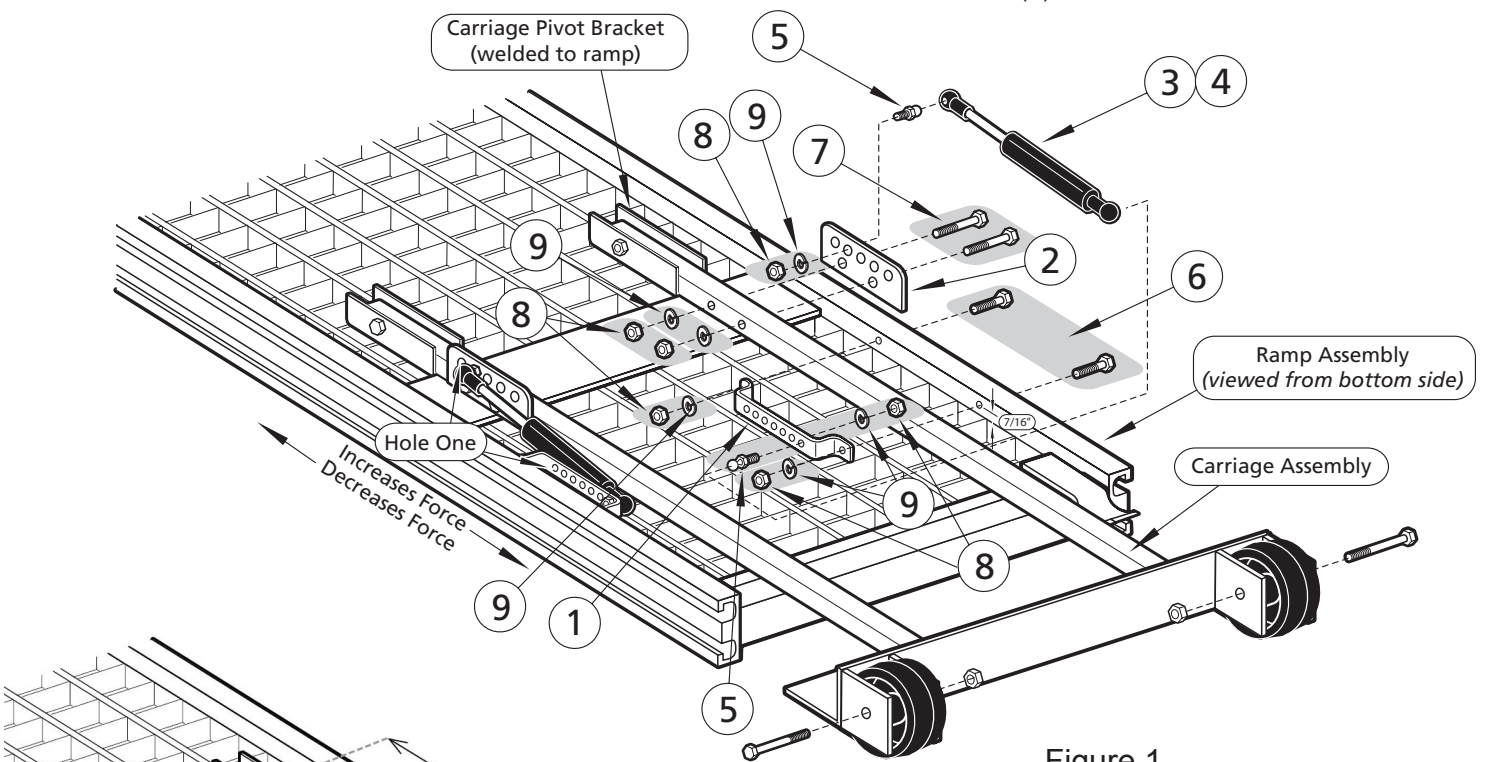

Figure 1

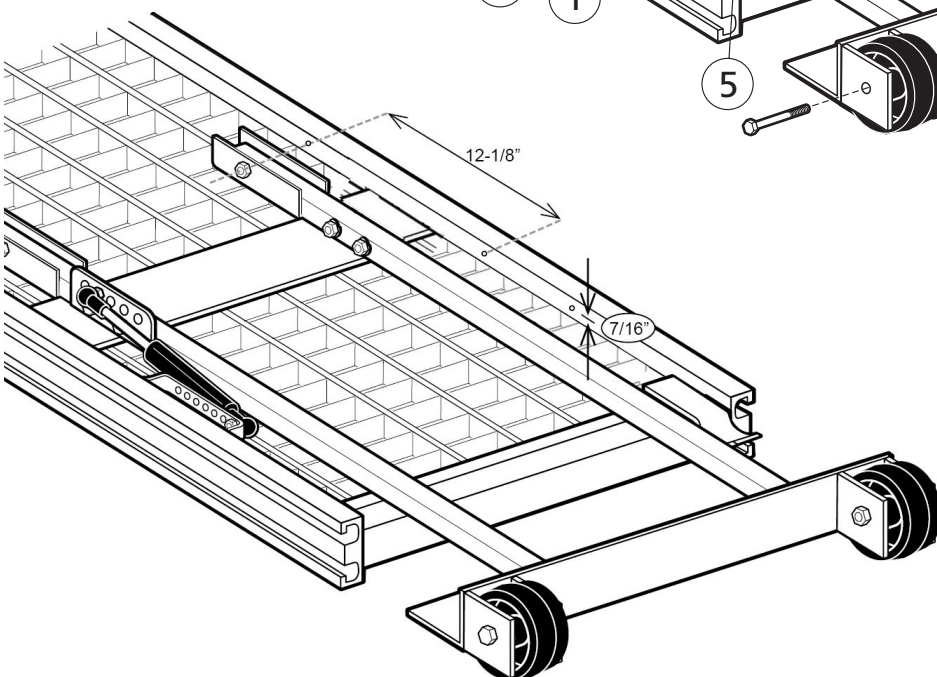

Figure 2

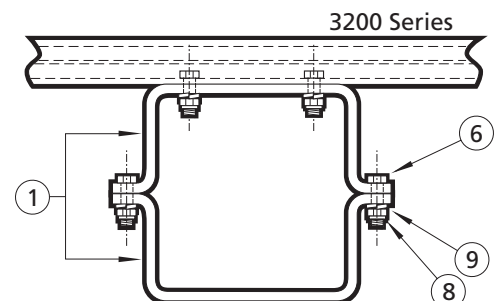

Figure 3

# LIFT ASSIST ASSEMBLY

1. Extend the ramp and remove the three (3) bolts attaching the anti-theft plate stop to the carriage assembly.
2. Remove the ramp and carriage assembly from the vehicle and place on supports (bottom side up) at a suitable working height.
3. Attach the brackets, **(Item 2)**, to the outside of each carriage arm as shown on the installation drawing. Use four (4) each 1 3/4" long screws, lock washers and nuts, (the bolt heads are to be placed against the brackets with the washers and nuts against the tube) and tighten.
4. Locate the ramp bracket, **(Item 1)**, from the center of the pivot bracket holes as shown on the installation drawing (holes are not centered in the bracket height, see 12-1/8" and 7/16" referenced dimensions in Figure 2). Place the bracket against the bottom side of the ramp's deck and drill two (2) 11/32" diameter holes using the bracket as a guide. Repeat this procedure on the other side curb.
5. Attach the ramp brackets, **(Item 1)**, to each curb; use four (4) each 1" long screws, lock washers and nuts. Place the heads of the bolts on the outside of the ramp with the washers and nuts against the brackets and tighten.
6. Attach the four ball studs, **(Item 5)**, with four (4) each lock washers and nuts. Locate the studs in the carriage brackets, **(Item 2)**, in the first hole from the low end for 10 and 12 foot long ramps; in the second hole for 14 foot and the third hole for 16 foot long ramps. Locate the studs in the ramp brackets, **(Item 1)**, in the second hole from the low end for 10 and 12 foot long ramps, in the third hole for 14 foot and the fourth hole for 16 foot long ramps. These are suggested starting locations and may need to be adjusted later.
7. Attach the lift cylinders, **(Item 3)**, to the ball studs on the carriage assembly and insert the wire safety clips into the ball socket of the cylinder. (The rod end of the cylinder attaches to the carriage and the tube end to the ramp).
8. Raise the end of the carriage as required to attach the loose end of the cylinders to the ball studs on the ramp brackets and install the wire safety clips.
9. Place the ramp and carriage assembly back into the vehicle and attach the anti-theft plate removed in step one of these installation instructions.
10. Raise the upper end of the ramp to check the operation of the Lift Assist. If the ramp will not lift high enough or will not stay in place when hooked into the slots of the vehicle, adjustment is necessary. Refer to the lift Assist Adjustment Sheet to insure the proper use and safety of the ramp. NOTE: *Tighten all bolts and nuts to 120-140 inch-lbs.*

## HOW TO ADJUST YOUR MAGLINER LIFT ASSIST MECHANISM

- If the ramp can be raised, but will not stay at the required height, the force may be increased by moving the cylinder attachment studs on both the carriage arm tubes and ramp side curbs forward or to the upper end of the ramp.
- If the ramp wants to rise up when in the hooked position, the force must be decreased as this condition may allow the ramp to disengage from the vehicle during use. Move the cylinder attachment studs on both the carriage arm tubes and ramp side curbs to the rear or low end of the ramp.
- If the ramp can not be raised to the required height, move the cylinder attachment studs on the ramp side curbs toward the rear or low end of the ramp.

### •NOTES•

- (1) If adjustments are necessary, the ball studs should be moved to the next adjoining hole.
- (2) Proper torque on the ball studs is 120-140 inch pounds.

**MAGLINE, INC.**  
1205 W. Cedar Street • Standish, MI 48658 USA  
1-800-MAGLINE (624-5463) • (989) 512-1000 (outside U.S. & Canada)  
**[www.magliner.com](http://www.magliner.com)**