



Garland®

RTCSmp Induction Griddles

Real-time Temperature Control System
multi-point sensing

models

SH GR Countertop Single Griddle

SH DU GR ... Countertop Dual Griddle

SH GR IN Install-Line Single Griddle

For Built-In Dual Griddle Parts List, see Module Line
Griddles and Braising Pans.

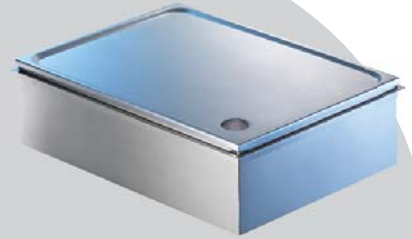

PARTS LIST

International To locate a service
partner in your region, please visit
www.ManitowocFoodService.com

USA & Canada **Parts & Service**

T 1 800 427 6668

F 1 800 361 7745

www.Garland-Group.com

To download the latest Installation & Operation Manuals,
Product Specification Sheets, Parts Lists, and Warranty
documents, please visit www.garland-group.com.

Garland Commercial Ranges, Ltd.
1177 Kamato Road
Mississauga, Ontario L4W 1X4 Canada
www.Garland-Group.com



Rating Plate Location

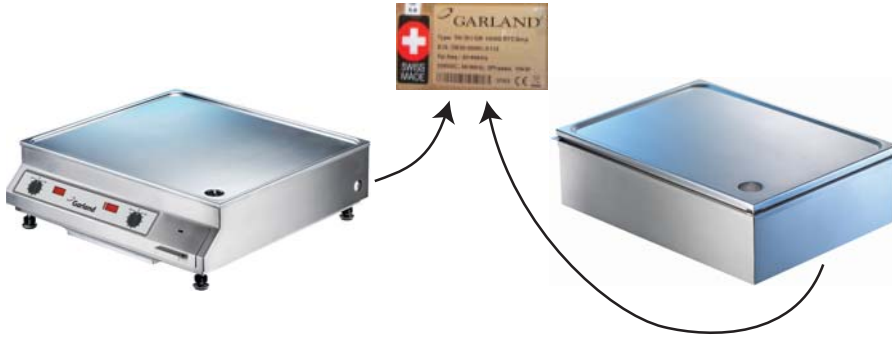

Serial Number (S/N) Explained

The serial number for your unit is listed on the rating plate.

Example: GR 321 . 00014 . 1213

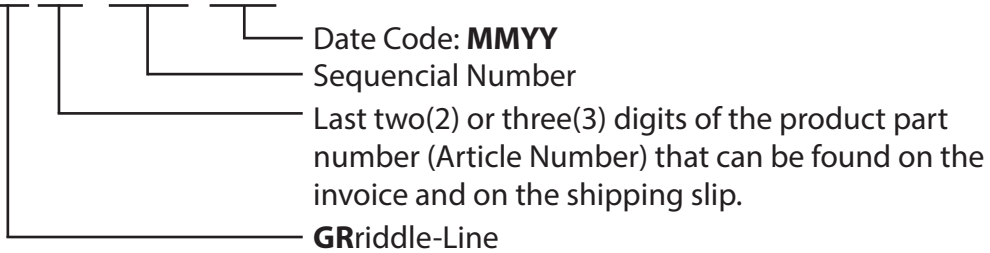

Nomenclature and Models

SERIES	STYLE	FUNCTION	BUILT-IN	POWER (WATT)	MODELS
SH = Slim Hob		GR = Griddle		3500 5000	SH GR 3500 SH GR 5000
	DU = Dual			7000 10000	SH DU GR 7000 SH DU GR 10000
			IN = Built-In Line	3500 5000	SH GR IN 3500 SH GR IN 5000



RTCSmp Induction Griddles

Real-time Temperature Control System multi-point sensing

Table of Contents

<i>Rating Plate Location, Serial Number and Nomenclature Information</i>	2
<i>Counter Top Griddle, Single — 208/230/240V, SH GR 3500, 3.5kW, 50/60Hz, 1Phase</i>	4
<i>Counter Top Griddle, Single — 208/400V, SH GR 5000, 5.0kW, 50/60Hz, 3Phase</i>	6
<i>Counter Top Griddle, Dual — 208/400V, SH DU GR 7000, 7.0kW, 50/60Hz, 3Phase</i>	8
<i>Counter Top Griddle, Dual — 208/400V, SH DU GR 10000, 10.0kW, 50/60Hz, 3Phase</i>	10
<i>Counter Top Griddle, Dual — 220V, SH DU GR 10000, 10.0kW, 50/60Hz, 3Phase</i>	12
<i>Built-In Griddle, Single — 208/230V, SH GR IN 3500, 3.5kW, 50/60Hz, 1Phase</i>	14
<i>Built-In Griddle, Single — 208/400V, SH GR IN 5000, 5.0kW, 50/60Hz, 3Phase</i>	16
<i>Repair Accessories</i>	18
<i>Revision History</i>	19

This parts list is updated regularly. Please find the most current revision on our website @ www.Garland-Group.com

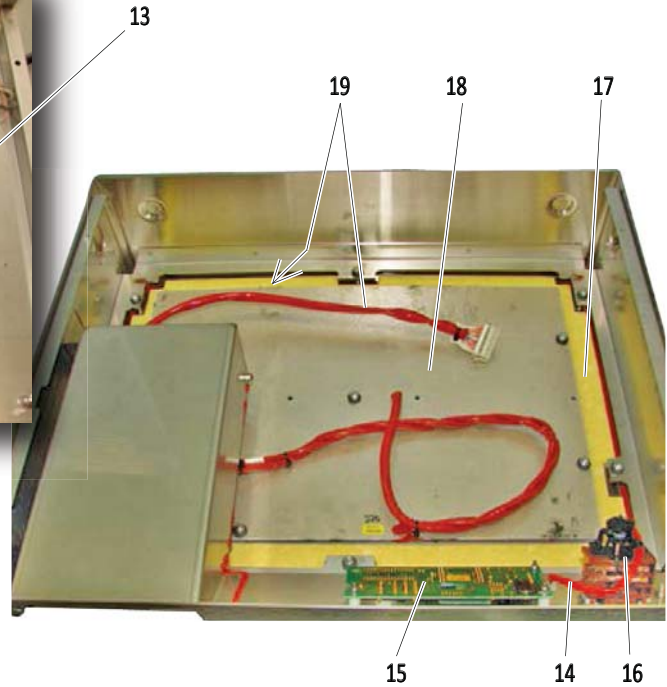
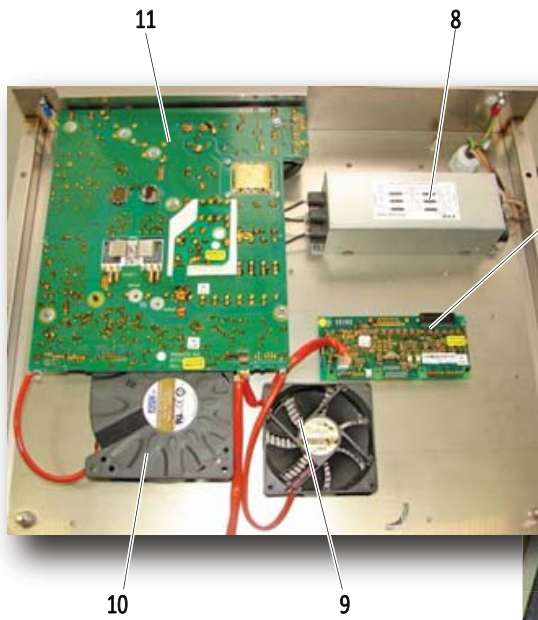
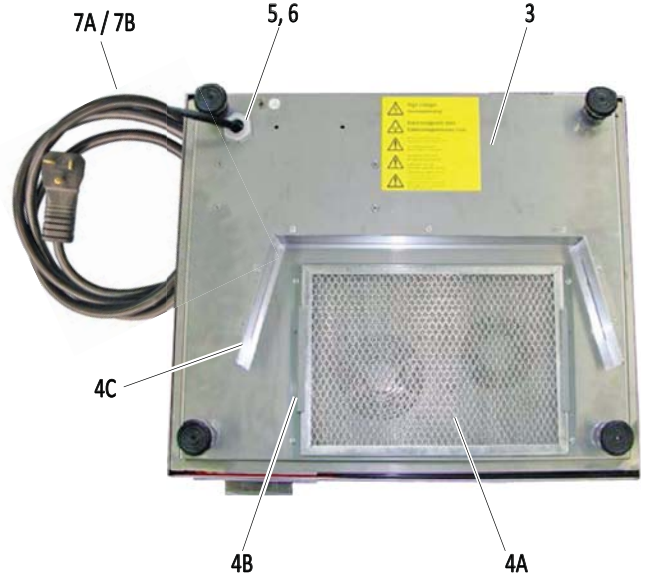
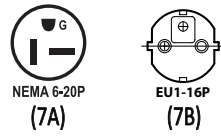

25



26



27



28

GARLAND PARTS IDENTIFICATION
RTCSmp Induction Counter Top Griddle Line, Single, 3.5kW

208V / 230V / 240V models

208V: SH GR 3500/ 3.5kW 16A 60Hz 1Phase/ Article No. 99650021

230V: SH GR 3500/ 3.5kW 15A 50Hz 1Phase/ Article No. 99650022

240V: SH GR 3500/ 3.5kW 14A 60Hz 1Phase/ Article No. 99650023

ITEM	PART#	DESCRIPTION	QUANTITY PER UNIT			CRITICAL
			208V	230V	240V	
1	95000120	Foot Complete Assembly, Adjustable	4	4	4	
3	72144900	Bottom Plate Griddle 1-Zone	1	1		
	72144901	Bottom Plate Griddle 1-Zone			1	
4A	71000012	Grease Filter 280x 200x 12mm	1	1	1	
4B	72261040	Frame for Grease Filter (Plastic)	1	1	1	
4C	72144910	Air Deflector (Plastic)	1	1		
5	39500003	Nut PG16	1	1	1	
6	39500009	Cable Gland PG16	1	1	1	
7A	38614035	Mains Cable USA Type 6-20P	1		1	
7B	38615030	Mains Cable EU with Plug		1		
8	39311603	Mains Line Filter 18A CSA	1		1	
	39311602	Mains Line Filter 16A		1		
9	94090001	Axial Fan 24V DC	1	1	1	C
10	94090011	Radial Fan 24V DC	1	1	1	C
11	98021709	Power Board/Module (3.5kW) Assembly for Griddle	1	1	1	C
13	91133020	RTCSmp Single Cooker Board (Print I133)	1	1	1	
14	94900119	Cable - CAN SH/GR, Single	1	1	1	
15	91145020	(Print) Display Board SH/GR, degree Fahrenheit	1		1	
	91145011	(Print) Display Board SH/GR, degree Celsius		1		
16	94010010	Main Power Switch 2 Pol with Potentiometer	1	1	1	C
17	72291092	Griddle Plate Insulation 1 Zone	1	1	1	
18	93050030	Induction Coil, Griddle, 50.03 Single	1	1	1	
19	94040074	Sensor Unit, Griddle, 12 Pol	1	1	1	C
20	98300043	S/S Housing SH/GR	1	1	1	
21	39400005	Plastic Knob	1	1	1	
22	72144920	Grease Drawer, SH/GR	1	1	1	
23	95000090	Griddle Plate Assembly SH/GR	1	1	1	
24	72146160	Grease Chute, Single & Dual Griddle	1	1	1	
25	72400040	Spatter Protection SH/GR	1	1	1	
26	72205012	Cleaning Pad	1	1	1	
27	72205013	Griddle Spatula	1	1	1	
28	72264020	Tabletop Self Adhesive Non-slip Pads (Pack of 4)	1	1	1	
29	66000007	Garland Overlay/Label - SH/GR	1	1	1	

* NOT ILLUSTRATED

RECOMMENDED STOCK PARTS

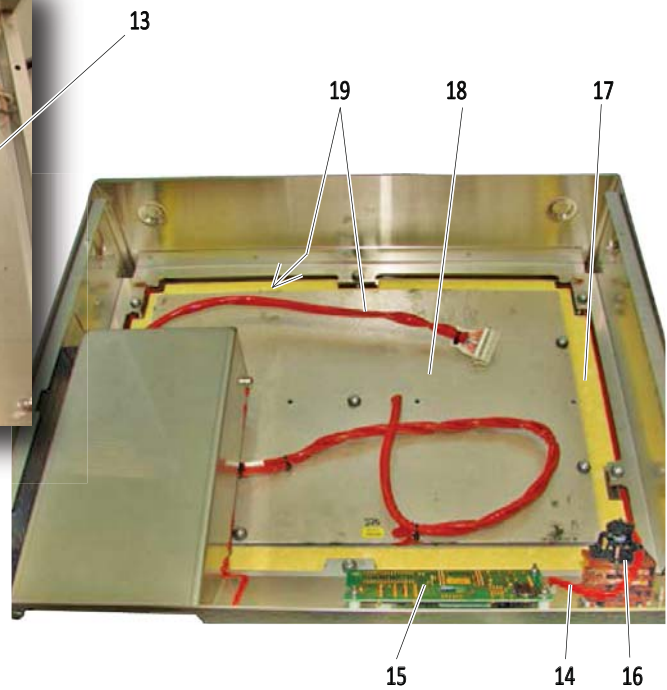
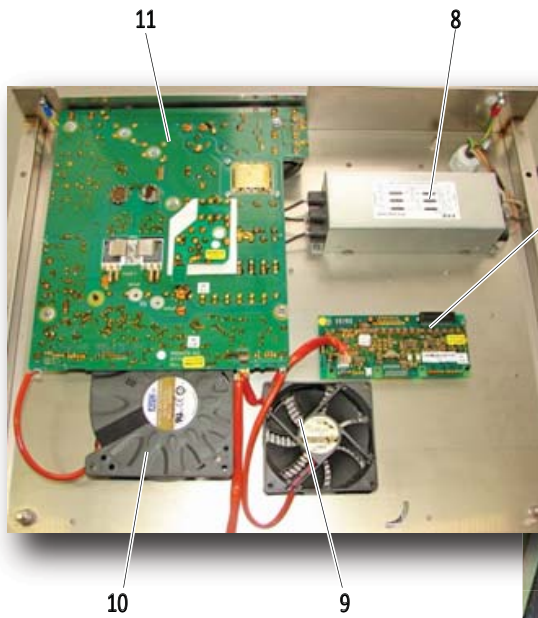
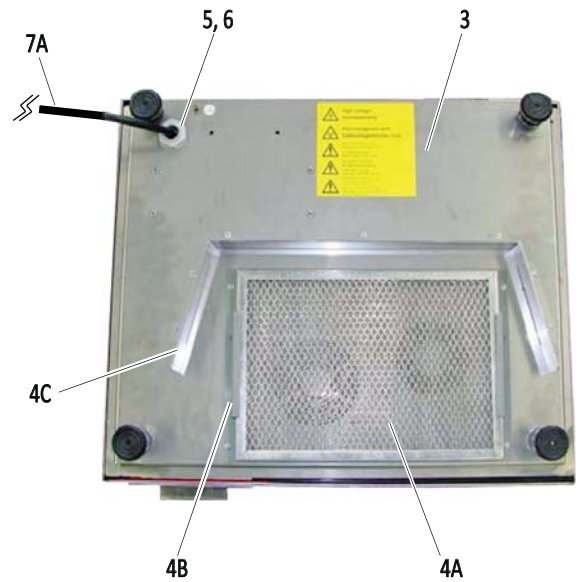
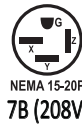

GARLAND PARTS IDENTIFICATION
RTCSmp Induction Counter Top Griddle Line, Single, 5.0kW

208V / 400V models

208V: SH GR 5000/ 5.0kW 14A 60Hz 3Phase/ Article No. 99650024

400V: SH GR 5000/ 5.0kW 8A 50Hz 3Phase/ Article No. 99650025

ITEM	PART#	DESCRIPTION	QTY PER UNIT		CRITICAL
			208V	400V	
1	95000120	Foot Complete Assembly, Adjustable	4	4	
3	72144900	Bottom Plate Griddle 1-Zone	1	1	
4A	71000012	Grease Filter 280x 200x 12mm	1	1	
4B	72261040	Frame for Grease Filter (Plastic)	1	1	
4C	72144910	Air Deflector (Plastic)	1	1	
5	39500003	Nut PG16	1	1	
6	39500009	Cable Connector Nut (Cable Gland PG16)	1	1	
7A	38625042	Mains Cable UL 4 x AWG14 (2.5)	1		
	38615050	Mains Cable VDE 4x 1.5mm2		1	
7B	32750400	Plug, Mains Cable, USA Nema 15-20P	1		
	32750503	Plug, Mains Cable, EU 5-Pole 400V/16A		1	
8	39331602	Mains Line Filter 3x 16A	1		
	39330800	Mains Line Filter 3x 8A		1	
9	94090001	Axial Fan 24V DC	1	1	C
10	94090011	Radial Fan 24V DC	1	1	C
11	98021725	Power Module (5.0kW) Complete Assembly for Griddle 208V	1		C
	98021718	Power Module (5.0kW) Complete Assembly for Griddle 400V		1	C
13	91133020	RTCSmp Single Cooker Board (Print I133)	1	1	
14	94900119	CAN Cable, SH/GR, Single	1	1	
15	91145020	(Print) Display Board SH/GR, degree Fahrenheit	1		
	91145011	(Print) Display Board SH/GR, degree Celsius		1	
16	94010010	Main Power Switch 2 Pol with Potentiometer	1	1	C
17	72291092	Griddle Plate Insulation 1 Zone	1	1	
18	93050030	Induction Coil, Griddle, 50.03 Single	1		
	93051030	Induction Coil, Griddle, 51.03 Single		1	
19	94040074	Sensor Unit, Griddle, 12 Pol	1	1	C
20	98300043	S/S Housing SH/GR	1	1	
21	39400005	Plastic Knob	1	1	
22	72144920	Grease Drawer, SH/GR	1	1	
23	95000090	Griddle Plate Assembly SH/GR	1	1	
24	72146160	Grease Chute, Single & Dual Griddle	1	1	
25	72400040	Spatter Protection SH/GR	1	1	
26	72205012	Cleaning Pad	1	1	
27	72205013	Griddle Spatula	1	1	
28	72264020	Tabletop Self Adhesive Non-slip Pads (pack of 4)	1	1	
29	66000007	Garland Overlay/Label - SH/GR	1	1	

* NOT ILLUSTRATED

RECOMMENDED STOCK PARTS

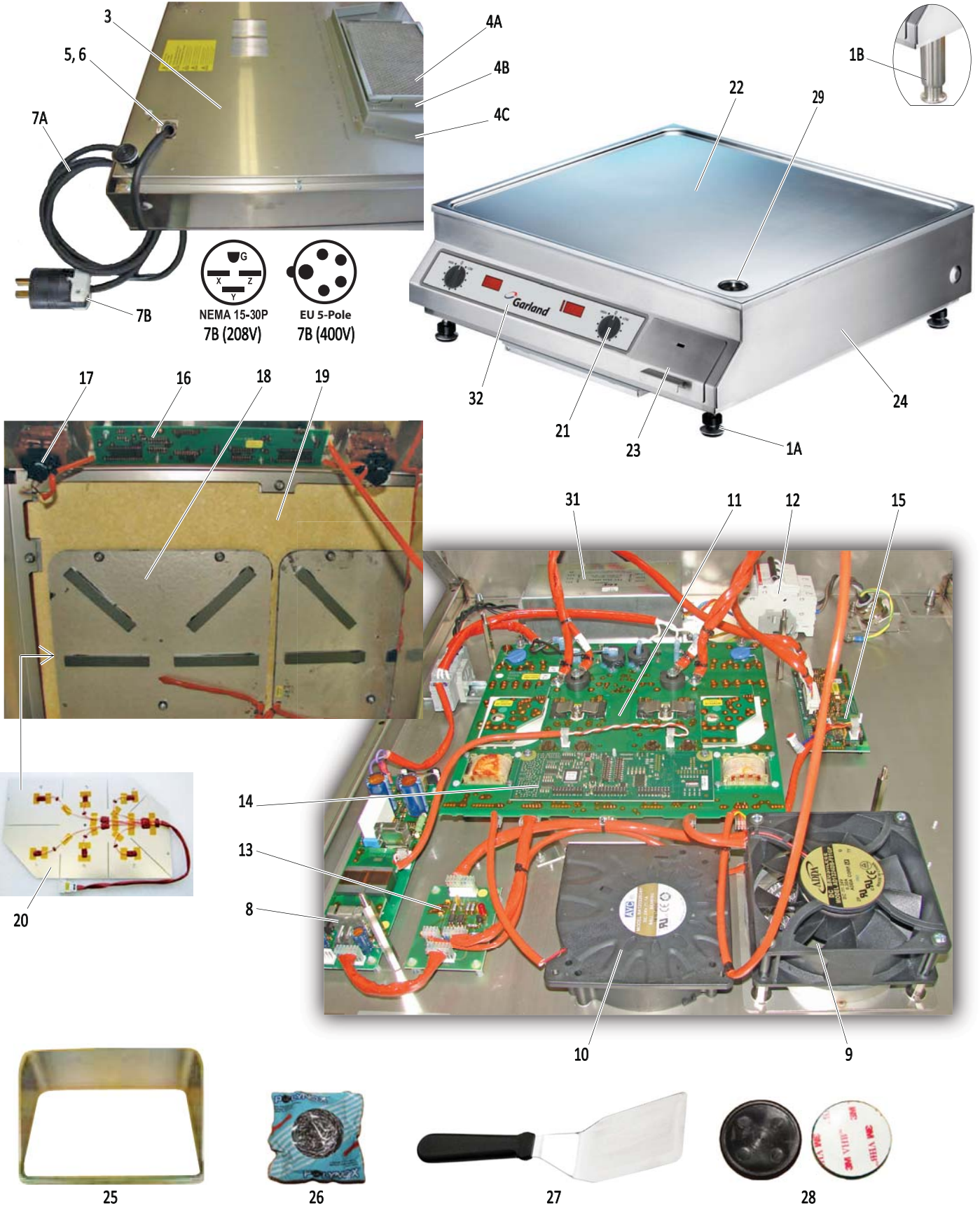

GARLAND PARTS IDENTIFICATION
RTCSmp Induction Counter Top Griddle Line, Dual, 7kW

208V / 400V models

208V: SH DU GR 7000/ 7.0kW 22A 60Hz 3Phase/ Article No. 99650027

400V: SH DU GR 7000/ 7.0kW 11A 50Hz 3Phase/ Article No. 99650028

ITEM	PART#	DESCRIPTION	QUANTITY		CRITICAL
			208V	400V	
1A	95000120	Foot Complete Assembly, Adjustable	4	4	
1B	71000032	S/S Legs, Adjustable, min 5" max 6" (208V N. American Market)	4		
4A	71000012	Grease Filter 280x 200x 12mm	1	1	
4B	72261040	Frame for Grease Filter (Plastic)	1	1	
4C	72144910	Air Deflector (Plastic)	1	1	
	72300830	Air Deflector (Plastic) (208V N. American Market; Use with taller S/S Legs item# 1B)	1		
5	39500004	Nut PG 21	1	1	
6	39500011	Cable Connector Nut (Cable Gland PG21)	1	1	
7A	38324001	Mains Cable UL-CSA TYP SJOOW 4x AWG 10, Black	1		
	38625050	Mains Cable VDE 4 x 2.5mm ²		1	
7B	32750401	Plug, Mains Cable, USA NEMA 15-30P	1		
	32750503	Plug, Mains Cable, EU 5-Pole 400V/16A		1	
8	91120032	AC/DC Board (Print I120b), 208-240V	1		
	91120020	AC/DC Board (Print I120b)		1	
9	94090006	Axial Fan 24V DC, SH/DU/GR	1	1	C
10	94090011	Radial Fan 24V DC	1	1	C
11	98012661	Power Module Complete Assembly, 2x 3.5kW	1		C
	98012610	Power Module Complete Assembly, 2x 3.5kW		1	C
12	34260200	Automatic Circuit Breaker 3 x 20A (400V Units Only)		1	
13	91109012	(Print I109c) Supply & CAN-BUS Interface Board	1	1	C
14	91131220	CPU Print/Board (I131b) for Dual Griddle	1		
	91131010	CPU Print/Board (I131b) for Dual Griddle		1	
15	91133031	RTCSmp Dual Griddle Board (Print I133)	1	1	
16	91150020	(Print) Display Board SH/DU/GR, degree Fahrenheit	1		
	91150011	(Print) Display Board SH/DU/GR, degree Celsius		1	
17	94010010	Main Power Switch 2 Pol with Potentiometer	2	2	C
18	93058070	Induction Coil, Griddle, 58.07 Dual	2		
	93058030	Induction Coil, Griddle, 58.03 Dual		2	
19	72291111	Griddle Plate Insulation 2 Zones	1	1	
20	94040074	Sensor Unit, Griddle, 12 Pol	2	2	C
21	39400005	Plastic Knob	2	2	
22	95000091	Griddle Plate Assembly SH/DU/GR	1	1	
23	72145250	Grease Drawer SH/DU/GR	1	1	
24	98300045	S/S Housing SH/DU/GR	1	1	
25	72400050	Spatter Protection SH/DU/GR	1	1	
26	72205012	Cleaning Pad	1	1	
27	72205013	Griddle Spatula	1	1	
28	72264020	Tabletop Self Adhesive Non-slip Pads (pack of 4)	1	1	
29	72146160	Grease Chute, Single & Dual Griddle	1	1	
31	91168030	Mains Filter 3x 32A, 208V	1		
	91167010	Mains Filter 3x 16A		1	
32	66000008	Garland Overlay/Label - SH/DU/GR	1	1	

* NOT ILLUSTRATED

RECOMMENDED STOCK PARTS

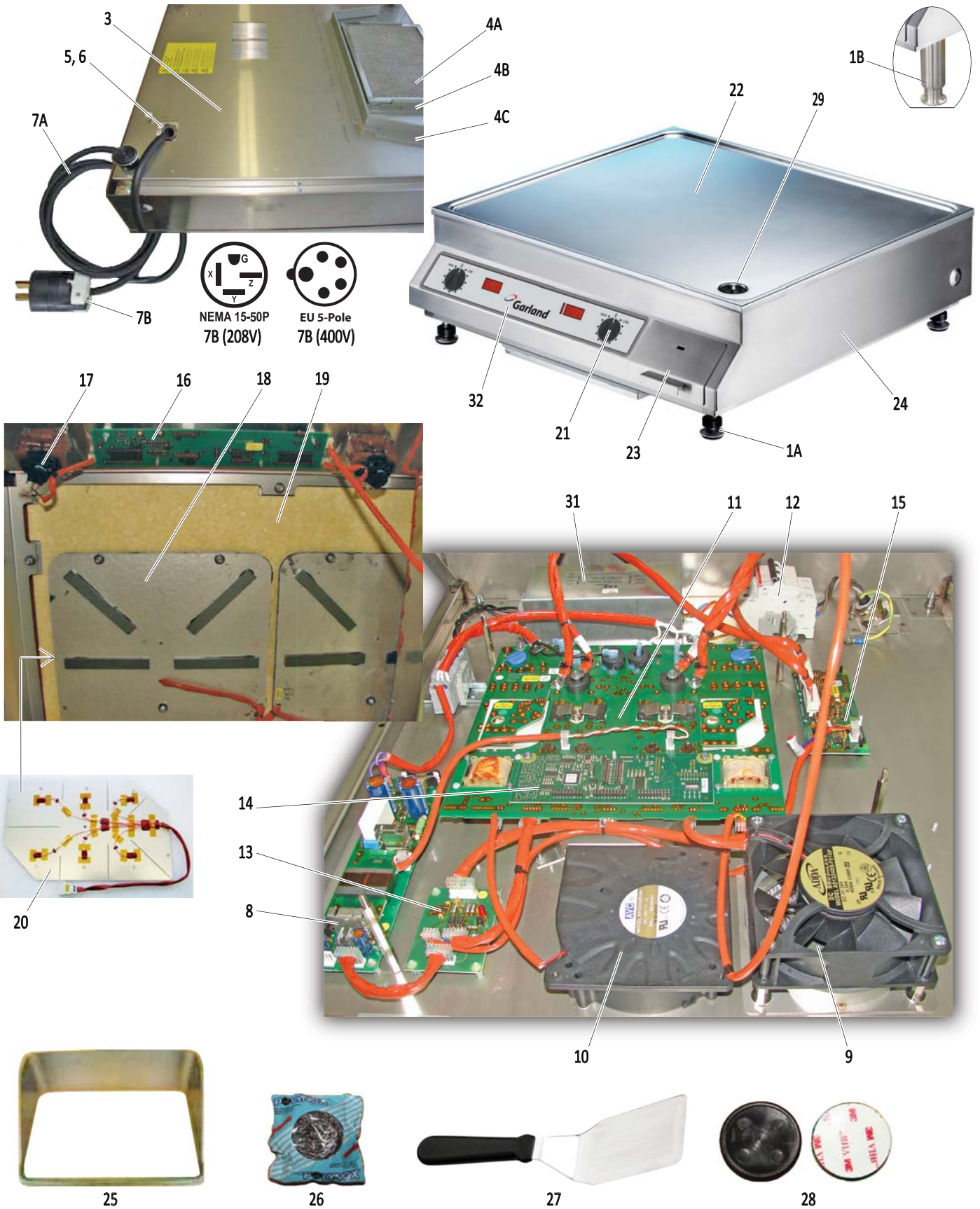

GARLAND PARTS IDENTIFICATION
RTCSmp Induction Counter Top Griddle Line, Dual, 10kW

208V / 400V models

208V: SH DU GR 10000/ 10.0kW 30A 60Hz 3Phase/ Article No. 99650030

400V: SH DU GR 10000/ 10.0kW 16A 50Hz 3Phase/ Article No. 99650031

ITEM	PART #	DESCRIPTION	208V	400V	CRITICAL
1A	95000120	Foot Complete Assembly, Adjustable	4	4	
1B	71000032	S/S Legs, Adjustable, min 5" max 6" (208V N. American Market)	4		
4A	71000012	Grease Filter 280x 200x 12mm	1	1	
4B	72261040	Frame for Grease Filter (Plastic)	1	1	
4C	72144910	Air Deflector (Plastic)	1	1	
	72300830	Air Deflector (Plastic) (208V N. American Market; Use with taller S/S Legs item# 1B)	1		
5	39500004	Nut PG21	1	1	
6	39500011	Cable Connector Nut (Cable Gland PG21)	1	1	
7A	38324001	Mains Cable UL-CSA TYP SJOOW 4x AWG 10, Black	1		
	38625050	Mains Cable VDE 4x 2.5mm ²		1	
7B	32750402	Plug, Mains Power Cord USA NEMA 15-50P	1		
	32750503	Plug, Mains Power Cord EU 5-Pole 400V/16A		1	
8	91120030	AC/DC Board (Print I120b)	1		
	91120020	AC/DC Board (Print I120b)		1	
9	94090006	Axial Fan 24VDC	1	1	C
10	94090011	Radial Fan 24VDC	1	1	C
11	98012661	Power Module Complete Assembly 2x5kW	1		C
	98012610	Power Module Complete Assembly 2x5kW		1	C
12	34260200	Automatic Circuit Breaker 3 x 20A (400V Units Only)		1	
13	91109012	(Print I109c) Supply & CAN-BUS Interface Board	1	1	C
14	91131260	CPU Print/Board (I131b) for Dual Griddle	1		
	91131010	CPU Print/Board (I131b) for Dual Griddle		1	
15	91133031	RTCSmp Dual Griddle Board (Print I133)	1	1	
16	91150020	(Print) Display Board SH/DU/GR, degree Fahrenheit	1		
	91150011	(Print) Display Board SH/DU/GR, degree Celsius		1	
17	94010010	Main Power Switch 2 Pol with Potentiometer	2	2	C
18	93058070	Induction Coil, Griddle, 58.07 Dual	2		
	93058030	Induction Coil, Griddle, 58.03 Dual		2	
19	72291111	Griddle Plate Insulation 2 Zones	1	1	
20	94040074	Sensor Unit, Griddle, 12 Pol	2	2	C
21	39400005	Plastic Knob	2	2	
22	95000091	Griddle Plate Assembly SH/DU/GR	1	1	
23	72145250	Grease Drawer SH/DU/GR	1	1	
24	98300045	S/S Housing SH/DU/GR	1	1	
25	72400050	Spatter Protection SH/DU/GR	1	1	
26	72205012	Cleaning Pad	1	1	
27	72205013	Griddle Spatula	1	1	
28	72264020	Tabletop Self Adhesive Non-slip Pads (pack of 4)	1	1	
29	72146160	Grease Chute, Single & Dual Griddle	1	1	
31	91168030	Mains Filter 3 x 32A, 208V	1		
	91167010	Mains Filter 3 x 16A		1	
32	66000008	New Garland Overlay/Label - SH/DU/GR	1	1	

* NOT ILLUSTRATED

RECOMMENDED STOCK PARTS

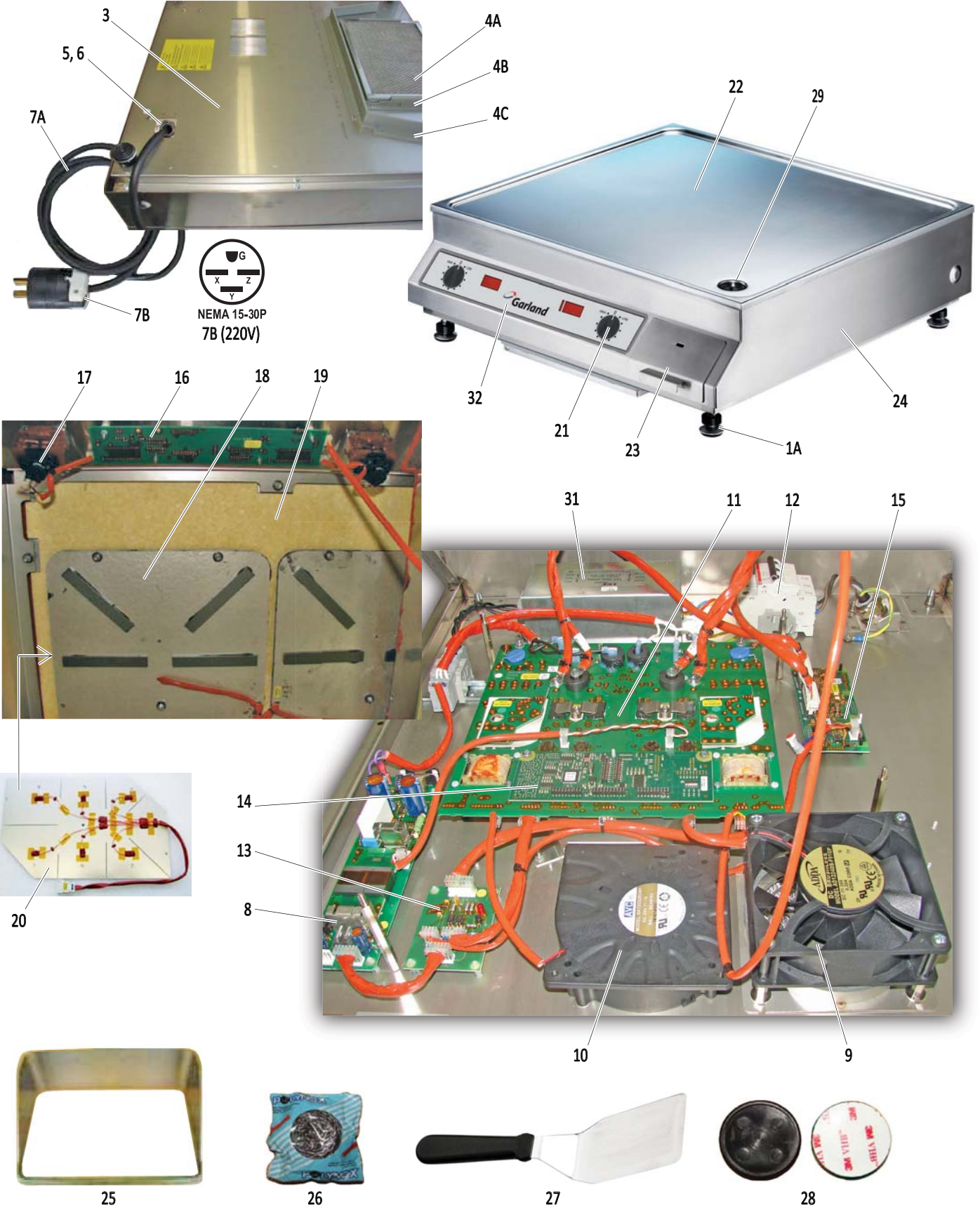

GARLAND PARTS IDENTIFICATION
RTCSmp Induction Counter Top Griddle Line, Dual, 10kW

220V model

220V: SH DU GR 10000/ 10.0kW 50/60Hz 3Phase 28A/ Article No. 99980075

ITEM	PART #	DESCRIPTION	220V	CRITICAL
1A	95000120	Foot Complete Assembly, Adjustable	4	
4A	71000012	Grease Filter 280x200x12mm	1	
4B	71000012	Grease Filter 280x 200x 12mm	1	
4C	72144910	Air Deflector (Plastic)	1	
5	39500004	Nut PG21	1	
6	39500011	Cable Connector Nut (Cable Gland PG21)	1	
7A	38640041	Power Cable UL 4 AWG 12 (4mm)	1	
7B	32750401	Power Plug USA NEMA 15-30P	1	
8	91120030	AC/DC Board (Print I120b)	1	
9	94090006	Axial Fan 24DC	1	C
10	94090011	Radial Fan 24DC	1	C
11	98012660	Power Board 2x5kW	1	C
12	34260320	Automatic Circuit Breaker	1	
13	91109010	(Print I109a) Supply & CAN-BUS Interface Board	1	C
14	91131270	CPU Print/Board (I131) for Dual Griddle	1	
15	91133030	RTCSmp Dual Cooker Board (Print I133)	1	
16	91150020	(Print) Display Board SH/DU/GR, degree Fahrenheit	1	
	91150011	(Print) Display Board SH/DU/GR, degree Celsius	1	
17	94010010	Main Power Switch 2 Pol with Potentiometer	2	C
18	93055030	Induction Coil, Griddle, 55.03 Dual	2	
19	72291111	Griddle Plate Insulation 2 Zones	1	
20	94040074	Sensor Unit, Griddle, 12 Pol	2	C
21	39400005	Plastic Knob	2	
22	95000091	Griddle Plate Assembly SH/DU/GR	1	
23	72145250	Grease Drawer SH/DU/GR	1	
24	98300045	S/S Housing SH/DU/GR	1	
25	72400050	Spatter Protection SH/DU/GR	1	
26	72205012	Cleaning Pad	1	
27	72205013	Griddle Spatula	1	
28	72264020	Tabletop Self Adhesive Non-slip Pads (pack of 4)	1	
29	72146160	Grease Chute, Single & Dual Griddle	1	
31	39332601	Mains Filter 3 x 26A	1	
32	66000008	Garland Overlay/Label - SH/DU/GR	1	

* NOT ILLUSTRATED

RECOMMENDED STOCK PARTS

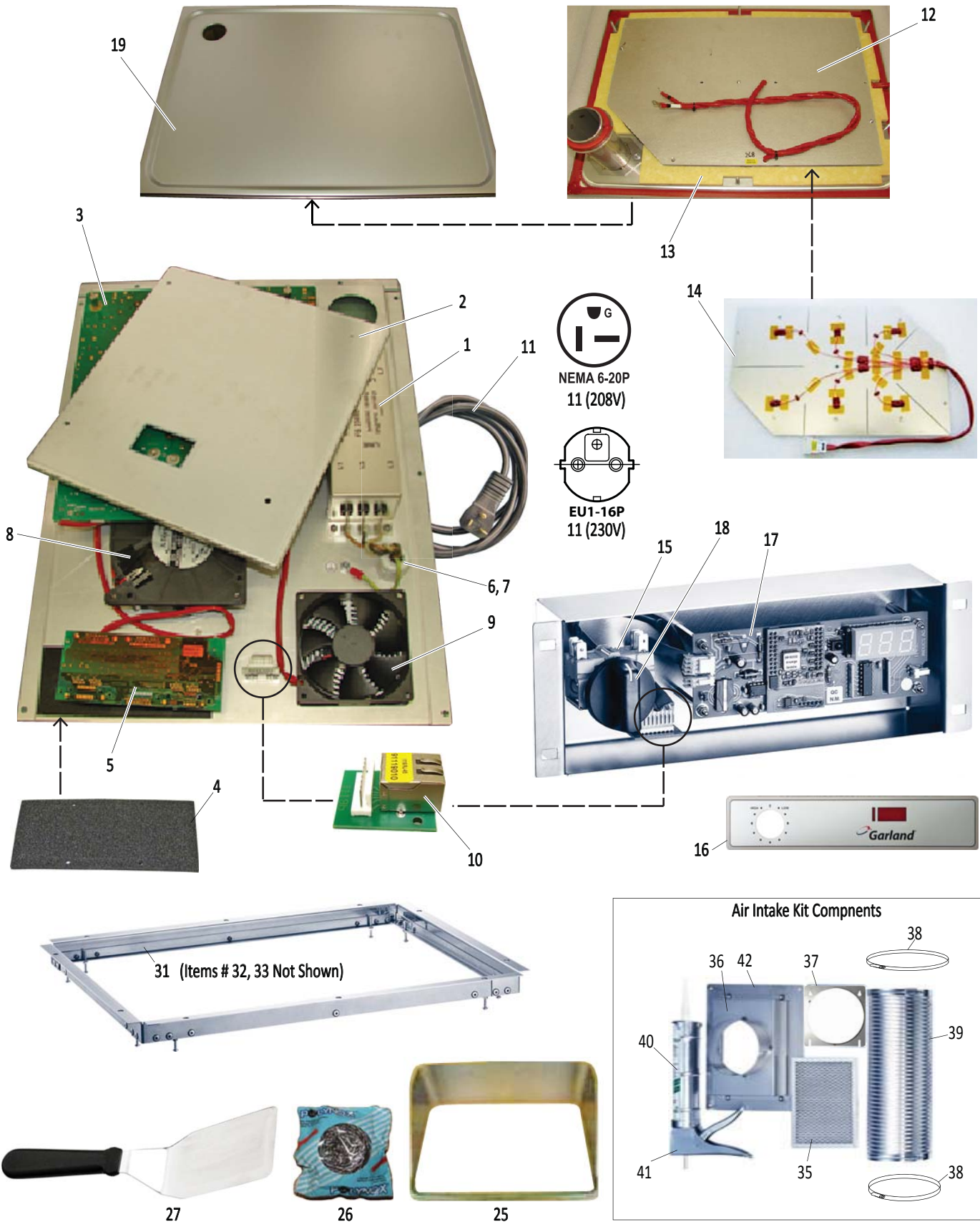

GARLAND PARTS IDENTIFICATION
RTCSmp Induction Built-In Griddle Line, Single, 3.5kW

208V / 230V models

208V: SH GR IN 3500/ 3.5kW 16A 60Hz 1Phase/ Article No. 99580050

230V: SH GR IN 3500/ 3.5kW 15A 50Hz 1Phase/ Article No. 99580051

ITEM	PART #	DESCRIPTION	208V	230V	CRITICAL
1	39311603	Mains Line Filter 18A - CSA	1		
	39311602	Mains Line Filter 16A		1	
2	72142580	Cover Plate	1	1	
3	98021709	Power Module Complete Assembly (3.5kW) for Griddle	1	1	C
4	72291120	Heat Sink Pad, 215x 98x 5mm	1	1	
5	91133020	RCTSmp Single Board (Print I133)	1	1	
6	39500003	Nut PG16	1	1	
7	39500009	Cable Connector Nut (Cable Gland PG16)	1	1	
8	94090011	Radial Fan 24VDC	1	1	C
9	94090001	Axial Fan 24VDC	1	1	C
10	91119010	RJ-45 Print 119	2	2	C
11	38614035	Mains Cable USA Type 6-20A	1		
	38615030	Mains Cable EU with Plug		1	
12	93050030	Induction Coil, Griddle, 50.03 Single	1	1	
13	72291092	Insulation, Griddle Plate	1	1	
14	94040074	Sensor Unit, Griddle, 12 Pol, 6x PT 1k	1	1	C
15	94010001	Power Switch 2 Pol with Potentiometer	1	1	C
16	66000007	Overlay, Single, Install Line, SH/GR/IN	1	1	
17	91145020	(Print) Display Board SH/GR, degree Fahrenheit	1		
	91145011	(Print) Display Board SH/GR, degree Celsius		1	
18	39400005	Plastic Knob	1	1	
19	95000090	Griddle Plate Assembly SH/GR	1	1	
25	72400040	Spatter Protection SH/GR	1	1	
26	72205012	Cleaning Pad	1	1	
27	72205013	Griddle Spatula	1	1	
31	95000068	Install Mounting Frame (SH/GR/IN) Note: Includes items 32, 33.	1	1	
32*	70000060	Silicone Gasket (1.9-meter)	1	1	
33*	72300670	Inner Frame/Leveling Plate	1	1	
AIR INTAKE KIT FOR BUILT-IN, SINGLE MODEL, KIT NUMBER = 95000021					
35	71000003	Air Intake Filter	1	1	
36	72183091	Grease Filter Holder	1	1	
37	72263020	Air Conductor (Air Duct) Holder	1	1	
38	76000002	Hose Clamp	2	2	
39	76000001	Air Conductor (Air Duct), Aluminum, Flex	1	1	
40	70000015	Silicone Adhesive PACTAN 7076 (for griddle installation)	1	1	
41	76000003	Caulking Gun (for griddle installation)	1	1	
42	72204090	Grease Filter Holder Front Plate	1	1	

* NOT ILLUSTRATED

RECOMMENDED STOCK PARTS

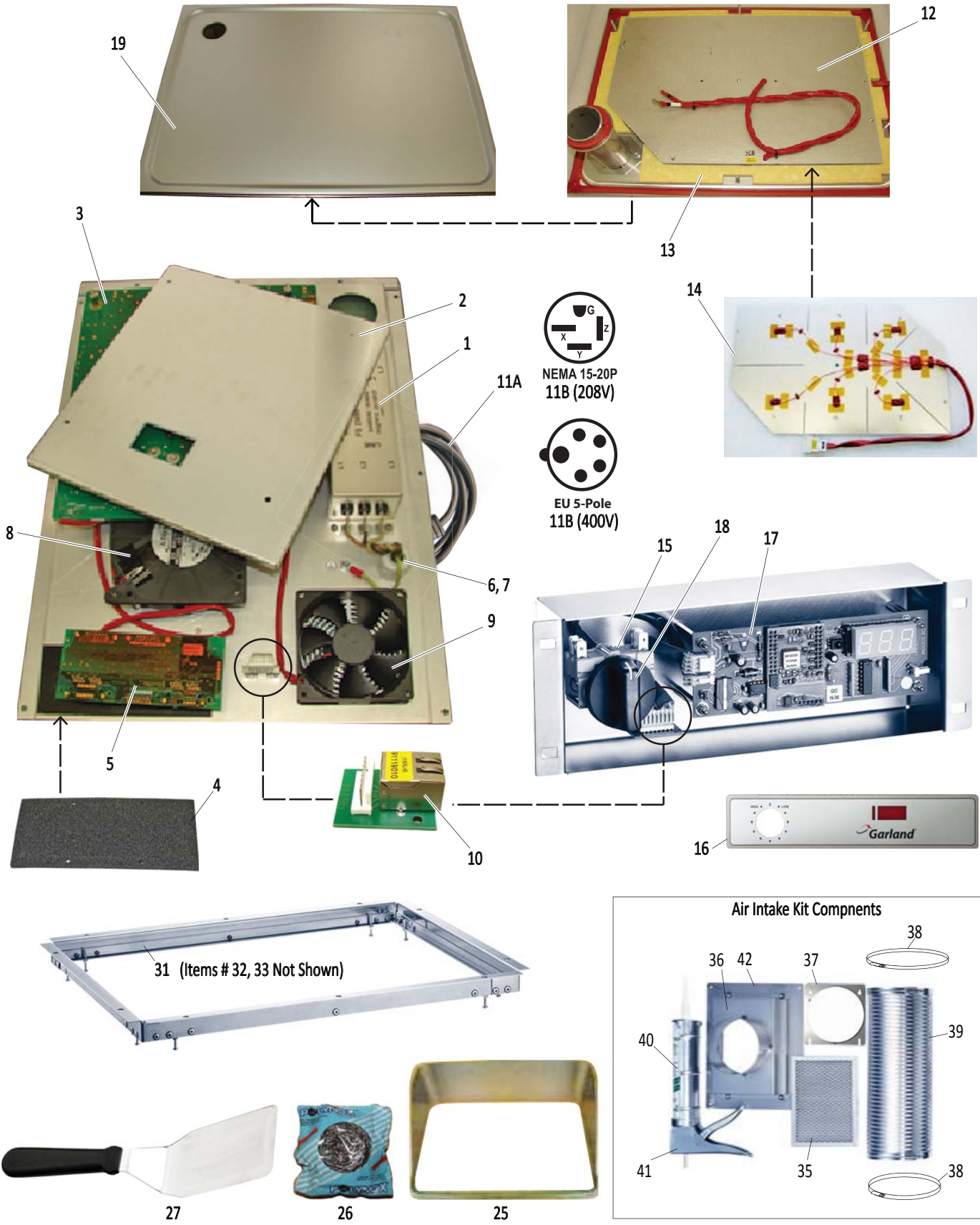

GARLAND PARTS IDENTIFICATION
RTCSmp Induction Built-In Griddle, Single, 5kW

208V / 400V models

208V: SH GR IN 5000/ 5.0kW 14A 60Hz 3Phase/ Article No. 99580052

400V: SH GR IN 5000/ 5.0kW 8A 50Hz 3Phase/ Article No. 99580053

ITEM	PART #	DESCRIPTION	208V	400V	CRITICAL
1	39331602	Mains Line Filter 3x 16A	1		
	39330800	Mains Line Filter 3x 8A		1	
2	72142580	Cover Plate	1	1	
3	98021725	Power Module Complete Assembly (5.0kW) for Griddle	1		C
	98021718	Power Module Complete Assembly (5.0kW) for Griddle		1	C
4	72291120	Heat Sink Pad, 215x 98x 5mm	1	1	
5	91133020	RCTSmp Single Board (Print I133)	1	1	
6	39500003	Nut PG16	1	1	
7	39500009	Cable Connector Nut (Cable Gland PG16)	1	1	
8	94090011	Radial Fan 24VDC	1	1	C
9	94090001	Axial Fan 24VDC	1	1	C
10	91119010	RJ-45 Print 119	2	2	
11A	38625042	Mains Cable UL 4x AWG 14 (2.5)	1		
	38615050	Mains Cable VDE 5x 1.5		1	
11B	32750400	Plug, Mains Cable, USA NEMA 15-20P	1		
	32750503	Plug, Mains Cable, EU 5Pol.		1	
12	93050030	Induction Coil, Griddle, 50.03 Single	1		
	93051030	Induction Coil, Griddle, 51.03 Single		1	
13	72291092	Insulation, Griddle Plate	1	1	
14	94040074	Sensor Unit, Griddle, 12 Pol, 6x PT 1k	1	1	C
15	94010001	Power Switch 2 Pol with Potentiometer	1	1	C
16	66000007	Overlay, Single, Install Line, SH/GR/IN	1	1	
17	91145020	(Print) Display Board SH/GR, degree Fahrenheit	1		
	91145011	(Print) Display Board SH/GR, degree Celsius		1	
18	39400005	Plastic Knob	1	1	
19	95000090	Griddle Plate Assembly SH/GR	1	1	
25	72400040	Spatter Protection SH/GR	1	1	
26	72205012	Cleaning Pad	1	1	
27	72205013	Griddle Spatula	1	1	
31	95000068	Install Mounting Frame (SH/GR/IN) Note: Includes items 32, 33.	1	1	
32*	70000060	Silicone Gasket (1.9-meter)	1	1	
33*	72300670	Inner Frame/Leveling Plate	1	1	
AIR INTAKE KIT FOR BUILT-IN, SINGLE MODEL, KIT NUMBER = 95000021					
35	71000003	Air Intake Filter	1	1	
36	72183091	Grease Filter Holder	1	1	
37	72263020	Air Conductor (Air Duct) Holder	1	1	
38	76000002	Hose Clamp	2	2	
39	76000001	Air Conductor (Air Duct), Aluminum, Flex	1	1	
40	70000015	Silicone Adhesive PACTAN 7076 (for griddle installation)	1	1	
41	76000003	Caulking Gun (for griddle installation)	1	1	
42	72204090	Grease Filter Holder Front Plate	1	1	

* NOT ILLUSTRATED

RECOMMENDED STOCK PARTS

GARLAND INDUCTION PRODUCTS
REPAIR ACCESSORIES FOR SERVICE TECHNICIANS

PHOTO	PART #	DESCRIPTION
	98990001	<i>IR Adapter</i>
	70000020	Heat Conducting Paste P12
	94900096	<i>Short Circuit (Service) Plug (RTCS only, Not for RTCSmp)</i>
	39800001	USB- RS232 Adapter
(PHOTO UNAVAILABLE)	70000022	High Temperature Tape
(PHOTO UNAVAILABLE)	70000015	Silicone Glue PACTAN 7076 (for Installation)
(PHOTO UNAVAILABLE)	76000003	Caulking Gun - Silicone Glue (for Installation)
RECOMMENDED STOCK PARTS		

REVISION HISTORY (RTCSmp GRIDDLES)

REV	MODEL	ITEM#	NOTES	DATE	BY
0	99980075		New Release	OCT 7/2011	HH
1			Added "GI" prefix to model designation.	APR 01/12	HH
	99650021		New model		
	99980075	9	Revised P/N, 94090006 replaced 94040006.		
		14	Revised P/N, 91131270 replaced 91131010.		
		31	Added filter P/N 39332601.		
32		New P/N for Garland Overlay/Label - 66000008.			
2	99650021 99980075	15 / 16	Added Display Boards - 91145011, 91150020	APR 19/12	HH
3			New counter top models: 99650022, 99650024, 99650025, 99650027, 99650028, 99650030, 99650031	MAY 27/14	HH
			New install line models: 99580050, 99580051, 99580052, 99580053 and mounting frame assembly 95000021.		
	99980075 99650021	1	Foot - Complete Asm 95000120 replaced 71000006 and 61421201 (were items 1 and 2)		
	99980075 99650021	4A,4B,4C	Added grease filter frame and air deflector P/N.		
	99980075 99650021	18	Corrected description, was 55.03.		
			Added inf: rating plate location, serial#, nomenclature info, service accessories. Changed file name from G_EC_PL_INDUCSRTCSmp_SHDUGR10000		
4	99650021 99650022 99650023	8	Art. no. 39311602 for 230V, not 208V.	JUN 6/14	HH
			Added model SH/GR 3500.		
			Added items to Repair Accessories Table.		



RTCSmp Induction Griddles (Counter Top and Built-In (Single) Models) — Parts List

Garland Commercial Ranges, Ltd.
1177 Kamato Road
Mississauga, Ontario L4W 1X4 Canada
www.Garland-Group.com

Parts & Service
1 800 427 6668 (Phone, US & Canada)
1 800 361 7745 (Fax, US & Canada)



