

CANOPY INSTALLATION

READ INSTRUCTIONS BEFORE ASSEMBLY

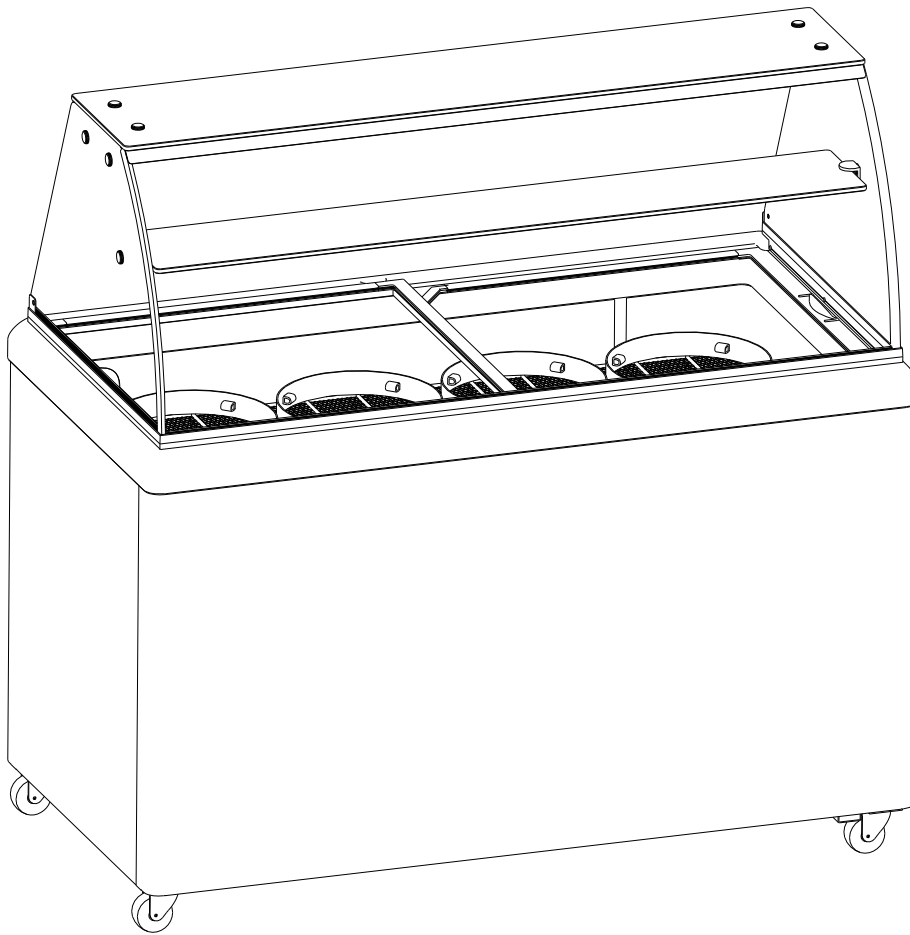

Exploded Drawing

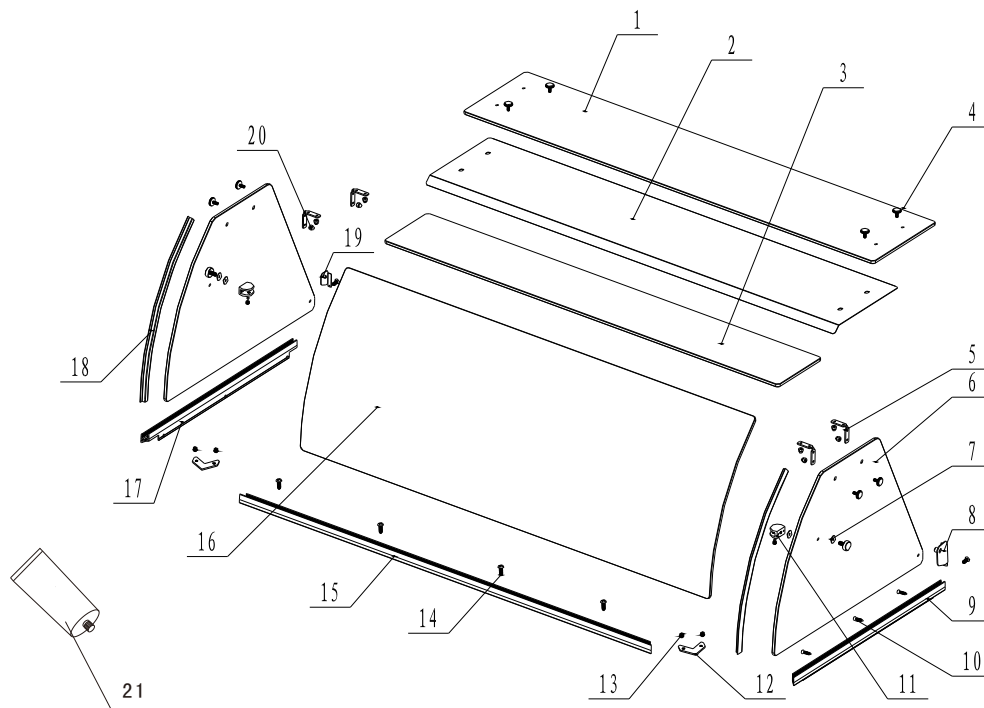

CODE	DESCRIPTION	QTY	CODE	DESCRIPTION	QTY
1	TOP Glass	1	12	Rectangular Connector	2
2	Stainless Steel Plates	1	13	Bolt M5X5	4
3	Middle Glass	1	14	Screw 4.2X13	6
4	Flat Head Bolt M6X16	10	15	Front Fixed Strip	1
5	Rectangular Support	4	16	Front Glass	1
6	Side Glass	2	17	Left Fixed Strip	1
7	Washer	4	18	Seal	2
8	Right Fixed Bracket	1	19	Left Fixed Bracket	1
9	Right Fixed Strip	1	20	Cap Nut M6	8
10	Countersunk Tapping Screw 3.5X14	6	21	Glass Cement	1
11	Clip For Glass	2			

DIPPING CABINETS OVERALL DIMENSIONS

Unit:mm

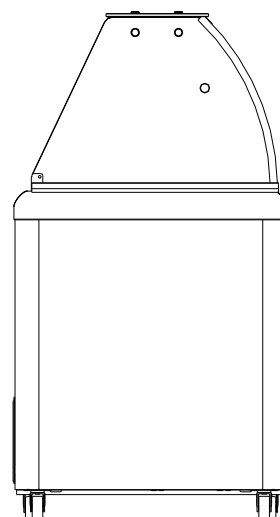
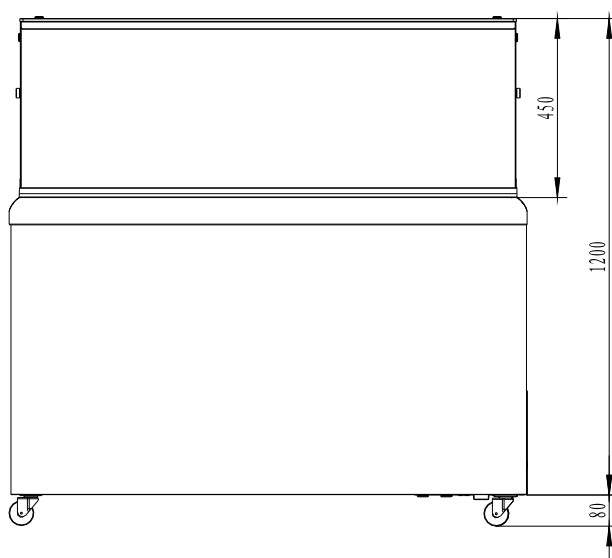

CANOPY INSTALLATION SEQUENCE

1. Check and prepare Parts and Tools
2. Remove lid guide tab from Frame front
3. Assemble the Fixed Strips
4. Install Fixed Strips
5. Applying Glass Cement
6. Pre-installed On The Side Of The Glass
7. Front Glass Installation
8. Left and Right Glass Installation
9. Stainless Steel Plates And TOP Glass Installation
10. Middle Glass Installation
11. Dipping Cabinet Preparation

Installation Guidelines - Step 1

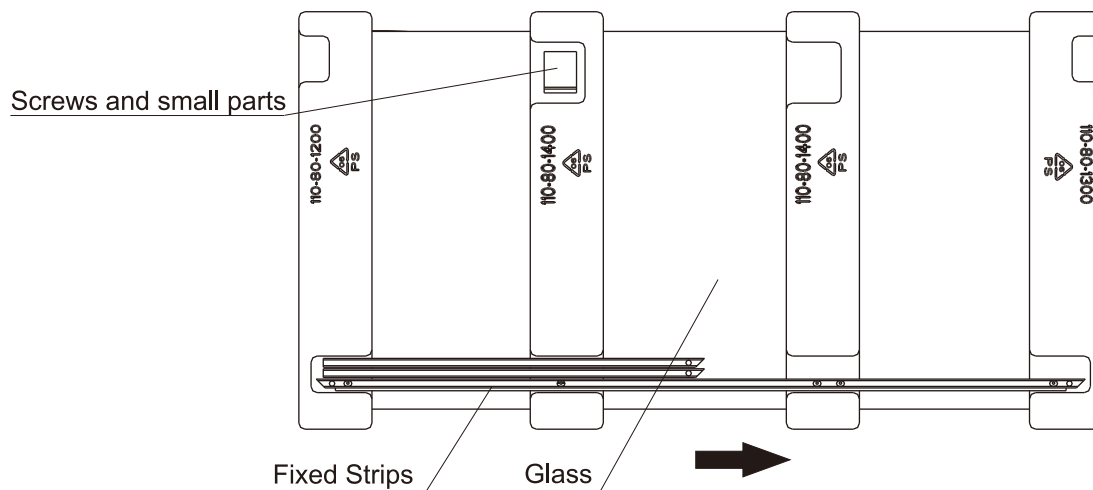

CHECK AND PREPARE PARTS AND TOOLS

1. Open the carton box, take out foam package and remove foam according to the direction arrow.
2. Check parts and quantities as listed in the exploded drawings.
3. Tool preparation: Utility knife, Philips screw driver, Flat head screw driver, Electric drill w/3.2 bit.
4. Store all empty packages in the carton in case they need to be reused.

Note: You must power off the freezer and remove any food inside before installation of canopy.

Installation Guidelines - Step 2

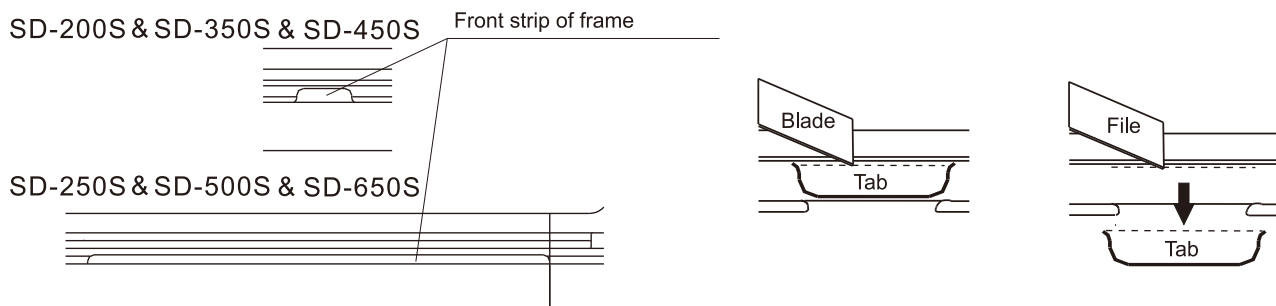

REMOVE LID GUIDE TAB FROM FRAME FRONT

1. Score the front frame lid guide tab several times.
2. Cut through the front frame lid guide tab and pull from frame.
3. Smooth cut area on frame with small file.

Installation Guidelines - Step 3

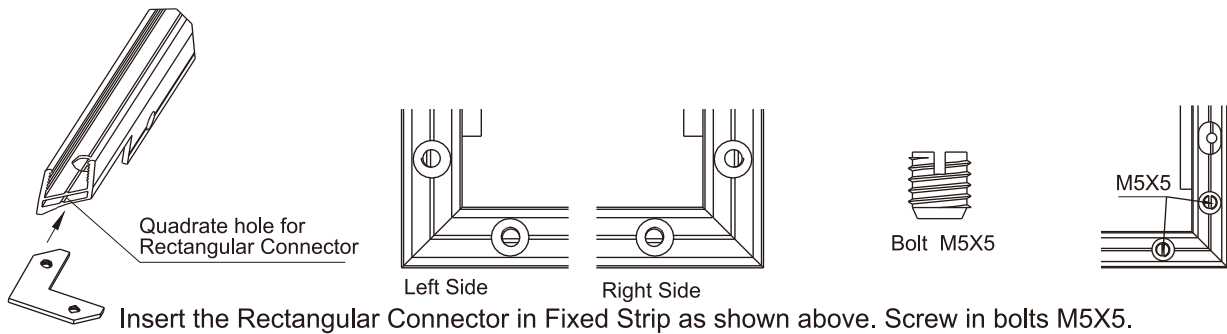

ASSEMBLE THE FIXED STRIPS

1. Slide one side of the Rectangular Connector all the way into the left end of the Front Fixed Strip slot.
2. Slide the other side of the Rectangular Connector all the way into the side slot of the Left Fixed Strip.
3. Securely screw bolt M5X5 into the corresponding holes in the two strips.
4. Repeat Steps 1 - 3 for the right side of the Front Fixed Strip and the Right Fixed Strip.

Installation Guidelines - Step 4

INSTALL FIXED STRIPS

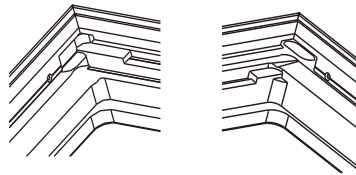

1. Place the sub-assembly on the top frame of the freezer and close to the inside edge.

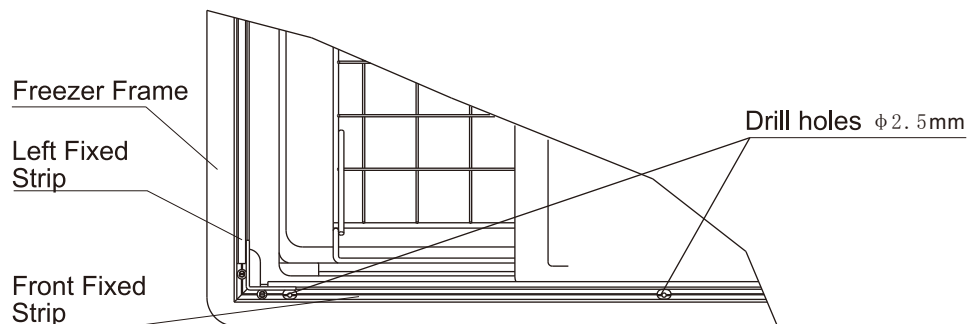

2. Drill the hole and secure the left side of the Front Fixed Strip with Screw 4.2X13.

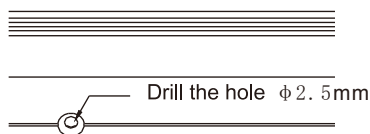

3. Drill the hole and secure the Left and Right Fixed Strips with Screw 3.5X14.

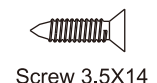

Installation Guidelines - Step 5

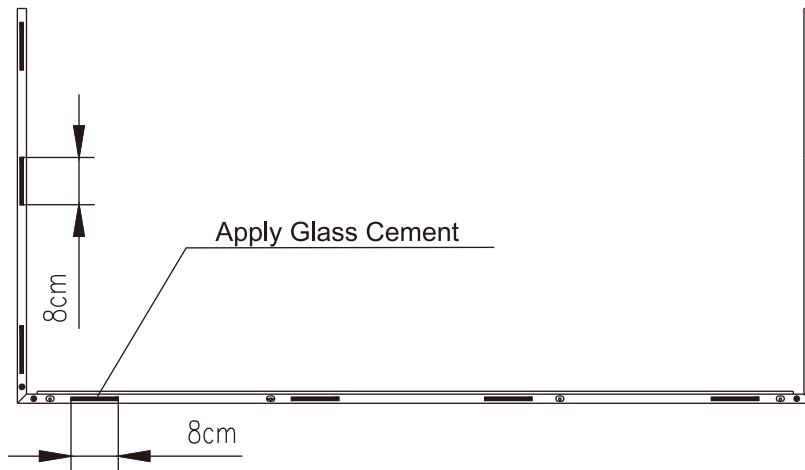

1. Apply Glass Cement in the ten (10) slots of all three (3) Fixed Strips.

Note: Keep unused Glass Cement in a safe place and out of the reach of children.

Installation Guidelines - Step 6

Pre-installed On The Side Of The Glass

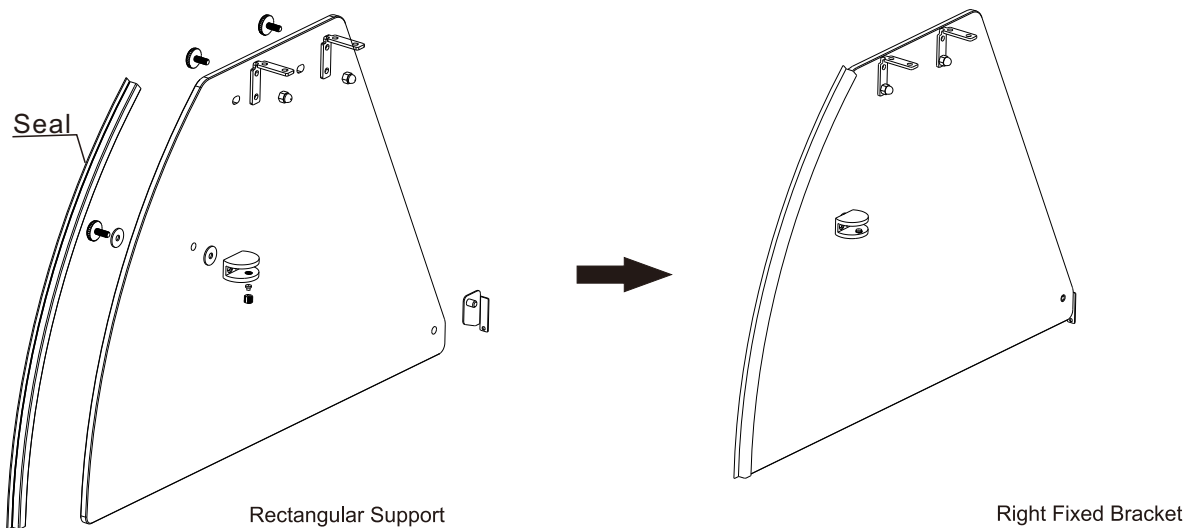

As Shown In Figure

1. Find the Clip, Rectangular Support, Flat Head Bolt M6x16, Glass Cement, Right and Left Fixed Bracket, Seal.
2. Pre-installed the Parts as shown in figure.

Installation Guidelines - Step 7

FRONT GLASS INSTALLATION

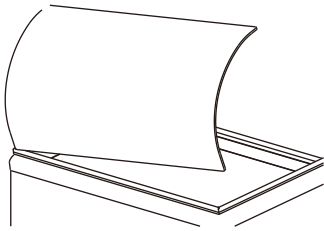

1. Insert the Front Glass into the corresponding slot of the Front Fixed Strip.

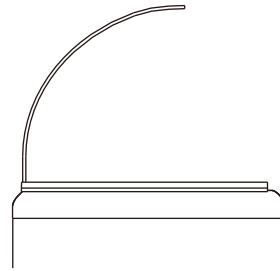

2. Keep the Front Glass in an upright position.

Installation Guidelines - Step 8

Left and Right Glass Installation

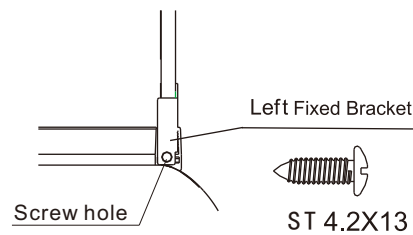
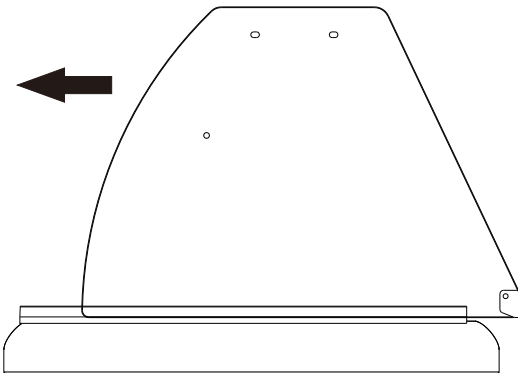

1. Insert the Left Side Glass into the slot of the Left Side Fixed Strip.
2. Fixed the Left Fixed Bracket to the Left Fixed Strip by Screw 4.2x13.
3. Repeat Steps 1 - 2 for installation of the Right Side Glass.

Installation Guidelines - Step 9

TOP Glass and Stainless Steel Plates Installation.

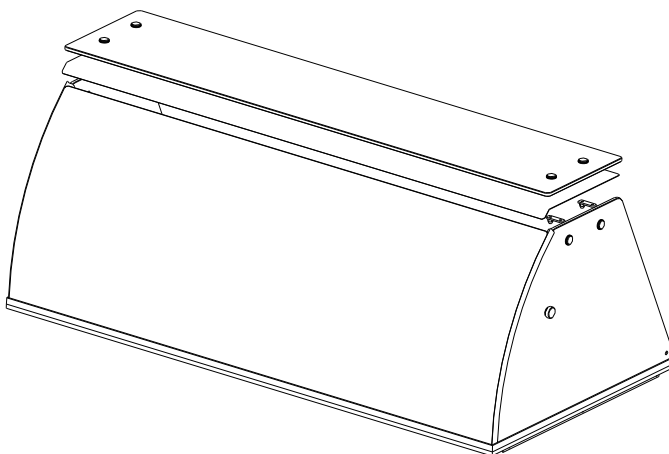

As Shown In Figure

1. Put the Stainless Steel Plates on side glass.
2. Put the TOP Glass on Stainless Steel Plates.
3. Fixed the TOP Glass and Stainless Steel Plates to Rectangular Support by Flat Head Bolt M6x16.

Installation Guidelines - Step 10

Middle Glass Installation

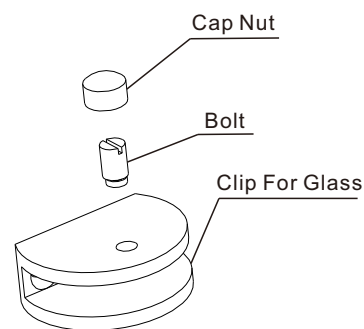
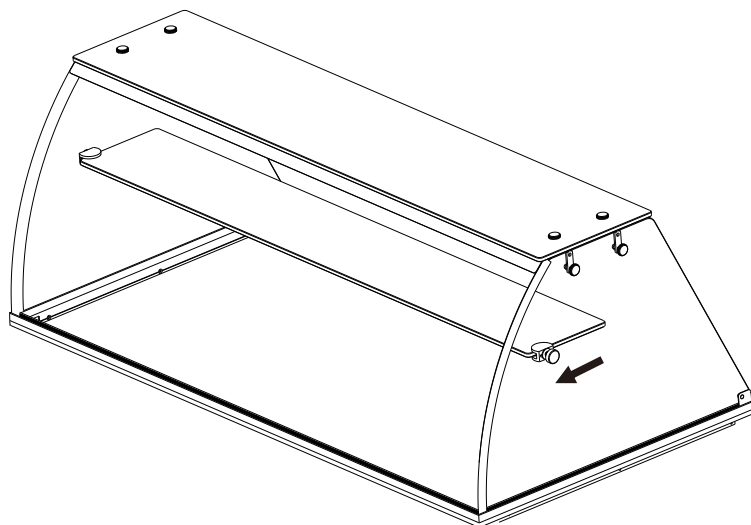

As Shown In Figure

1. Loosen the Bolt on the Clip For Glass.
2. Held the middle glass between the jaws of Clip.
3. Tighten the Bolt and cap Nut.

Installation Guidelines - Step 11

DIPPING CABINET PREPARATION

1. The freezer with the glass canopy attached should sit without being moved for 24-hours to allow the Glass Cement to cure.
2. After the 24 hour curing, the equipment can be moved and used normally. It must also now be cleaned.
3. Please read the Freezer Manual before using the cabinet.

Canpoy Installation diagram

