

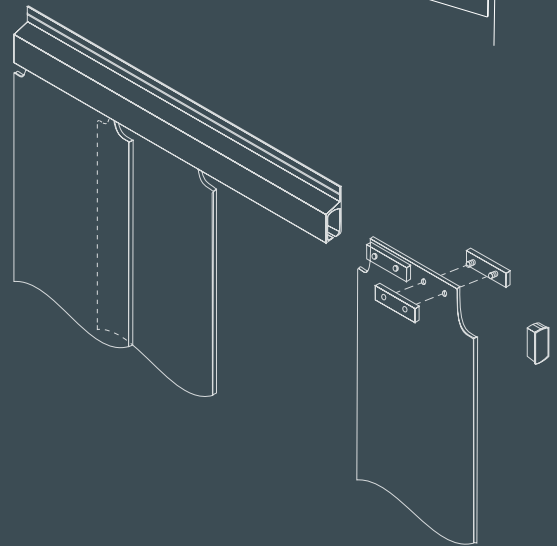

VINYL CURTAINS & DOORS

Where Precision Design Meets Specialty Manufacturing

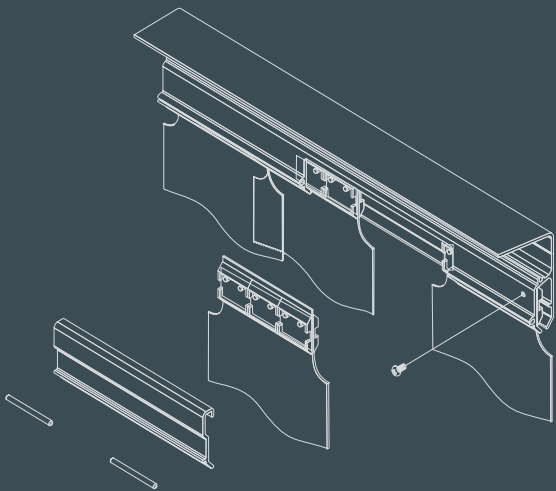

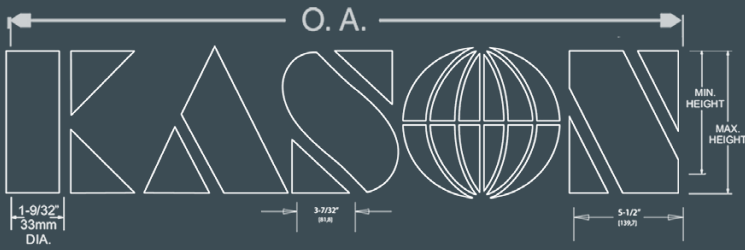
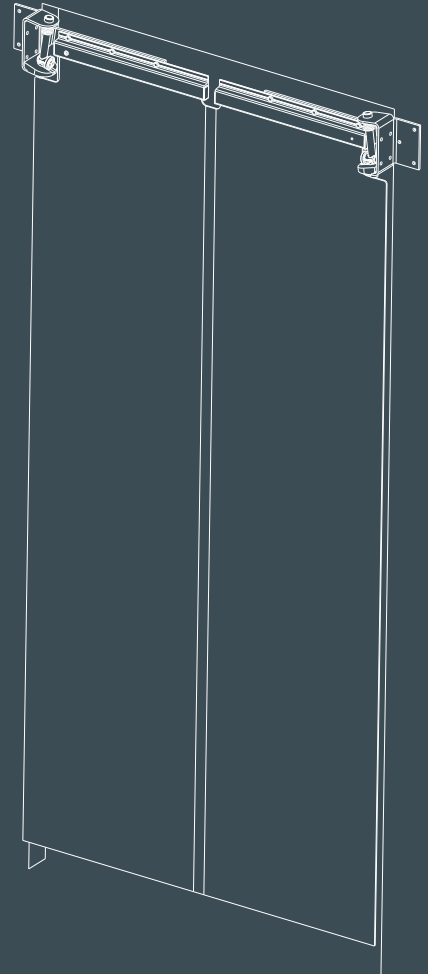
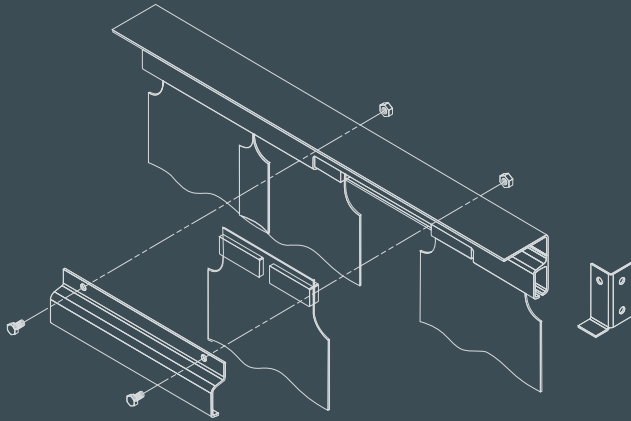

THE KASON MISSION

TO PROTECT YOUR PRODUCT INTEGRITY

Our customers go to great lengths to build top-of-the-line coolers, freezers, foodservice equipment, industrial enclosures and delivery vans. Our goal is to preserve your product integrity by providing the highest quality door hardware and accessories for both original equipment and replacement applications.

End users need to protect products and processes, and lower operating costs. Their first line of defense is stable, airtight enclosures with doors that open with ease and close securely.

Since 1926, Kason has promised and delivered just that. Kason's extensive lines of walk-in and reach-in door hardware satisfy the most demanding requirements. Demonstrate the value of your products with the most innovative, dependable and longlasting hardware in the business.

RESEARCH AND TESTING

Every Kason product must fulfill our customers' requirements. Before we develop a new product, we research the needs of both our industry and end users. We are never satisfied with the status quo. Our dedicated research and development staff continually search for pioneering design concepts. They insist on engineering integrity, extensive product testing and precise, in-line quality control. That is how we have developed such successful and trustworthy products as SafeGuard® inside releasing safety latches, Pacesetter handles and hinges, stainless steel hinges and latches and truck door handles with removable cylinder locks.

CREATIVE CONCEPTS

Leading equipment manufacturers turn to Kason when they want a unique look of their own. We will adapt a stock product, design custom hardware or partner with your design engineers to develop a signature appearance just for your products. Building special and customized hardware is routine at Kason.

QUALITY

Kason production facilities boast state-of-the-art installations, featuring fully automated die-casting, polishing and electroplating, as well as a full range of electronically controlled and robotic machinery. We require the finest raw materials, accurate machine tolerances and the highest level of finishing. Skilled, experienced people maintain the Kason tradition of production excellence. Our unremitting commitment to superior manufacturing assures you consistently high quality products at the lowest possible cost. Quality assurance is integrated into every step of Kason operations – from engineering research and development through packaging and shipping.

SERVICE

The lifeline to all your foodservice needs is our efficient and friendly Customer Service Department. A representative can quickly track product availability or the status of your order with our computerized inventory and order control system. Count on dependable global delivery as we serve you from Kason distribution centers in the continental United States and Canada as well as through authorized distributors throughout the world.

OUR PROMISE

Satisfying your needs is our top priority. That is why Kason supplies you with hardware and accessories that reflect the same quality you demand in your own products. We strive to demonstrate an attitude that makes you want to do business with us. At Kason we offer a tradition of excellence, a philosophy of innovation and the most trusted name in specialty commercial hardware.

KASON CONTACTS

USA SALES & DISTRIBUTION CENTERS

1.800.93KASON (800.935.2766)

KASON INDUSTRIES, INC.

GLOBAL HEADQUARTERS

57 Amlajack Boulevard | Newnan, GA 30265-1015, USA
800.935.3550 | FAX: 770.251.4854
Info@kasonind.com

KASON FOODSERVICE DIVISION

31 Amlajack Boulevard | Newnan, GA 30265-1015, USA
866.231.2157 | FAX: 770.252.8397
FoodService@kasonind.com

KASON INTERNATIONAL DIVISION

57 Amlajack Boulevard | Newnan, GA 30265-1015, USA
770.304.3000 | FAX: 770.251.4854
International@kasonind.com

KASON VINYL DIVISION

31 Amlajack Boulevard | Newnan, GA 30265-1015, USA
678.423.0722 | FAX: 770.252.8397
Vinyl@kasonind.com

KASON CANADA BRANCH

226 Industrial Pkwy North, Unit 2
Aurora, Ontario, L4G 4C3, Canada
905.713.6515 | FAX: 905.713.6518
Canada@kasonind.com

KASON CENTRAL BRANCH

8889 Whitney Drive | Lewis Center, OH 43035-7106, USA
740.549.2100 | FAX: 740.549.0701
Central@kasonind.com

KASON MID-AMERICA BRANCH

1239 Atlantic Avenue | Kansas City, MO 64116-4141, USA
816.472.7450 | FAX: 816.472.8580
MidAmerica@kasonind.com

KASON WESTERN BRANCH

1500 East Wooley Road, Suite E
Oxnard, CA 93030-7385, USA
805.247.1088 | FAX: 805.247.1164
Western@kasonind.com



CONTENTS

KASON VINYL TRAFFIC DOOR SYSTEMS	C4-5
VINYL STRIP CURTAIN SYSTEMS	
Easimount®	C6
Easimount® II	C7
Maximount®	C7
Universal Heavy Duty.....	C7
THERMAL FLEX® VINYL SWING DOORS..... C8 - 9	
Single Panel	
Double Panel	
EASIMOUNT® STRIP CURTAIN POINT OF SALE DISPLAY	
	C10
VINYL STRIP SELECTOR.....	C11
ORDERING GUIDE	C12

PROTECT YOUR INTEGRITY

Protect your product integrity with the most innovative, dependable and long-lasting hardware in the business — Kason.

Walk-in manufacturers have made Kason the first name in quality hardware and panel fasteners since 1926. We retain that leadership through close relationships with our customers and thorough knowledge and understanding of their requirements.

Kason hardware and accessories continually evolve to better meet the demands of the industry. If a product does not fit an application, we develop a new product. Walk-in manufacturers benefit from our incomparable knowledge and experience, because Kason products work better and last longer. Our time-tested hardware and accessories engineered specifically for walk-in requirements provide true value.

Kason products help your walk-ins accomplish what your customers demand of them.

KASON PRODUCT LINES

HARDWARE and ACCESSORIES for:

- Walk-In Coolers, Freezers and Test Chambers
- Reach-In Coolers, Freezers and Refrigerators
- Ovens and Heated Holding Cabinets
- Food Prep and Serving Equipment
- Cabinets and Cafeteria Equipment
- Truck Bodies
- Panelock™ Panel Fasteners
- Doorware® Sliding Door Operating Systems
- Electrical Devices and Lighting Fixtures
- Vinyl Strip Curtains and Swing Doors
- Casters and Caster Legs

MEASURE BEFORE ORDERING TO ENSURE THE BEST FIT

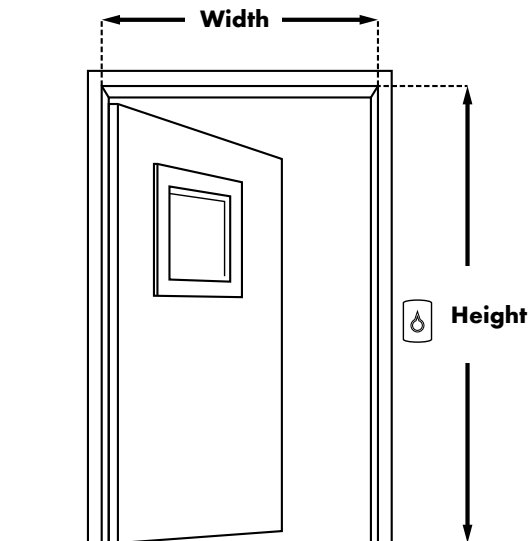

- Measure WIDTH from inside of door frame edges
- Measure HEIGHT from the floor to the top inside door frame edge
- Note any obstructions that may impact the installation of the vinyl curtain system so the proper mounting application can be selected, i.e. lighting, electrical, etc.

KASON VINYL TRAFFIC DOOR SYSTEMS

Kason vinyl traffic door systems are an effective secondary barrier for a variety of applications where controlling environmental conditions is a priority. Kason offers several vinyl door systems in an assortment of vinyl types to meet your specific needs.

REDUCE UTILITIES AND SAVE ENERGY

Vinyl door systems act as a barrier to slow both heat and cool thermal loss which ultimately lowers your utility costs and saves energy consumption.

EXTEND EQUIPMENT LIFE

Vinyl door systems improve the efficiency of your HVAC equipment by helping maintain proper temperatures which also reduces compressor run time. Vinyl doors help control dust reducing filter maintenance and ultimately cut down on the main door's wear and tear.

SEPARATES WORK ENVIRONMENTS

Vinyl door systems provide one of the most cost effective ways to separate work environments. They are easy to install, inexpensive to maintain and provide flexibility in the ability to reconfigure workspaces.

PROMOTES MORE EFFICIENT AND COMFORTABLE WORKSPACES

Vinyl door systems allow better and more efficient traffic flow of personnel while maintaining the attributes of a traditional door. The ability to protect workers from undesirable elements like dust, weather, fumes, noise and more provides a more comfortable working environment.

APPLICATIONS

- Walk-in coolers and freezers
- Food distribution centers
- Restaurants/supermarkets/convenience stores
- Laboratories
- Loading docks
- Mining
- Dust control
- Noise control
- Conveyor openings
- Spray booths
- Welding curtains



Kason offers five vinyl strip curtain systems to meet your specific room divider needs. From standard doorways to entire warehouse length curtains, vinyl strip curtain systems provide a range of benefits.

- Reduces energy costs by 20% or more.
- Helps maintain thermal fluctuations
- Protects personnel, products and equipment from elements.
- Reduces noise, dust, and contaminants
- Improves productivity by increasing personnel traffic flow
- Extends HVAC system's life
- Reduces walk-in hardware maintenance

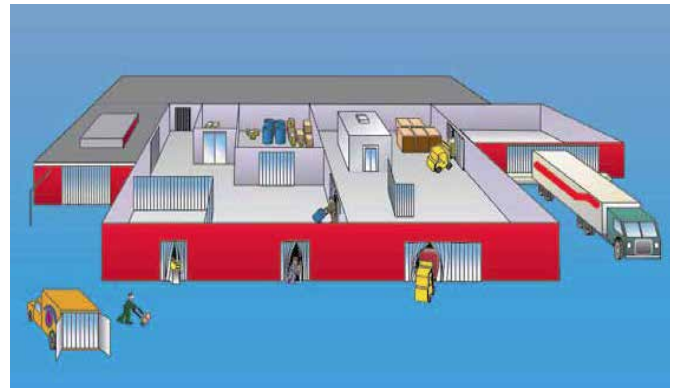

APPLICATIONS

- Walk-in Refrigeration
- Storage Enclosures
- Loading Dock Doors
- Personnel Doors
- Room Partitions
- Machine Enclosures
- Drive-thru Doors
- Conveyor Openings
- Craneway Enclosures
- Polishing/Sanding Areas
- Electronics Enclosures
- Spray Booth Partitions
- Welding Curtains
- Laboratories



- Also available in pre-cut strips or bulk rolls
- 11 vinyl types and 5 temperature ranges
- USDA and NSF materials available

VINYL STRIP CURTAIN APPLICATIONS

	Easimount®	Easimount® II	Maximount®	Heavy Duty Strip Curtains	Single Panel Swing Door	Double Panel Swing Door
Walk-In Cooler (Low Temperatures)	✓	✓	✓	✓	✓	✓
Walk-in Freezer (Freezing Temperatures)	✓	✓	✓	✓	✓	✓
Food Storage and Preparation	✓	✓	✗	✗	✓	✓
Outdoor/Environment Openings	✓	✓	✓	✓	✗	✗
Room Partitions	✓	✓	✓	✓	✓	✓
Machinery/Hardware	✗	✓	✓	✓	✗	✗
Chemical Exposure	✓	✓	✓	✓	✗	✗

© 2020 Kason Industries, Inc.

0819 LIT 001

VINYL STRIP CURTAIN SYSTEMS

EASIMOUNT® VINYL STRIP CURTAIN SYSTEM

Mounting: Flush wall

- Easy and fast installation
- Easy to replace strips reduces labor/maintenance costs
- Durable pre-cleated strips slide into place and help prevent tear outs
- Easy to clean clear vinyl provides high visibility
- Suitable for multiple vinyl types
- Universal design allows installation for walk-in coolers and freezers

SPECIFICATIONS

Materials

- Vinyl Strip Types: Multiple (see pc. C11)
- Mounting Channel: Extruded aluminum
- Mounting Hardware: Stainless steel
- End Caps: Polypropylene

Door Opening

- Standard: 38" x 84" for openings 30"–38" wide
42" x 84" for openings 38"–42" wide
- Additional Sizes Available @ 800.935.2766

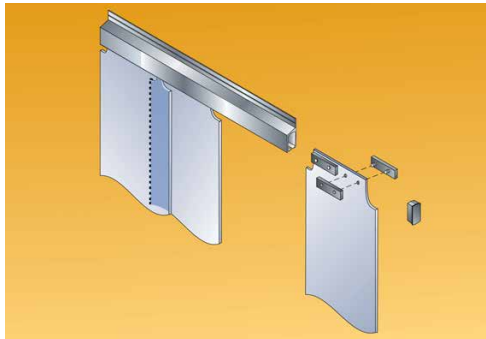

INSTALLATION IN MINUTES



1 Attach mounting bar



2 Slide in strips

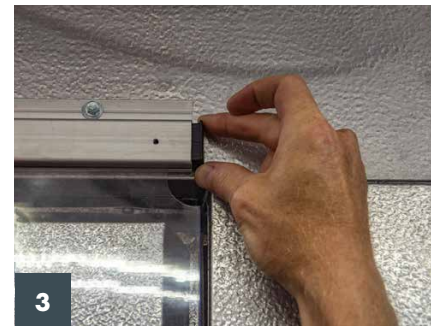

3 Secure strips with end caps

EASIMOUNT® II VINYL STRIP CURTAIN SYSTEM

Mounting: flush wall, doorjamb and overhead

- Easy and fast installation
- Durable pre-cleated strips slide into place and prevents tear outs.
- Specify mounting option when ordering
- Optional mid-track strip loading reduces labor/maintenance
- Includes mounting channel

SPECIFICATIONS

Materials

- Vinyl Strip Types: Multiple (see pg. C11)
- Mounting Channel: Extruded aluminum
- Mounting Hardware: Stainless steel
- Side Wall Brackets: Zinc plated steel

Door Opening Size/Wall Width

- See Ordering Guide on pg. C12

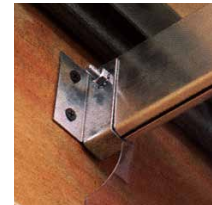
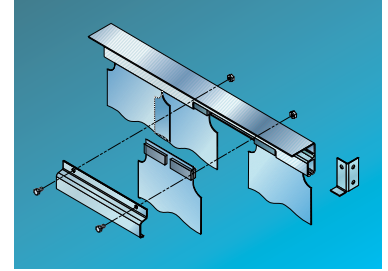

Left: Optional doorjamb or side wall mount with supplied header brackets.

MAXIMOUNT® VINYL STRIP CURTAIN SYSTEM

Mounting: flush wall, doorjamb and overhead

- Maximum duty system made of heavy gauge aluminum extrusions to carry heavy loads and last
- Easy and fast installation
- Durable pre-cleated strips slide into place and prevent tear outs
- Specify mounting option when ordering
- Optional mid-track strip loading reduces labor/maintenance

SPECIFICATIONS

Materials

- Vinyl Strip Types: Multiple (see pg. C11)
- Mounting Channel: Extruded aluminum
- Mounting Hardware: Stainless steel
- Only screw for edge strip is included

Door Opening Size/Wall Width

- See Ordering Guide on pg. C12

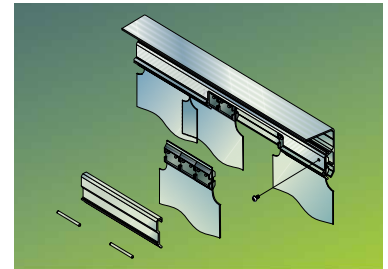

Maximum duty system made of heavy gauge aluminum extrusions to carry heavy loads and last

UNIVERSAL HEAVY DUTY VINYL STRIP CURTAIN

Mounting: flush wall and overhead

- Traditional heavy duty system
- Utilizes bolt-on mounting of vinyl strips
- Ideal for Industrial and warehouse applications
- Suitable for multiple vinyl types

SPECIFICATIONS

Materials

- Vinyl Strip Types: Multiple (see pg. C11)
- Mounting Channel: Galvanized steel
- Mounting Hardware: Zinc plated steel

Door Opening Size/Wall Width

- See Ordering Guide (see pg. C12)

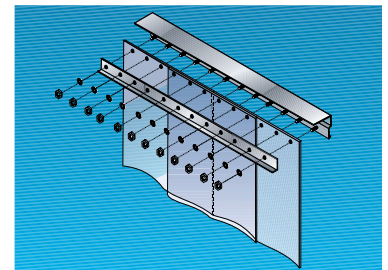

THERMAL FLEX® VINYL SWING DOORS

SINGLE PANEL SWING DOOR



Thermal Flex® Vinyl Swing Doors offer single and double panel options to meet your specific application needs. Each system uses stainless steel components engineered to perform in the toughest commercial kitchen environments.

- Meets USDA and NSF standards
- Easy-to-clean, clear vinyl material provides high visibility
- Will not drag across product or snag on personnel or carts
- Gravity hinge closes door quickly but gently
- Exclusive adjustable cam block assures that the open door swings back to center position
- Mounting hardware included
- 10-year rust-proof hinge warranty

SPECIFICATIONS

Materials

- Vinyl Type: 402 smooth vinyl panel
- Curtain Channel: Extruded aluminum
- Hinge Brackets and Arm: Stainless steel
- Mounting Hardware: Stainless steel

Door Opening Size

- Maximum single panel width: 36"
- See Ordering Guide on pg. C12

DOUBLE PANEL SWING DOORS



* Impact plates (left) and brace plates (above) are optional features available for both single and double panel doors. Contact customer service for pricing.

TOP AND SIDE MOUNT HEAVY DUTY HINGES

- Kason top and side mount heavy duty hinges provide flexibility to any application that is restricted by space.
- High-grade stainless steel hinges designed specifically for walk-in cooler/freezer applications
- Gravity hinge closes door quickly but gently.
- Exclusive adjustable cam block assures that the open door swings back to center position, even if the door jamb is out of line.
- Top mounted hinge provides 270° swing radius
- Side mounted hinge provides 240° swing radius
- Strong, versatile hinge accommodates most door widths
- 10-year rust-proof hinge warranty



TOP MOUNT



SIDE MOUNT

SPECIFICATIONS

Materials

- Hinge Components: Stainless steel
- Mounting Hardware: Stainless steel

Opening Size

- See Ordering Guide on pg. C12



Hinge cam block adjusts with phillips head screwdriver.

HEAVY DUTY VINYL SWING DOOR HINGE MOUNTING KIT

- The Kason heavy duty hinge mounting kit allows swing door to be adapted to walk-in applications where mounting space is limited inside the doorjamb.
- Stainless steel hinges designed specifically for walk-in cooler/freezer applications
- Strong extruded aluminum mounting bracket
- Zinc plated steel mounting hardware

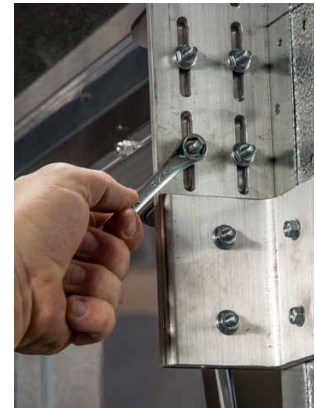

VINYL SWING DOOR RETRO-FIT THRU-BOLT KIT

- The Kason swing door retro-fit kit is designed for use in walk-in applications where there is insufficient support within the walls.
- Includes: mounting plates, stainless steel bolts for 4" thick walls, and stainless steel nuts and washers

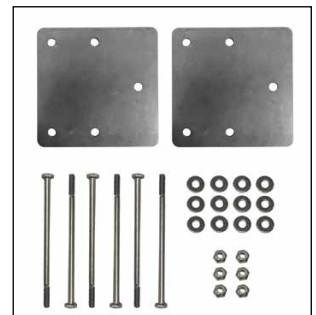
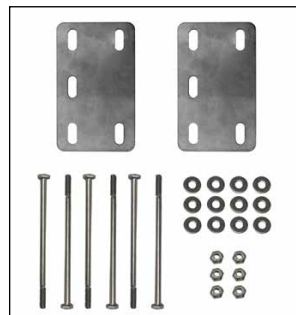

EASIMOUNT® POINT OF SALE DISPLAY



Kason Easimount® Vinyl Strip Curtains are the most effective way to save energy and reduce utility costs of your customer's walk-in coolers and freezers.

The Point of Sale Display provides:

- **Increased Visibility and Sales**
- **Small Floorspace Footprint**
11" wide x 20" deep x 60" high
- **(6) Curtain Sets per Unit**
One curtain size per unit - see options below.
- **Reusable Display**

FEATURES AND BENEFITS

- Easy to install system (hardware included)
- Greatly reduces utilities and maintenance costs
- High-quality freezer-grade vinyl for use in coolers and freezers
- Strips can be trimmed to accommodate length

SPECIFICATIONS

MATERIALS

- Vinyl Strips:
 - USDA approved freezer-grade clear vinyl -40 to +70°F (-40 to +21°C) (Max. temp. 82°F)
 - Pre-created vinyl strips 6" wide x 0.06" thick (15.24 cm wide x 0.1524 cm thick)
- Mounting Channel: Extruded aluminum
- Mounting Hardware: Stainless steel
- End Caps: Polypropylene
- **Door Opening**
 - Standard: 38" x 84" for openings 30"–38" wide
42" x 84" for openings 38"–42" wide

Model No.	Description	Curtain Size in. (cm)
402SD6063884	(1) POS display box (6) Low-Temp Pack Sets	38 x 84 (96.5 x 213.3)
402SD6064284	(1) POS display box (6) Low-Temp Pack Sets	42 x 84 (106.6 x 213.3)
5CTN04006PKALL	Sales display w/ stickers, no curtains	

Kason vinyl strips are extruded from quality polyvinyl chloride compounds to ensure excellent performance and long wear. The material is non-combustible and fire-resistant.

401 Standard Smooth

Light-stable vinyl compound, +10 to +120°F (-12 to +49°C)

Applications: Indoor/Outdoor

Advantages: Versatile material, does not discolor in sunlight

402 Low-Temp Smooth (USDA Approved)

Smooth vinyl compound, -40 to +70°F (-40 to +21°C)

Applications: Indoor Coolers/Freezers

Advantages: Meets Federal requirements for food service use.

403 Low-Temp Reinforced (USDA Approved)

Vinyl compound with extruded nylon cord, -40 to +70°F (-40 to +21°C)

Applications: Indoor Coolers/Freezers

Advantages: Nylon cord extruded within vinyl increases durability

404 Standard Ribbed

Ribbed vinyl compound, +10 to +120°F (-12 to +49°C)

Applications: Indoor/Outdoor

Advantages: Ribbing increases durability minimizing scratching and abrasion

405 Low-Temp Ribbed (USDA Approved)

Ribbed vinyl compound, -40 to +70°F (-40 to +21°C)

Applications: Indoor Coolers/Freezers

Advantages: Ribbing increases durability minimizing scratching and abrasion

406 Anti-Static

Clear, smooth, anti-static vinyl compound, +5 to +120°F (-15 to +49°C)

Applications: Clean rooms, electronics assembly areas, etc.

Advantages: Reduces static electricity from objects/persons by dissipating it back into the atmosphere

407 Weld Screen

Semi-transparent dark amber smooth vinyl, +5 to +120°F (-15 to +49°C)

Applications: Welding screens, partial sight barrier

Advantages: Low-maintenance economical sight protection

408 Opaque

Black vinyl, +5 to +120°F (-15 to +49°C)

Applications: Where complete sight barrier is required

Advantages: Allows easy access while blocking view

409 Safety Orange

Semi-transparent, bright orange smooth vinyl, -20 to +120°F (-29 to +49°C)

Applications: Identification of door opening edge

Advantages: Signals traffic hazard and helps meet OSHA requirements

410 X-Low Temp (USDA Approved)

Smooth vinyl, -80 to +60°F (-62 to +16°C)

Applications: Indoor freezers, blast freezers

Advantages: Meets Federal food service requirements for use in extra-low temperature applications.

411 Smooth Reinforced (USDA Approved)

Smooth vinyl with extruded nylon cord, +10 to +120°F (-12 to +49°C)

Applications: Indoor coolers

Advantages: Nylon cord extruded within vinyl increases durability

Bulk Roll Vinyl — contact 800.935.2766

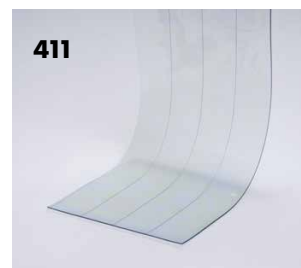
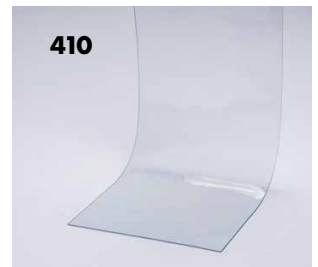
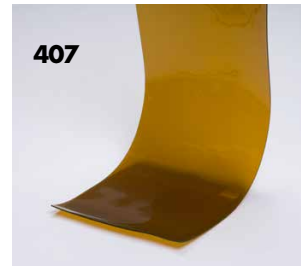
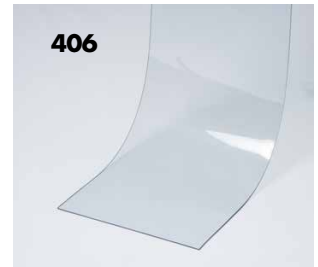
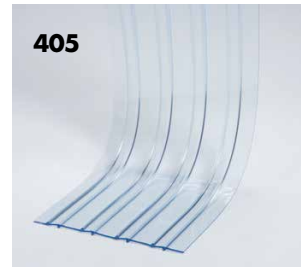
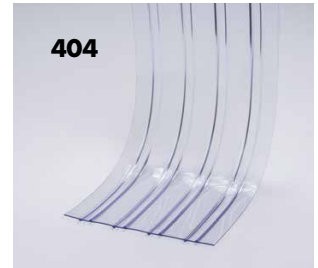
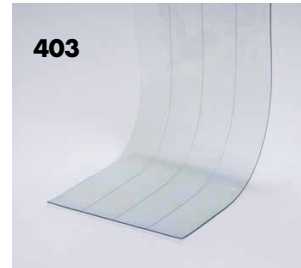
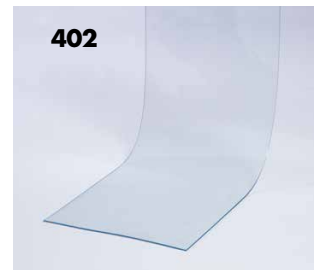

ORDERING GUIDE

Complete the following information for each door system and call **1.800.935.2766** to place your order.
See the front of the catalog for the fax numbers of the closest Kason locations.

VINYL STRIP CURTAIN SYSTEMS AND REPLACEMENT STRIPS

Which strip curtain system do you need?

- Easimount® (pg. C6)
 Easimount® II – Ceiling/Door Jamb Mount (pg. C7)
 (Includes notched channel with cover)
 Easimount® II – Side Wall Mount (pg. C7)
 Maximount® – Notched Channel w/ Cover (pg. C7)
 Maximount® – Standard mount w/o notch (pg. C7)
 Heavy Duty (pg. C7)
 Traditional Loop System (Not Shown)

Opening Width: _____ **Height:** _____
(nearest whole in/cm)

Vinyl Strip Curtain Material Type (see pg. C11): _____

Do you need Safety Orange strips: (Y/N): _____
(see pg. C11)

Vinyl Strip Gauge ___ 0.06" ___ 0.08" ___ 0.12"

Vinyl Strip width ___ 4" ___ 6" ___ 8" ___ 12"

Application: _____

Temperature range: _____

Number of replacement strips: _____

VINYL STRIP CURTAIN SYSTEM INFORMATION

Model	Model ID	Mounting Types	Types	Strip Sizes/ Widths
Easimount®	SA, LA	Flush Wall	401, 402, 403, 406, 407, 408, 409, 410, 411	
Easimount® II	SB, LB	Flush Wall, Overhead (SB), Side Wall/Jamb Mount (TB)	401, 402, 403, 406, 407, 408, 409, 410, 411	4", 6", 8", 12"
Maximount®	MM	Flush Wall, Overhead, Side Wall/Jamb Mount (specify JM)	All 400 Series (see pg. C9)	8", 12"
HD Universal	HD	Flush Wall, Overhead	All 400 Series (see pg. C9)	
Traditional Loop	SC	Flush Wall	All 400 Series (see pg. C9)	4", 6", 8"

Standard Overlap = 50% (all models). 33% and 66% overlap available in some sizes.

RETURNS AND CANCELLATION POLICY

Returns must be preauthorized by Kason. Approved returns are subject to restocking fee. Custom sizes/orders are nonreturnable and may not be canceled. Buyer assumes all responsibility in determining the suitability for application of the products of which they are purchasing.

VINYL SWING DOOR SYSTEMS

Which vinyl swing door system do you need:

- Single Panel – Top Mount Hinge (pg. C8)
 RIGHT/LEFT side door opening: _____
 Single Panel – Side Mount Hinge (pg. C8)
 RIGHT/LEFT side door opening: _____
 Double Panel – Top Mount Hinge (pg. C8)
 Double Panel – Side Mount Hinge (pg. C8)

(Right/Left door opening is determined from inside of unit/cooler. Single panel swing doors are typically installed on the same side as the exterior door's hinges.)

Opening Width _____ **Height** _____
(nearest whole in/cm)

Application: _____

Temperature range: _____

OPTIONAL MATERIALS

- Heavy Duty Door Mounting Kit (pg. C9)
(qty): _____
- Retro-Fit Thru-Bolt Kit (pg. C9)
(qty): _____
- Kick/Impact Plates (pg. C8)
(Y/N): _____
- Brace Plates (pg. C8)
(Y/N): _____