

DIRECTIONS

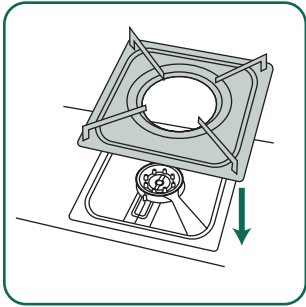

1. Install the trivets in the correct position. To open the trivets, pull it up smoothly from the gap.

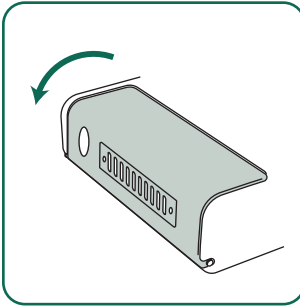

2. Open gas can cover.

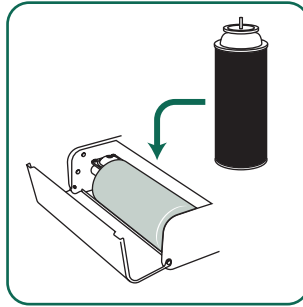

3. Put the gas can in the gas case. Make sure the size of the gas can is suitable for the stove.

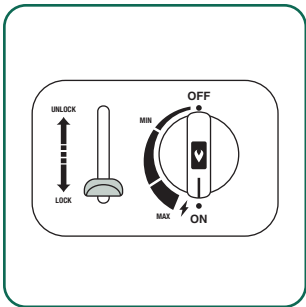

4. Push down the lock lever knob. Make sure the gas can has been fixed into the correct position.

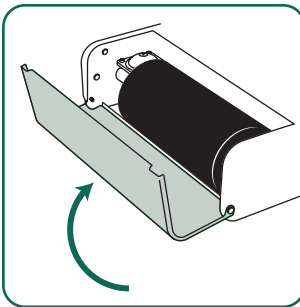

5. Close gas can cover.

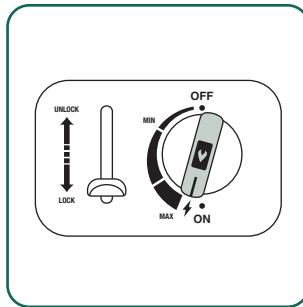

6. Ignite the burner by turning the ignition knob to the left. Turn until you hear a "click" sound. Be sure ignition knob is in the "off" position when turning the lock lever knob.

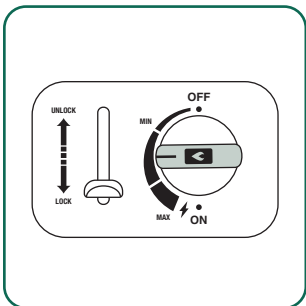

7. Place frying pan on burner and adjust the flame by turning the ignition knob. Turn the ignition knob from high to low to adjust the flame.

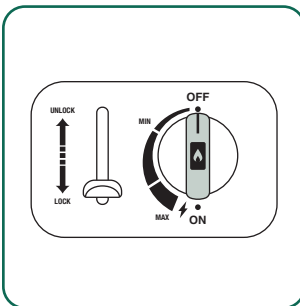

8. When finished cooking, turn off the burners. Turn the ignition knob to the "OFF" position.

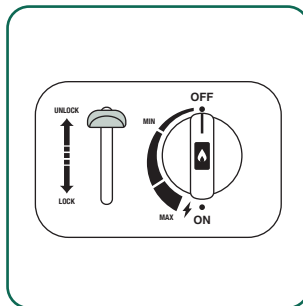

9. Pull up the lock lever knob. Make sure to pull the lock lever knob up to the "OFF" position when not in use.

CHOICE™

8,000 BTUs
per Burner

Butane Range

2 Burners (Brass or Aluminum)

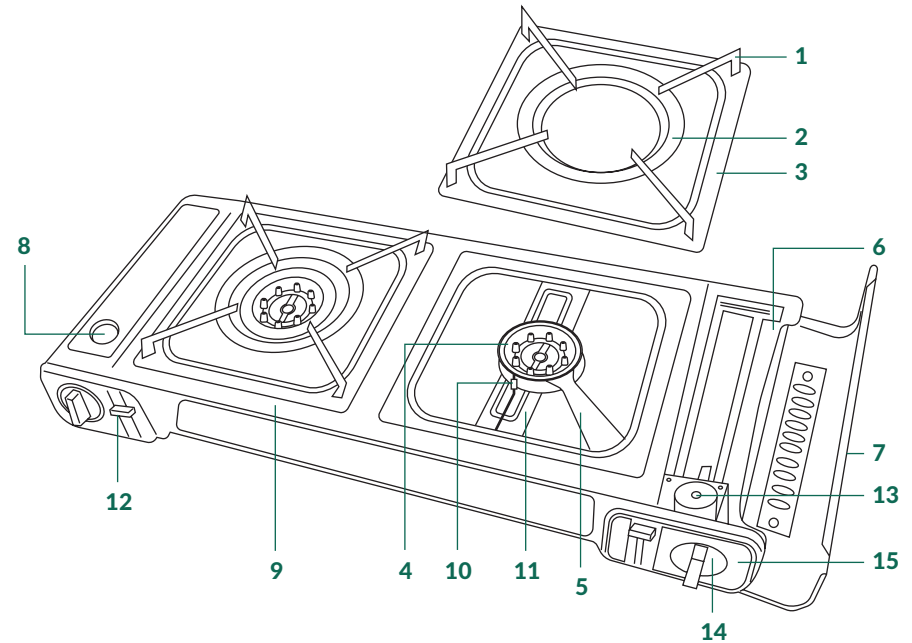

PARTS DESCRIPTION

1. TRIVET
2. WIND GUARD: Prevents flame from being extinguished by the wind. Saves gas by concentrating the flame.
3. BOTTOM PAN
4. FLAME SEPARATOR
5. GAS RING
6. GAS CAN REMOVABLE PANEL
7. GAS CAN COVER
8. COVER OPENING HOLE: Putting a finger into the hole and pulling it up will open the can cover.
9. HOUSING
10. ELECTRONIC LIGHTER: Ignites burner. Keep clean for smooth ignition.
11. PANEL FOR GAS RING
12. SWITCH COVER: Fixes the gas can when it is pushed down & releases the can when pulled up.
13. VALVE
14. IGNITION KNOB: For ignition of the burner. Turn this knob to the left until you hear the "click" sound. You can control the heat after ignition.
15. INSTRUCTION PANEL

READ ENTIRE MANUAL BEFORE OPERATING

READ ENTIRE MANUAL BEFORE OPERATING

IMPORTANT SAFEGUARDS

- Avoid strong wind. Otherwise, the flame may be scattered or extinguished.
 - Avoid direct exposure to sunlight. Avoid operating near flammable items. Keep unit 6" or more away from walls.
 - Place the trivet in the correct position. Otherwise, the ignition knob will not function.
 - If you smell gas, turn off and take outside where the leak may be detected. You can check for leaks with soapy water.
1. **After gas can is empty...**
Do not throw used gas cans into fire. A hole must be drilled into used cans before being thrown away.
 2. **Do not let food overheat...**
Do not let liquids overflow into the burner. If this happens, turn off and wipe with a dry towel.
 3. **Only for cooking...**
Do not use gas stove for any other reason.
 4. **In case of accident...**
Switch off the ignition knob and unlock the gas can.
 5. **Do not let range overheat...**
Do not put two ranges beside each other. Do not put too large of a pan on the range.
 6. **Do not let gas leak...**
Be sure the gas can fits in the gas can case correctly. If you hear a hissing sound while installing the can, take can out and reinstall. Do not ignite the appliance when the gas can is not in the correct position.



TECHNICAL DATA

BUTANE RANGE	
Size	25" x 10 1/2" x 3 1/4"
Weight	7 1/4 lb.
Fuel	Butane Gas
Total BTU	16,000

The design and standard may be changed for the improvement of quality without notice.

READ ENTIRE MANUAL BEFORE OPERATING

READ ENTIRE MANUAL BEFORE OPERATING