

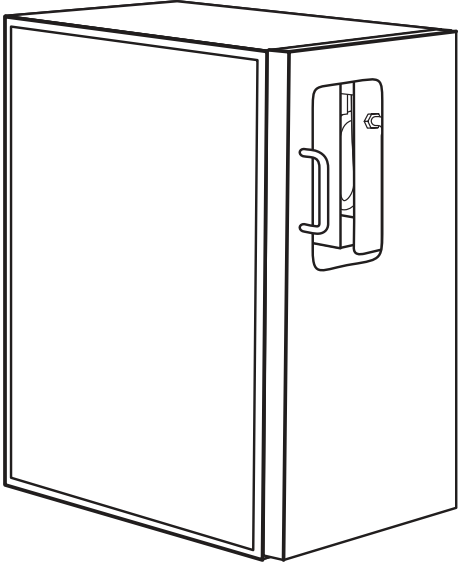

COT2000 SERIES
PrimePour™
Operation Manual

READ BEFORE USE.

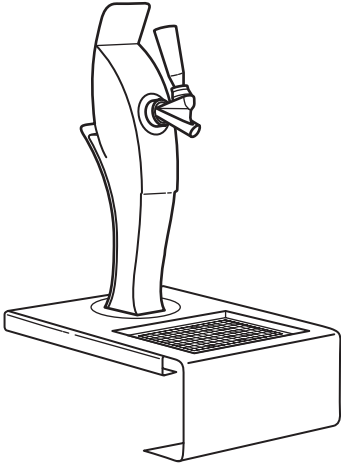

840247001
7/14

For more Good Thinking® visit www.commercial.hamiltonbeach.com

IMPORTANT SAFETY INSTRUCTIONS

WARNING – When using appliances, basic safety precautions should be followed, including the following:

1. Read the Operation Manual before using. Keep Operation Manual handy.
2. Do not use for other than intended use.
3. Not intended for use by or near children.
4. Children should be supervised to ensure that they do not play with this equipment.
5. This equipment is not intended for use by persons (including children) with reduced physical, sensory, or mental capabilities, or lack of experience and knowledge, unless they have been given supervision or instruction concerning use of the appliance by a person responsible for their safety.
6. The use of accessory attachments not recommended by Hamilton Beach Commercial may cause injuries.
7. Do not operate the device after it malfunctions, or is dropped or damaged in any manner. Call the Technical Services number, (844) 657-1544, for instructions on examination, repair, or adjustment.
8. **CO₂ (Carbon Dioxide) Warning!** CO₂ displaces oxygen. Strict attention must be observed in the prevention of CO₂ gas leaks in the entire CO₂ system. If a CO₂ gas leak is suspected, particularly in a small area, *immediately* ventilate the contaminated area before attempting to repair the leak. Personnel exposed to a high concentration of CO₂ gas will experience tremors which are followed rapidly by loss of consciousness and suffocation.

– SAVE THESE INSTRUCTIONS –

Technical Services

For assistance or replacement parts, call our
Technical Services number:
844-657-1544 or ++910-693-4277

8 a.m. – 5 p.m. EST Monday – Friday
www.commercial.hamiltonbeach.com

Parts and Features

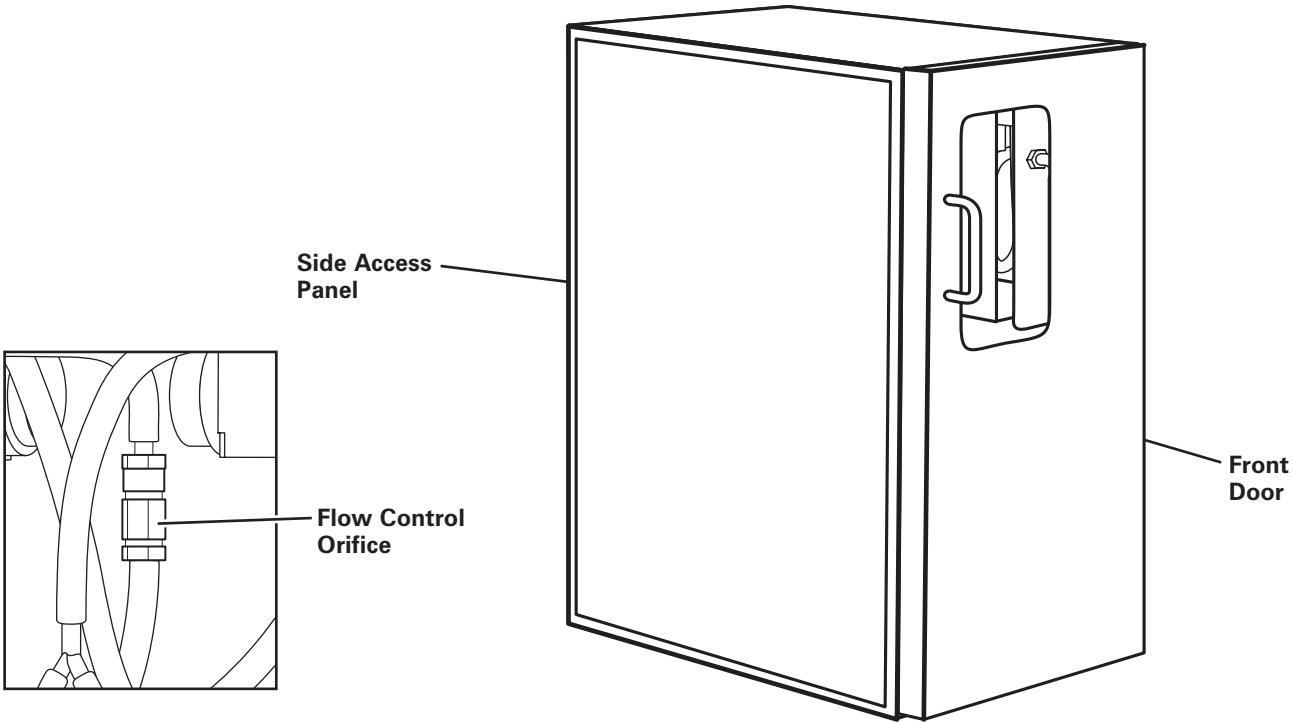
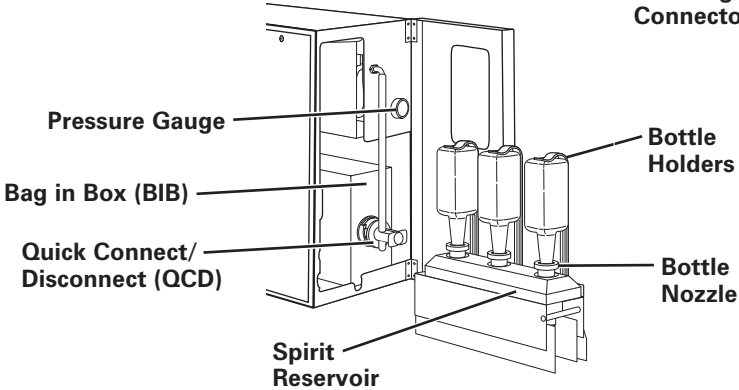
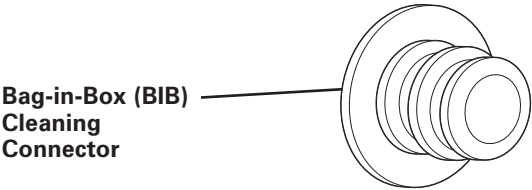
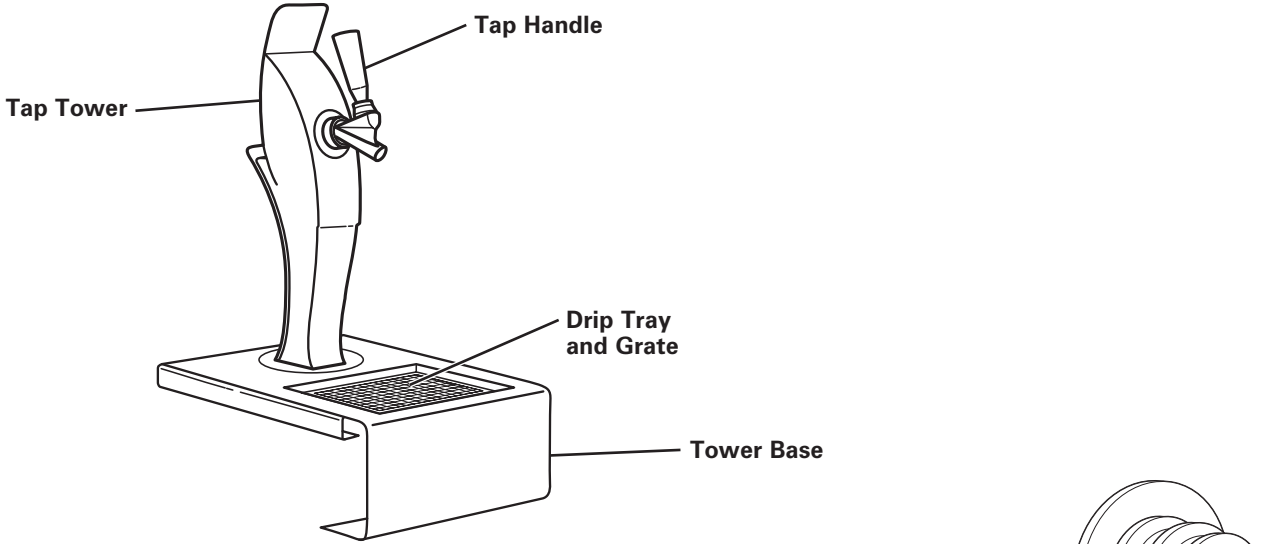

Operating Instructions

1. The machine is calibrated to dispense at a ratio of 3 parts drink mix to one part spirits. If you are serving a 12-ounce drink, fill the glass with 6 ounces of ice and dispense about 6 ounces until the glass is full.

2. The machine holds three bottles of spirits and a 3-gallon bag of drink mix. It is recommended the levels of each be checked before service each day. The spirits reservoir is designed so that the bottle in the rear of the unit will empty first and the bottle in the front will empty last. If the spirits reservoir runs empty, air will enter the unit and cause spitting and coughing at the tap.

To replace a bottle of spirits, remove the empty bottle, remove the cap to the new bottle, and slide the bottle nozzle over the bottle. Fold the tip of the bottle nozzle over, and insert the nozzle into the spirits reservoir, tilting the bottle upside down. Lower the bottle holder and secure by tightening the thumbscrew. The bottle holders need to be centered on the bottoms of the bottles. Slide the drawer into the cabinet after the spirits bottles are installed. If the bottle holders hit the cabinet when sliding the drawer inside, then adjust the position of the holders on the bottoms of the bottles.

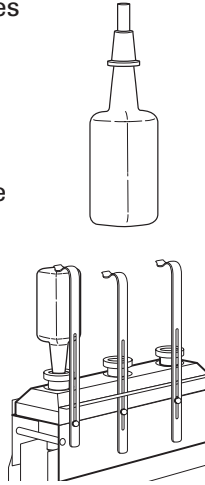

3. To replace the bag in box (BIB), pull out firmly on the plunger, and slide the quick connect/disconnect (QCD) to the side. Discard the empty BIB.

Install the bag in box (BIB) by opening the end of the box and pulling out the fitting. A cap is installed over the fitting; pull to remove. Slide the fitting into the slot of the cardboard box. Slide the box into the unit.

Fully pull out the plunger on the quick connect/disconnect (QCD). Attach the QCD by sliding it over the fitting. Firmly push in on the plunger to engage the fitting, and slide the BIB into the cabinet as far as it will go.

If the BIB runs empty, the pumps will turn off. When a new BIB is installed, the pumps will start automatically when the faucet is opened.

4. Refer to the Troubleshooting Guide if additional help is needed.
5. Follow the steps outlined in Maintenance to keep your machine in top shape.

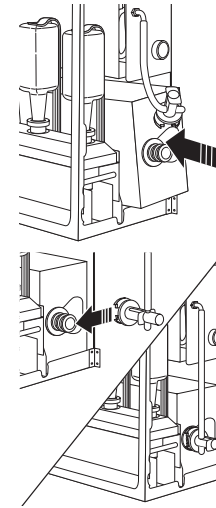

Installation

Site Preparation

The installation requires a CO₂ supply hose to be within reach of the base cabinet, and it must be long enough such that the cabinet can be pulled out for installation, cleaning, and maintenance. The supply line pressure must be regulated so that it delivers between 50 and 60 psi. The supply line can be attached to the unit through a standard 1/4-inch female quick coupler, or the hose can be attached to a 1/4-inch barbed fitting and secured with a hose clamp.

The tap tower and base unit is designed to clamp-mount to a flat table or countertop. The countertop thickness cannot exceed 3.75 inches. The unit includes 8 feet of hose to run from the faucet to the base cabinet. The base cabinet needs to be located so that it is within reach of the hose, allowing the cabinet to be pulled out for installation, cleaning, and maintenance.

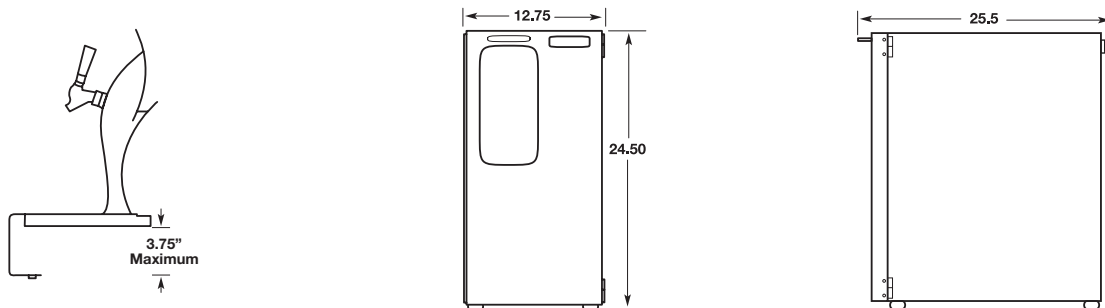

Installation

1. Remove the equipment from the cabinet, which includes the tap tower, tower base, drip tray and grate, spirit bottle holders (quantity 3), and a bag of hardware.

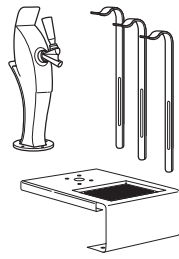

2. Install the thumbscrews to the tower base. Snap the pads to each end of the thumbscrews.

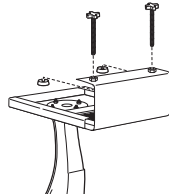

3. Install the tap tower to the tower base by threading the drink hose through the access hole and bolting the large washer to the underside of the base and tower with #8 screws, nuts, and lock washers (quantity 4 each).

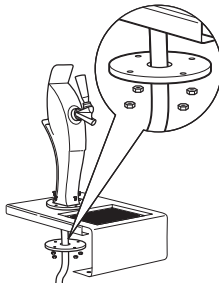

4. Route the hose along the edge of the tower base, which requires threading the hose past the lateral support on the underside of the tower base.

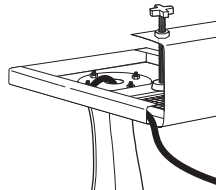

5. Using the thumbscrews, clamp the tap tower and base to the table or countertop, verifying the hose is not pinched.

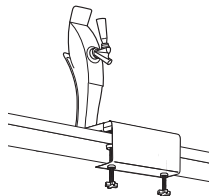

6. Install the drip tray and grate.

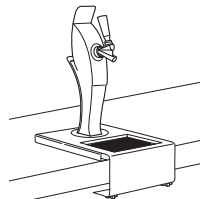

7. Close the tap faucet by pushing the handle away from you.

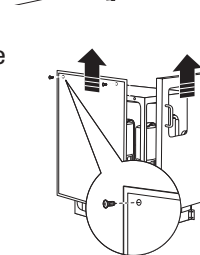

8. On the base cabinet, remove the side access panel by removing two screws and lifting up and off. Remove the front door by lifting up and off.

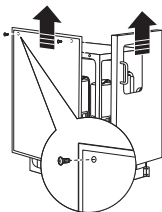

9. Pull the spirits reservoir drawer out by cutting the cable tie securing it to the cabinet. Remove the pump cover by removing four red thumbscrews.

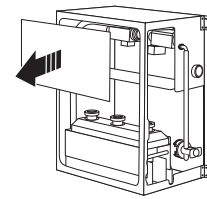

10. Connect the drink hose from the tap tower to the base cabinet and secure with a hose clamp.

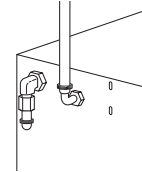

11. For servicing and maintenance, the CO₂ should be able to be turned off to the cabinet. When running a CO₂ line to the cabinet, include a shutoff valve.

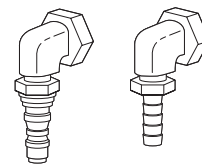

The unit comes assembled with a 1/4-inch male quick coupler. The CO₂ supply line can use the matching female coupler (such as McMaster-Carr part #6536K38), or the male quick coupler can be replaced with a 1/4-inch barbed fitting, included in the bag of hardware, and the supply line is attached with a hose clamp.

Do not hook up the CO₂ supply line until instructed in the Sanitizing section.

12. Sanitize the unit as described in Sanitizing on page 6.

13. Check for leaks in the hoses and fittings and tighten where needed. Verify hoses are not pinched inside the cabinet. Verify the supply line CO₂ pressure to the cabinet is between 50 and 60 psi. Adjust the unit regulator to 30 psi by pulling out the knob and rotating until the needle indicates 30 psi. Push the regulator knob in until it "clicks" to prevent tampering, and install the pump cover.

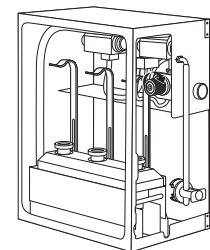

14. Install the bottle holders to the spirits reservoir with thumbscrews, and tighten with the bottle holders in the tallest position.

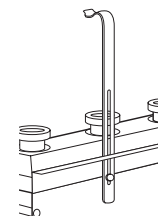

15. Remove the cap to the spirit bottle and slide a bottle nozzle over the bottle.



Installation (cont.)

16. Fold the tip of the bottle nozzle over, and insert the nozzle into the spirits reservoir, tilting the bottle upside down. Lower the bottle holder and secure by tightening the thumbscrew. Slide the drawer into the cabinet after the spirits bottles are installed. The bottle holders need to be centered on the bottoms of the bottles. If the bottle holders hit the cabinet when sliding the drawer inside, then adjust the position of the holders on the bottoms of the bottles.

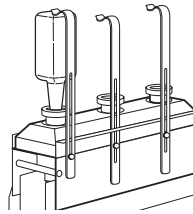

17. Install the bag in box (BIB) by opening the end of the box and pulling out the fitting. A cap is installed over the fitting; pull to remove. Slide the fitting into the slot of the cardboard box. Slide the box into the unit.

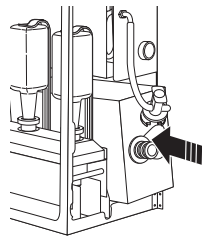

18. Fully pull out the plunger on the quick connect/disconnect (QCD). Attach the QCD by sliding it over the fitting. Firmly push in on the plunger to engage the fitting, and slide the BIB into the cabinet as far as it will go.

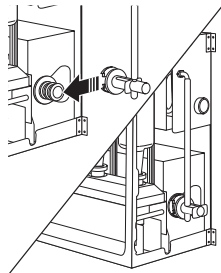

19. On the control panel, verify the spirits valve is rotated to **DISPENSE**.
20. There may be sanitizer or water in the hoses if it was just sanitized. Dispense about 12 ounces (355 ml) or until air is no longer trapped in the lines.

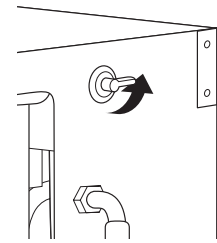

21. Check fittings and hoses for signs of pinching and leaking. Adjust and tighten where needed. Check the pressure gauge again to confirm it indicates 30 psi.

22. Install the side access panel and front door.

23. Push the cabinet into position, verifying the hoses do not get pinched.

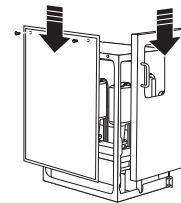

24. Open and close the front door to verify it travels freely.

25. Pull and push in the spirits reservoir drawer to verify it travels freely.

26. Sample a drink to ensure the integrity of the product. The unit is calibrated at the factory to dispense at a ratio of 3 parts drink mix to 1 part spirits.

Sanitizing

1. Prepare the sanitizing solution by mixing 1.24 ounces (1.5 teaspoons or 7.5 ml) 5% liquid chlorine (liquid bleach—unscented, nondetergent, non-drip-free, fresh new product) in one gallon of water, resulting in a 100 ppm concentration.

2. Remove the cover to the spirits reservoir by loosening and removing the six screws. Remove the bottle nozzles. If the reservoir cover has plugs in each of the holes, remove and discard the blue plugs. Immerse the bottle nozzles in the sanitizing solution. With a soft brush, brush the inside and outside of the cover with sanitizing solution, and rinse with clear water. Remove the bottle nozzles from the sanitizing solution and rinse with clear water.

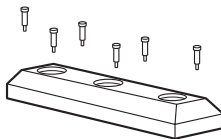

3. Fill the spirits reservoir with about 25 oz. (739 ml) of sanitizing solution. Using a soft brush, brush the top portion of the inside of the spirits reservoir.

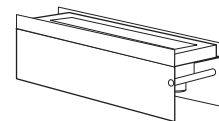

4. Attach the bag-in-box (BIB) cleaning connector to the quick connect/disconnect (QCD) by sliding it into position and depressing the plunger. Immerse the QCD in a bucket of sanitizing solution.

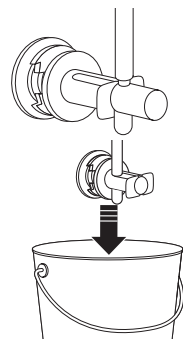
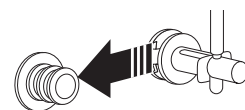

Sanitizing (cont.)

5. On the control panel, verify the spirits valve is rotated to **DISPENSE**.
6. Verify the CO₂ supply line pressure is between 50 and 60 psi. Connect the air hose to the cabinet.

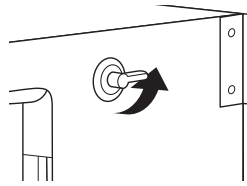

7. Pump the sanitizing solution through the system by opening the tap handle. When sanitizer is flowing freely at the tap, close the tap and allow the solution to work for 5 minutes.
8. Flush with clean water and pump until the spirits reservoir is empty.
9. Install the cover to the spirits reservoir.

Troubleshooting Guide

Problem . . .	Solution . . .
Nothing comes out when the tap faucet is opened.	<ul style="list-style-type: none"> • Empty drink mix bag in box. The pumps will shut off when the drink mix bag in box is empty. Connect a new bag in box. Be sure to fully engage the plunger on the quick connect/disconnect (QCD). • Low CO₂ pressure. Open the cabinet door and identify the CO₂ pressure from the gauge. The unit is designed to operate at 30 psi, and the pressure gauge was set to 30 psi at the time of the installation. If the pressure gauge is reading less than 30 psi, the CO₂ tank is likely low or empty. Check the pressure at the CO₂ tank. Replace or recharge if needed. The CO₂ supply line leading to the cabinet should be between 50 and 60 psi.
The flow is very slow when the tap faucet is opened.	<ul style="list-style-type: none"> • The drink mix bag in box is almost empty. The pumps will shut off when the drink mix bag in box is empty. Connect a new bag in box. Be sure to fully engage the plunger on the quick connect/disconnect (QCD). • Low gas pressure. Open the cabinet door and identify the CO₂ pressure from the gauge. The unit is designed to operate at 30 psi, and the pressure gauge was set to 30 psi at the time of the installation. If the pressure gauge is reading less than 30 psi, the CO₂ tank is likely low or empty. Check the pressure at the CO₂ tank. Replace or recharge if needed. The CO₂ supply line leading to the cabinet should be between 50 and 60 psi. • The quick connect/disconnect (QCD) to the drink mix bag in box is not tight. Reconnect the QCD to the bag in box. The plunger must be fully depressed. • Pinched hose. Check for a pinched hose between the cabinet and tap tower.
The flow is sputtering when the tap faucet is opened.	<ul style="list-style-type: none"> • Low spirits level. Air in the lines will cause coughing and sputtering at the tap. Check that there are spirits in the reservoir. • The drink mix bag in box is almost empty. Check that there is drink mix remaining in the box. Connect a new box if needed. • The quick connect/disconnect (QCD) to the drink mix bag in box is not tight. Reconnect the QCD to the bag in box. The plunger must be fully depressed.
The flow is only drink mix when the tap faucet is opened; no spirits are dispensed.	<ul style="list-style-type: none"> • The spirits shutoff valve is turned OFF. Open the cabinet door and rotate the handle to DISPENSE. • The filter in the spirits reservoir is clogged. Clean filter. (The mesh filter is located in the bottom of the spirits reservoir.) • The flow control orifice is clogged. Remove and clean the flow control orifice. The flow control orifice is located between the pumps and secured to the side wall of the cabinet. <div style="text-align: right;"> </div>
The flow is only spirits when the tap faucet is opened; no drink mix is dispensed.	<ul style="list-style-type: none"> • The drink mix BIB is almost empty. Connect a new bag in box. • The quick connect/disconnect (QCD) to the drink mix BIB is not tight. Reconnect the QCD to the bag in box. The plunger must be fully depressed.

Troubleshooting Guide (cont.)

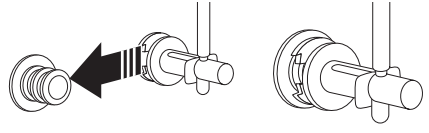
Problem . . .	Solution . . .
The pumps fail to stop cycling even when the tap faucet is closed.	<ul style="list-style-type: none"> • There is a leak in the hoses. Check for leaks inside the cabinet and the hose running from the cabinet to the tap. • Faulty pump or pump auto shutoff. Turn off the CO₂ to the unit and call for service.
The quick connect/disconnect (QCD) does not attach to the bag in box (BIB).	<ul style="list-style-type: none"> • The QCD is not fully retracted. Pull the plunger out as far as it will go. Slide the QCD over the BIB fitting. Fully depress the plunger. 

Maintenance

It is essential that the entire liquid system is sanitized after extended shutdown periods. Purge all products from the system, rinse with clear water, and then follow the steps identified in **Sanitizing**.

Daily	<ol style="list-style-type: none"> 1. Clean faucet. Wash your hands with soap and water, and prepare a chlorine-based sanitizer solution. Clean the inside of the faucet with a brush and sanitizer solution. 2. Clean the drip tray. Pour chlorine-based sanitizer solution over the tray. Remove grate. Wipe down inside/outside of the drip pan with a clean cloth towel and chlorine-based sanitizer solution. 3. Wipe down tap tower and base.
Weekly	<ol style="list-style-type: none"> 1. Clean BIB connector. Wash your hands with soap and water, and prepare a sanitizer solution. Disconnect drink mix line from BIB. Soak connector in a dedicated bucket of sanitizer solution for 1 minute.
Monthly	<ol style="list-style-type: none"> 1. Remove the front door by lifting it up and off, and wipe down the door. 2. Disconnect and remove the drink mix BIB, and wipe down the bottom of the cabinet. 3. Pull the cabinet out as needed, using the handhold, to clean behind and underneath the unit. Verify the hose to the tap tower does not get pinched when returning the unit to its home position. 4. Attach the bag-in-box (BIB) cleaning connector to the quick connect/disconnect (QCD), and immerse the QCD in a bucket of sanitizing solution [1.5 teaspoons or 7.5 ml of 5% liquid chlorine (liquid bleach—unscented, nondetergent, non-drip-free, fresh new product) in one gallon of water]. 5. Rotate the spirits shutoff valve to CLEAN. 6. Open the tap and let the sanitizer circulate through the hoses. When the fluid is running clear, turn off the tap. Allow the solution to work for 5 minutes, and then flush with clean water. 7. Reconnect the drink mix BIB. 8. Dispense about 12 ounces (355 ml) or until drink mix flows continuously from the faucet. 9. Rotate the spirits shutoff valve to DISPENSE. 10. Dispense about 3 ounces (89 ml) or until air is no longer trapped in the lines. 11. Sample a drink to ensure the integrity of the product. 12. Check fittings and hoses for signs of leakage and tighten where needed. 13. Install front door.



4421 Waterfront Drive
Glen Allen, VA 23060

www.commercial.hamiltonbeach.com

840247001
7/14