

**STEP 7**

Position Pedestal onto Base Shelf and secure with (4) 1/4" x 20 1/2" Truss Head Screws and Nuts provided.  
(See Illustration 5 & 5A)



Illustration 5



Illustration 5A

**STEP 8**

Install faucet, drain and drain to sink body.

**STEP 9**

Position Hand sink Body onto Pedestal and secure with (4) 1/4" x 1/2" Truss Head Screws and Nuts provided.  
(See Illustrations 6 & 6A)

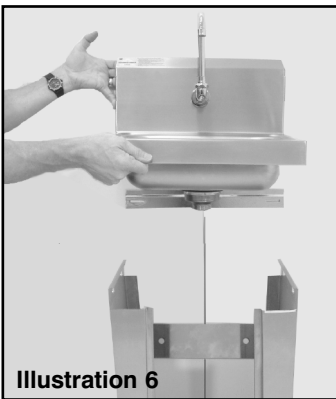

Illustration 6



Illustration 6A

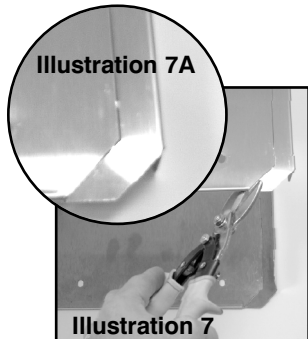

Illustration 7A

**STEP 10**

If required, Remove "Break-Away" tabs at bottom of sides using metal shears to accommodate floor moulding.  
(See Illustrations 7 & 7A)

**STEP 11**

Secure rear brace to wall.  
(See illustration 8)

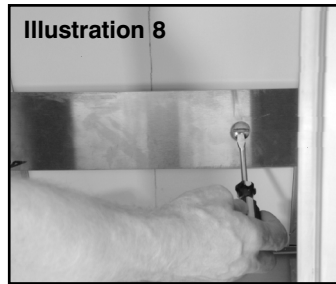

Illustration 8

**STEP 12**

Connect drain and supply line from Foot Valve to Faucet.

**STEP 13**

Remove aerator and flush water system.

**STEP 14**

Adjust cold water at front of Foot Valve.  
(See Illustration 9)

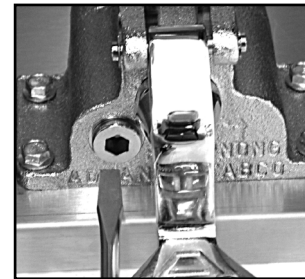

Illustration 9

**STEP 15**

Check all water and drain connections for leaks.

**STEP 16**

Install Front panel to Pedestal. (See Illustrations 10 & 10A)



Illustration 10



Illustration 10A

© ADVANCE TABCO, MAY 2012



**INSTALLATION INSTRUCTIONS  
for  
PEDESTAL HAND SINKS**



**CHECK FOR CONCEALED DAMAGE  
FILE CLAIM WITH DELIVERING FREIGHT CARRIER**

Sinks manufactured by **ADVANCE TABCO®** are designed and constructed for the use of liquid containment. Suggested applications include Food Preparation, Manufacturing, Cooking, Laboratory and Service and the like. **ADVANCE TABCO®** does not recommend product use for activities employing harsh and active chemicals. Please consult factory regarding unusual applications.

**CONTENTS INCLUDE:**

- (1) Hand Sink with Pedestal
- (1) Foot Valve
- (1) Floor Template
- (4) 1/4 - 20 x 3/4" Hex Head Bolts
- (8) 1/4 - 20 x 1/2" Truss Head Screws
- (8) 1/4 - 20 Hex Nuts
- (1) K-121 Faucet
- (1) K-6 Basket Drain
- (1) Wall Clip

**TOOLS REQUIRED:**

- Tape Measure
- Flat Head Screw Driver
- 7/16" Open End Wrench
- 3/8" Open End Wrench
- Adjustable Wrench
- Drill Motor & Bits
- 48" Level
- Adhesive Tape
- Safety Glasses

**INSTRUCTIONS:****STEP 1**

Position Floor Template at desired location. Tape in place and drill holes as required for mounting hardware (Not Included). (See Illustration 1)

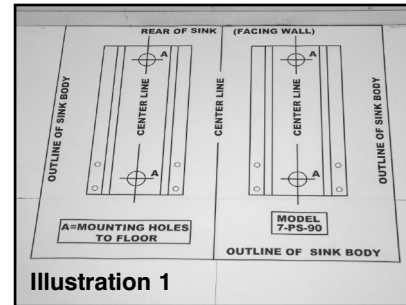
**Illustration 1****STEP 2**

Mark a "plumb" line from the centerline of the Floor Template extending approximately 48" A.F.F. (Above Finished Floor). Center Wall Clip on plumb line at a point 41-1/2" A.F.F. level and secure Wall Clip (Hardware not Included). (See Illustration 2)

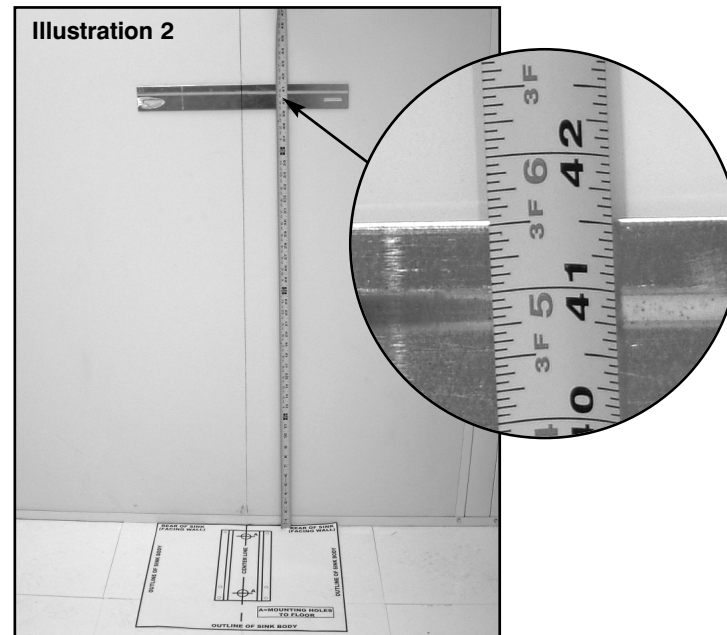
**Illustration 2****STEP 3**

Disassemble Pedestal Base - unbolt sink body from Pedestal. Remove Front Door Panel and disconnect Foot Valve & Base Shelf.

**STEP 4**

Install Base Shelf to Floor. (See Illustration 3)

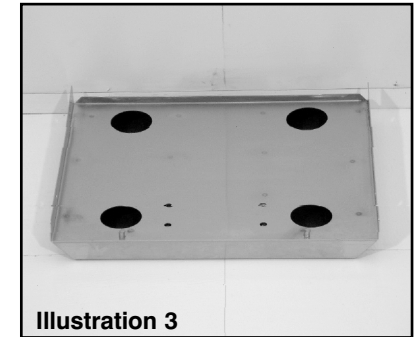
**Illustration 3****STEP 5**

Position and Secure Foot Valve to Base Shelf with (4) 1/4 - 20 x 3/4" Hex Head Bolts provided. (See Illustration 4)

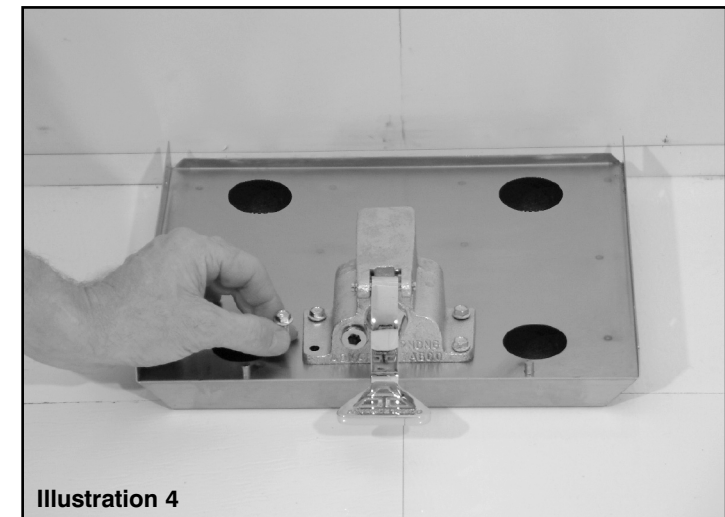
**Illustration 4****STEP 6**

Pre plumb hot and cold water supply to foot valve in accordance with local plumbing codes.